

21501280020

I, William C. Jung, do hereby certify that on the 7th day of April, 1983, I found (evidence) ~~(no evidence)~~ of the South 1/4 corner of Section 28, T 15 N, R 1 W Fourth Principal Meridian, and I re-established said corner according to the Wisconsin Statutes as shown and described hereon.

History of corner establishment since Original Government Survey

Fred Holden found the original government corner in May of 1906. He struck a new bearing tree, a 3" hickory, S65 3/4°E, 12.7' (to center of tree) from the corner.

Description of corner evidence found:

I found what I believe to be Holden's old bearing tree. I set the corner by using this tree. This location is supported by my section measurements. The corner is almost on line with the existing monuments at the C1/4 and N1/4 of Section 28. It is also almost on line between the SW and SE corners of Section 28. The corner is South of the old road and North of the new road.

Dated this 21st day of Feb 1983.

William C. Jung

Deputy County Surveyor, R.L.S. 1323

COUNTY SURVEYOR FORM NO. 1

Description of corner and witness monuments, references and accessories used to perpetuate the original or re-established location of this corner:

(All bearings are hand compass bearings.)

Witnesses to corner location:

William C. Jung

Dallas Wilhite

Set a Harrison marker and mounded stones around it. The corner is 12.7' from the center of Holden's tree.

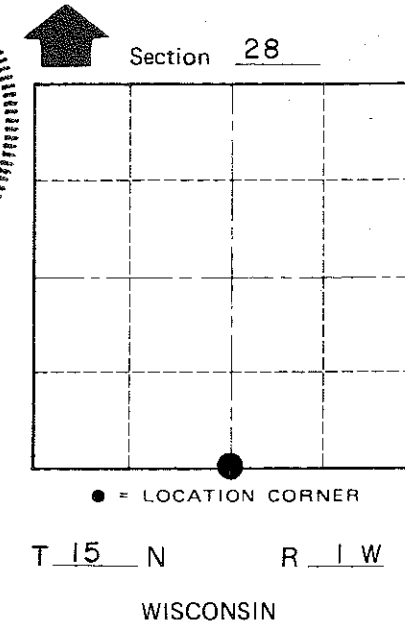
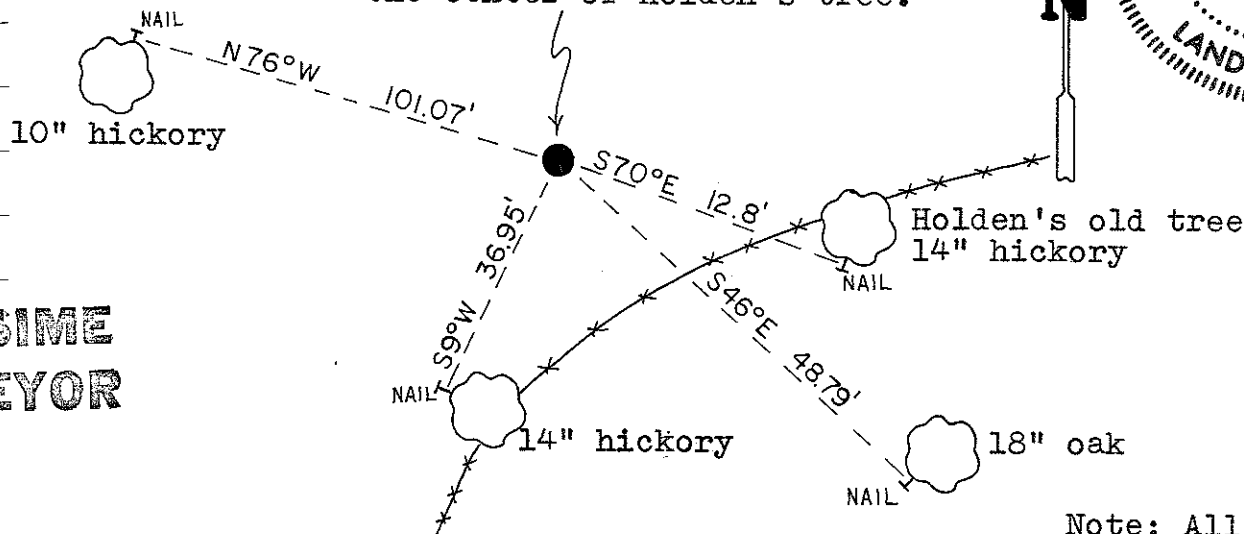

Approved: **HARLEY A. SIME**
MONROE CO. SURVEYOR

SURVEY CONTROL ORDER

Horizontal _____
Vertical _____

WISCONSIN COORDINATE SYSTEM

Corner	East (X)	North (Y)	Elevation (Z)	Zone
Control Sta. Name				

Note: All bearing trees are double blazed. Each distance is to a nail in a hack on the side of the tree.

City, Village or Town of Wellington
County of Monroe
Wisconsin