

21501222000

CERTIFIED LAND CORNER

I do hereby certify that on the 3rd day of March, 2005, I found (evidence) (no evidence) of the ~~E4~~ corner of Section 22, T 15 N, R 1 W, Fourth Principal Meridian, and I re-established said corner according to the Wisconsin Statutes as shown and described hereon.

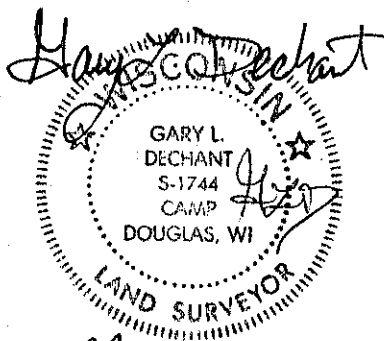

SECTION 22

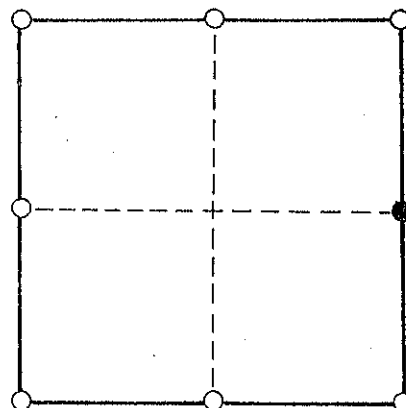

● = CORNER LOCATION

T 15 N R 1 W

TOWN OF: WELLINGTON

Witnesses to corner location:

March 8, 2005

Zachariah P. Dechant

Gary L. Dechant

HISTORY OF CORNER:

A.B. Holden was here in 1887. Hamilton LaRue was here in 1900. Fred Holden was here in 1905 and again in 1910.

DESCRIPTION OF CORNER EVIDENCE FOUND:

Accepted fence corner as best available evidence. Does not fit Fred Holden's protraction along the east line of the section, but based on occupied forty corners and CA in Section 23, the occupied fence corner at E4 Sec 22 fits very well. The bulk of field evidence in Section 22 and 23 support this location.

DESCRIPTION OF CORNER AND WITNESS MARKERS:

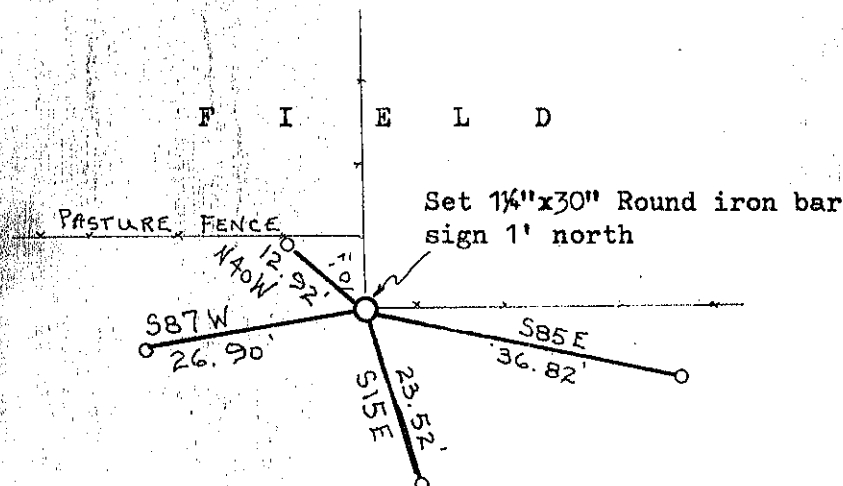

○ = Set 1"ODx24" Iron Pipe

P A S T U R E