

21501220020

I, William C. Jung, do hereby certify that on the 27th day of September 1982, I found (evidence) ~~no evidence~~ of the South 1/4 corner of Section 22, T 15 N, R 1 W Fourth Principal Meridian, and I re-established said corner according to the Wisconsin Statutes as shown and described hereon.

Dated this 28th day of Jan. 1983.

William C. Jung

Deputy County Surveyor

Title

History of corner establishment since Original Government Survey

(Nov., 1905)

A.S. Ingalls was at this corner in March of 1873. Holden shows that this corner was re-established in 1902 and also shows a 2" iron at the corner. In his notes of December, 1901, Holden shows a 2" bar at the corner. Duane Marten found and used this iron while doing a survey in August of 1972.

Description of corner evidence found:

I found the old 2" iron, removed it and replaced it with a Harrison marker.

COUNTY SURVEYOR FORM NO. 1

Description of corner and witness monuments, references and accessories used to perpetuate the original or re-established location of this corner:

Witnesses to corner location:

William Jung
Melvin Pliner

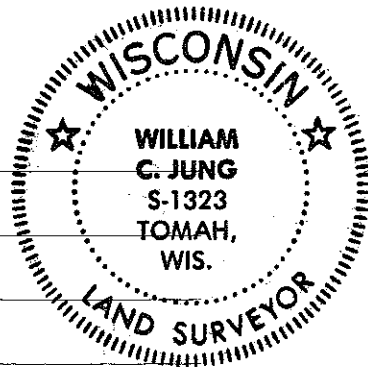

Approved: **HARLEY A. SIME**
MONROE CO. SURVEYOR

SURVEY CONTROL ORDER

Horizontal	_____
Vertical	_____

Corner	East (X)	North (Y)	Elevation (Z)	Zone
Control Sta. Name				

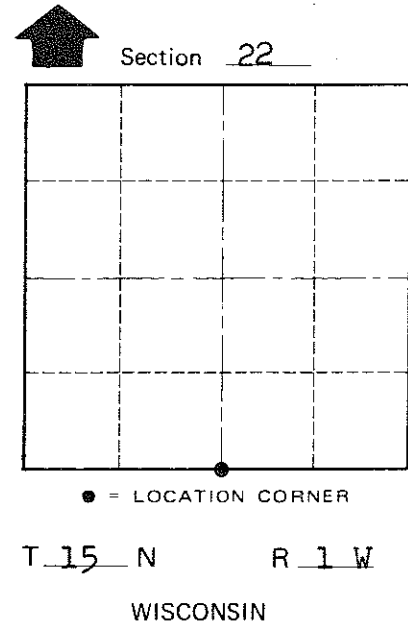
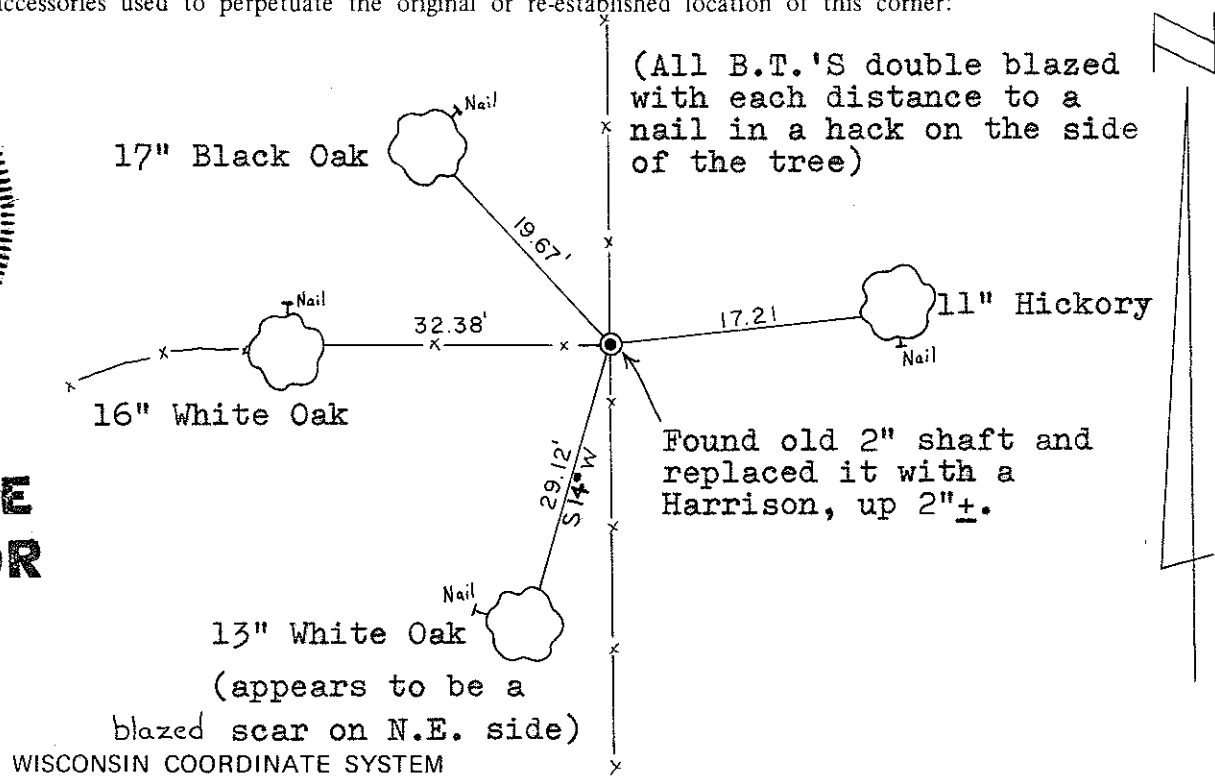

~~City, Village or~~ Town of Wellington
County of Monroe