

21501212000

I, William C. Jung, do hereby certify that on the 17th day of September 1982, I found (evidence) ~~no evidence~~ of the West 1/4 corner of Section 22, T 15 N, R 1 W Fourth Principal Meridian, and I re-established said corner according to the Wisconsin Statutes as shown and described hereon.

History of corner establishment since Original Government Survey

A.S. Ingalls was at this corner in March of 1873. Holden found the original corner in November of 1905 and set an iron shim.

Description of corner evidence found:

I found Holden's iron shim, removed it, and replaced it with a Harrison marker.

Dated this 25th day of Jan. 1983.

William C. Jung

Deputy County Surveyor

Title

COUNTY SURVEYOR FORM NO. 1

Description of corner and witness monuments, references and accessories used to perpetuate the original or re-established location of this corner:

Witnesses to corner location:

William C. Jung

Bryan H. Meyer

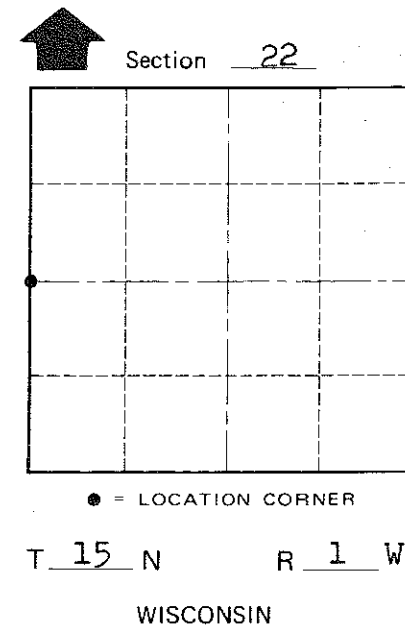
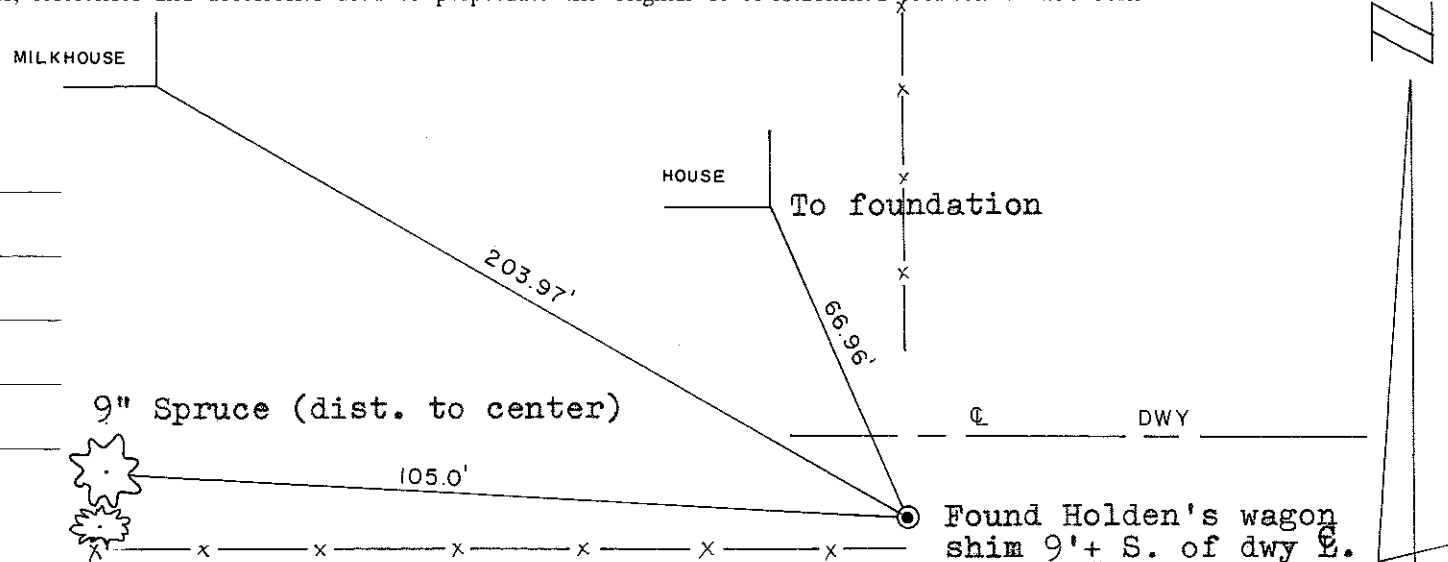
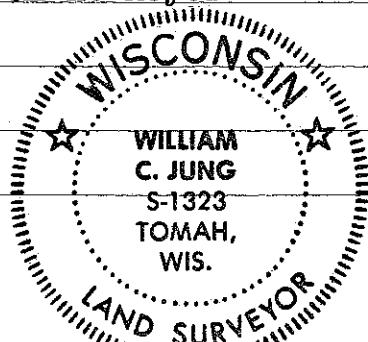

Found Holden's wagon shim 9'+ S. of dwy Q. Replaced shim with Harrison monument, set flush, 2' North of fence.

Approved: **HARLEY A. SIME**  
**MONROE CO. SURVEYOR**

SURVEY CONTROL ORDER

Horizontal \_\_\_\_\_  
Vertical \_\_\_\_\_

WISCONSIN COORDINATE SYSTEM

Corner	East (X)	North (Y)	Elevation (Z)	Zone
Control Sta. Name				

~~City, Village or~~ Town of Wellington  
County of Monroe