

**21501190020**

I, Gary L. Dechant, do hereby certify that on the 16th day of November 19 98, I found (evidence) (~~no evidence~~) of the N¼ corner of Section 30, T 15 N, R 1 W Fourth Principal Meridian, and I re-established said corner according to the Wisconsin Statutes as shown and described hereon.

Dated this 1st day of Dec. 19 98.

Gary L. Dechant

R.L.S. 1744  
Title

History of corner establishment since Original Government Survey

No known recorded history since the original government survey.

Description of corner evidence found:

Accepted fence corner as best available evidence.

The north line of the section measures considerably short of the original gov't. survey but the occupied corner fits other corners within the section reasonably well.

Description of corner and witness monuments, references and accessories used to perpetuate the original or re-established location of this corner:

Witnesses to corner location:

David E. Madison

Gary L. Dechant

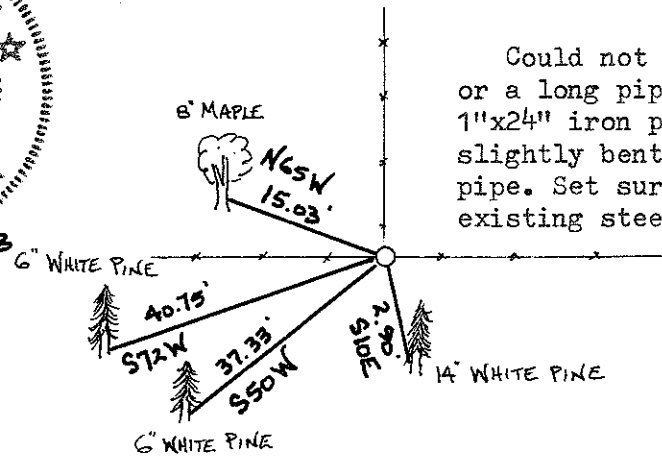
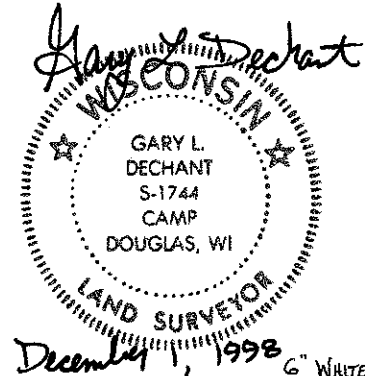

Could not set cast iron county marker or a long pipe because of rock. Set a 1"x24" iron pipe driven in rock, top slightly bent. Placed small rocks around pipe. Set survey sign 1/2' south, existing steel post 1' north.

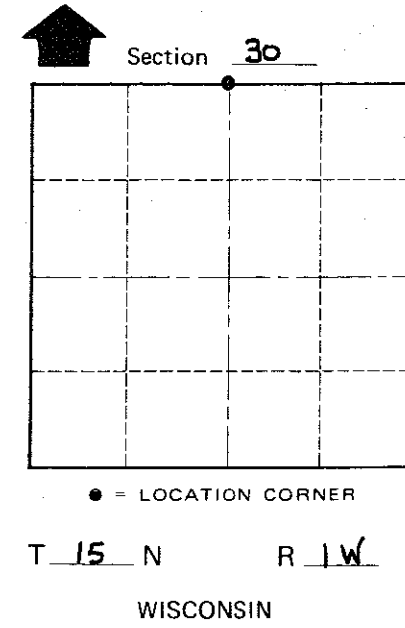

SURVEY CONTROL ORDER

Horizontal	_____
Vertical	_____

WISCONSIN COORDINATE SYSTEM

Corner	East (X)	North (Y)	Elevation (Z)	Zone
Control Sta. Name				

~~City, Village or~~ Town WELLINGTON  
County of MONROE

COUNTY SURVEYOR FORM NO. 1