

21501160020

I, William C. Jung, do hereby certify that on the 14th day of April 1983, I found (evidence) ~~(no evidence)~~ of the North 1/4 corner of Section 21, T 15 N, R 1 W Fourth Principal Meridian, and I re-established said corner according to the Wisconsin Statutes as shown and described hereon.

History of corner establishment since Original Government Survey

A.S. Ingalls re-established this corner in March of 1873. Larry Feddersen accepted the occupied fence corner as the best evidence of the corner in January of 1977.

Description of corner evidence found:

I accepted the occupied fence corner as the best available evidence of the original government corner and Ingalls' corner.

Dated this 2nd day of March 1984.

William C. Jung

Deputy County Surveyor, R.L.S. 1323

Title

COUNTY SURVEYOR FORM NO. 1

Description of corner and witness monuments, references and accessories used to perpetuate the original or re-established location of this corner:

Witnesses to corner location:

William C. Jung

Dallas Wilhite

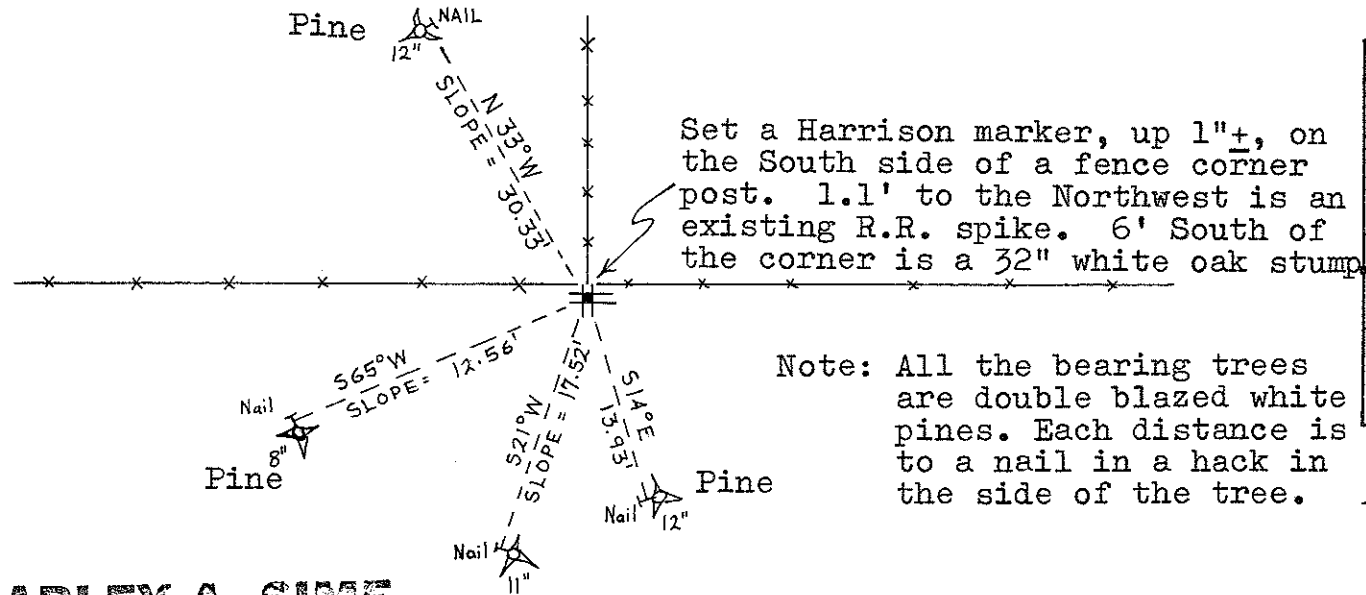
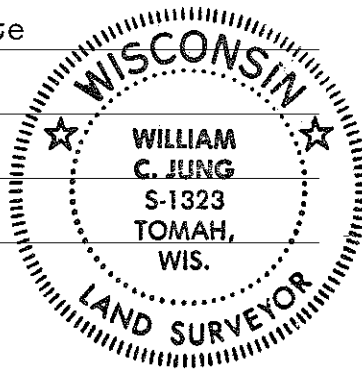

Note: All the bearing trees are double blazed white pines. Each distance is to a nail in a hack in the side of the tree.

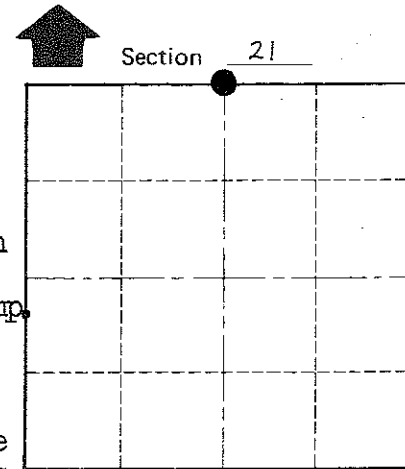

• = LOCATION CORNER

T 15 N R 1 W
WISCONSIN

Approved: **HARLEY A. SIME** Pine
MONROE CO. SURVEYOR

SURVEY CONTROL ORDER

Horizontal _____

Vertical _____

WISCONSIN COORDINATE SYSTEM

Corner	East (X)	North (Y)	Elevation (Z)	Zone
Control Sta. Name				

City, Village or Town _____ of Wellington
County of Monroe
Wisconsin