

21501150020

I, William C. Jung, do hereby certify that on the 17th day of September 1982, I found (evidence) ~~no evidence~~ of the North 1/4 corner of Section 22, T 15 N, R 1 W Fourth Principal Meridian, and I re-established said corner according to the Wisconsin Statutes as shown and described hereon.

Dated this 27th day of Jan. 1983.

William C. Jung

Deputy County Surveyor

History of corner establishment since Original Government Survey
A.S. Ingalls was at this corner in March of 1873. Holden found the original corner in November of 1905. Feddersen set a 1 1/4" iron bar at the occupied fence corner in Janaury of 1977.

Description of corner evidence found:

I found Feddersen's iron bar, accepted it as the corner, removed it, and replaced it with a Harrison.

COUNTY SURVEYOR FORM NO. 1

Description of corner and witness monuments, references and accessories used to perpetuate the original or re-established location of this corner:

Witnesses to corner location:

Jung

Meyer

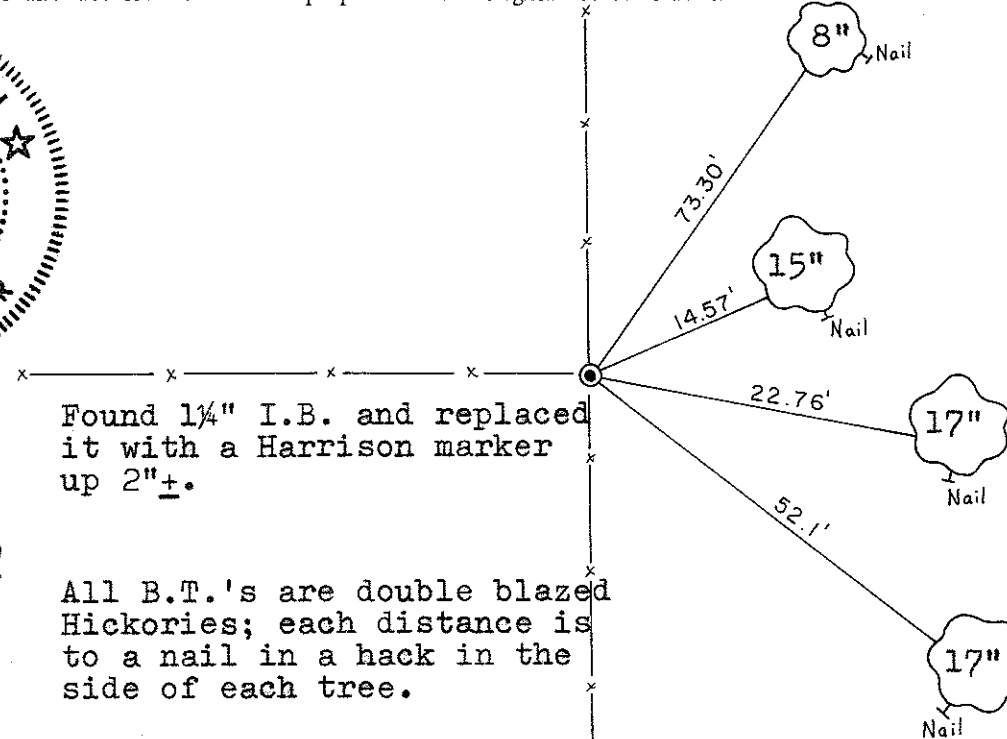
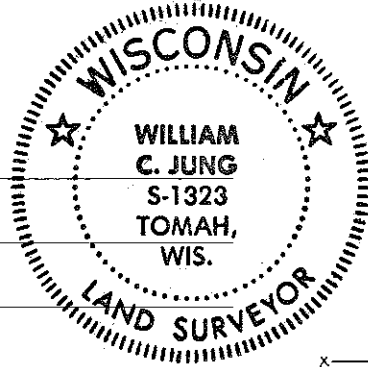

Found 1 1/4" I.B. and replaced it with a Harrison marker up 2"±.

All B.T.'s are double blazed Hickories; each distance is to a nail in a hack in the side of each tree.

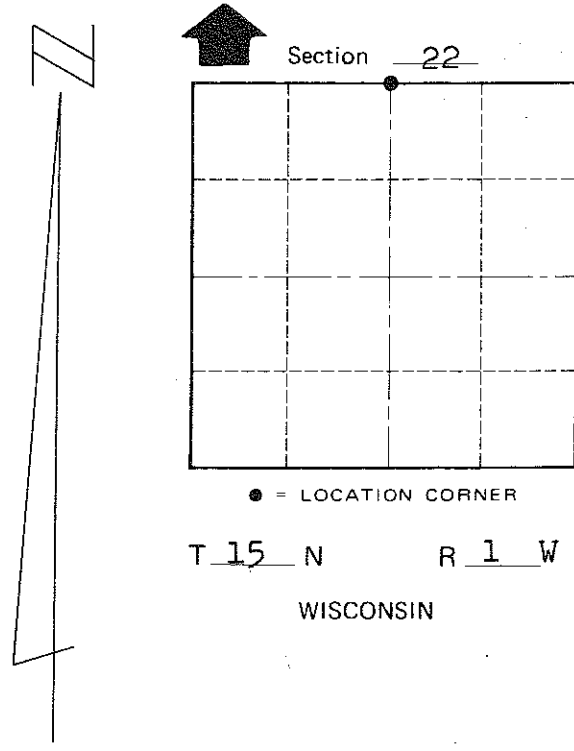

Approved: **HARLEY A. SIME**
MONROE CO. SURVEYOR

SURVEY CONTROL ORDER

Horizontal	_____
Vertical	_____

WISCONSIN COORDINATE SYSTEM

Corner	East (X)	North (Y)	Elevation (Z)	Zone
Control Sta. Name				

~~City, Village or Town~~ of Wellington
County of Monroe