

21501132000

I, William C. Jung, do hereby certify that on the 11th day of October 1982, I found (evidence) ~~(no evidence)~~ of the West 1/4 corner of Section 18, T 15 N, R 1 E Fourth Principal Meridian, and I re-established said corner according to the Wisconsin Statutes as shown and described hereon.

History of corner establishment since Original Government Survey

No history recorded since the original government survey.

Dated this 28th day of Jan. 19 83.

William C. Jung

Deputy County Surveyor

Description of corner evidence found:

I accepted the occupied fence corner as the best available evidence of the original government corner. Zinke, Wurster, and Prell all agree that this is the corner. It appears to be almost exactly on line between the NW and SW section corners. By accepting this corner, the occupied corner at the W1/16SW corner (intersection of "P" and "V") fits the true corner almost perfectly

Description of corner and witness monuments, references and accessories used to perpetuate the original or re-established location of this corner:

Witnesses to corner location

William Jung

Melvin Pliner

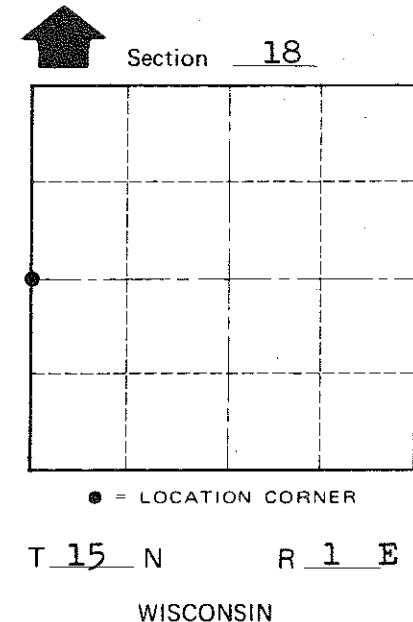
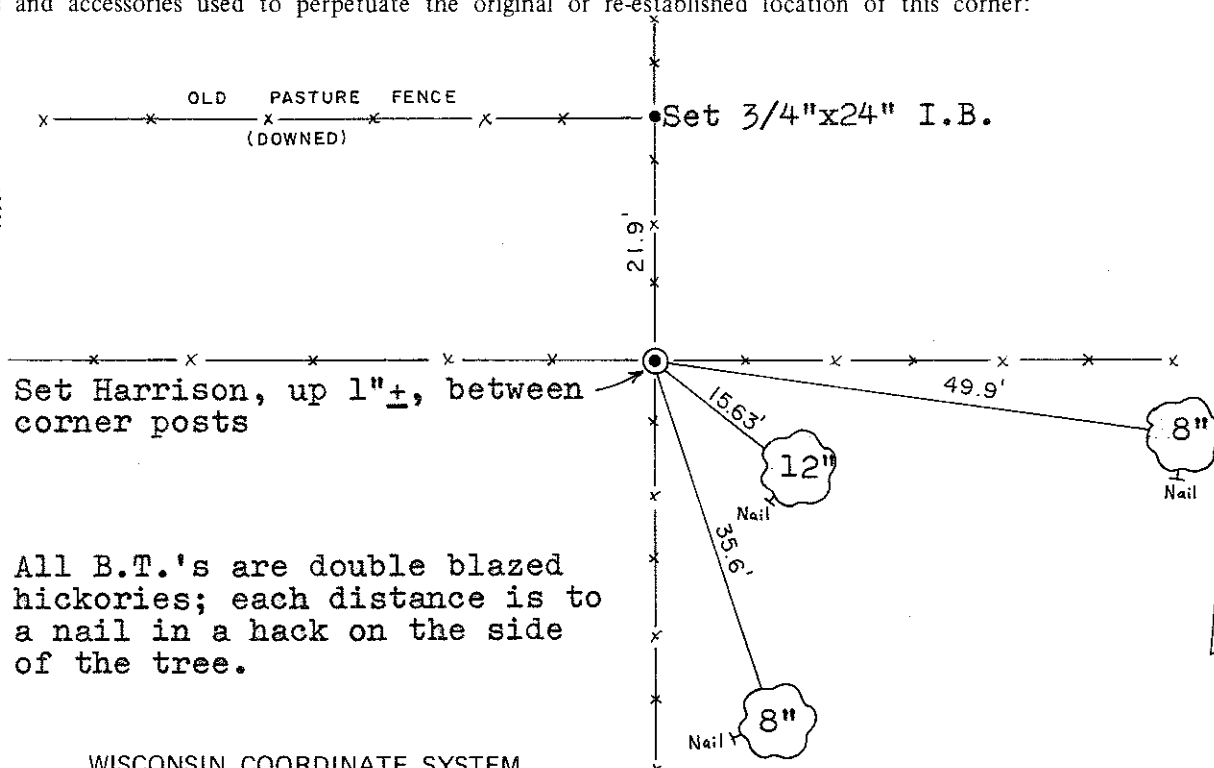
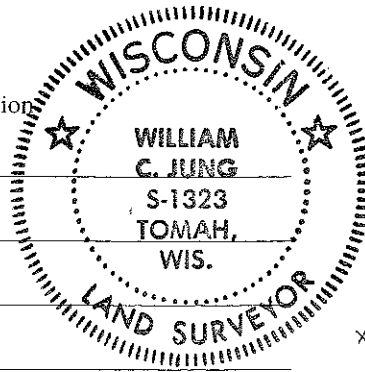

All B.T.'s are double blazed hickories; each distance is to a nail in a hack on the side of the tree.

Approved: HARLEY A. SIME
MONROE CO. SURVEYOR

SURVEY CONTROL ORDER

Table with 2 rows: Horizontal, Vertical

WISCONSIN COORDINATE SYSTEM

Table with 5 columns: Corner, East (X), North (Y), Elevation (Z), Zone

City, Village or Town of Glendale
County of Monroe

COUNTY SURVEYOR FORM NO. 1