

CERTIFICATE

CERTIFIED LAND CORNER

No. 40

**21501122000**

I, Gary L. Dechant, do hereby certify that on the 4th day of August 19 87 I found (evidence) (~~existence~~) of the E 1/4 corner of Section 12, T15 N, R 1 W Fourth Principal Meridian, and I re-established said corner according to the Wisconsin Statutes as shown and described hereon.

History of corner establishment since Original Government Survey

No known recorded history since the original government survey.

Description of corner evidence found:

Accepted Fence corner as best available evidence for the corner, fits Corners north and south very well.

Dated this 7th day of August 19 87.

Gary L. Dechant

Reg. Land Surveyor, S-1744

Title

Description of corner and witness monuments, references and accessories used to perpetuate the original or re-established location of this corner:

Witnesses to corner location:

David E. Madison

Gary L. Dechant

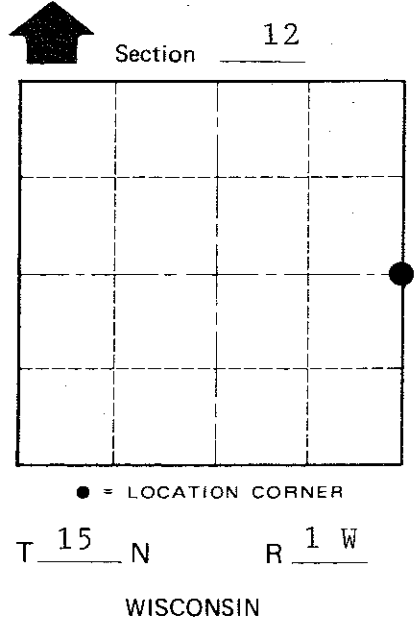
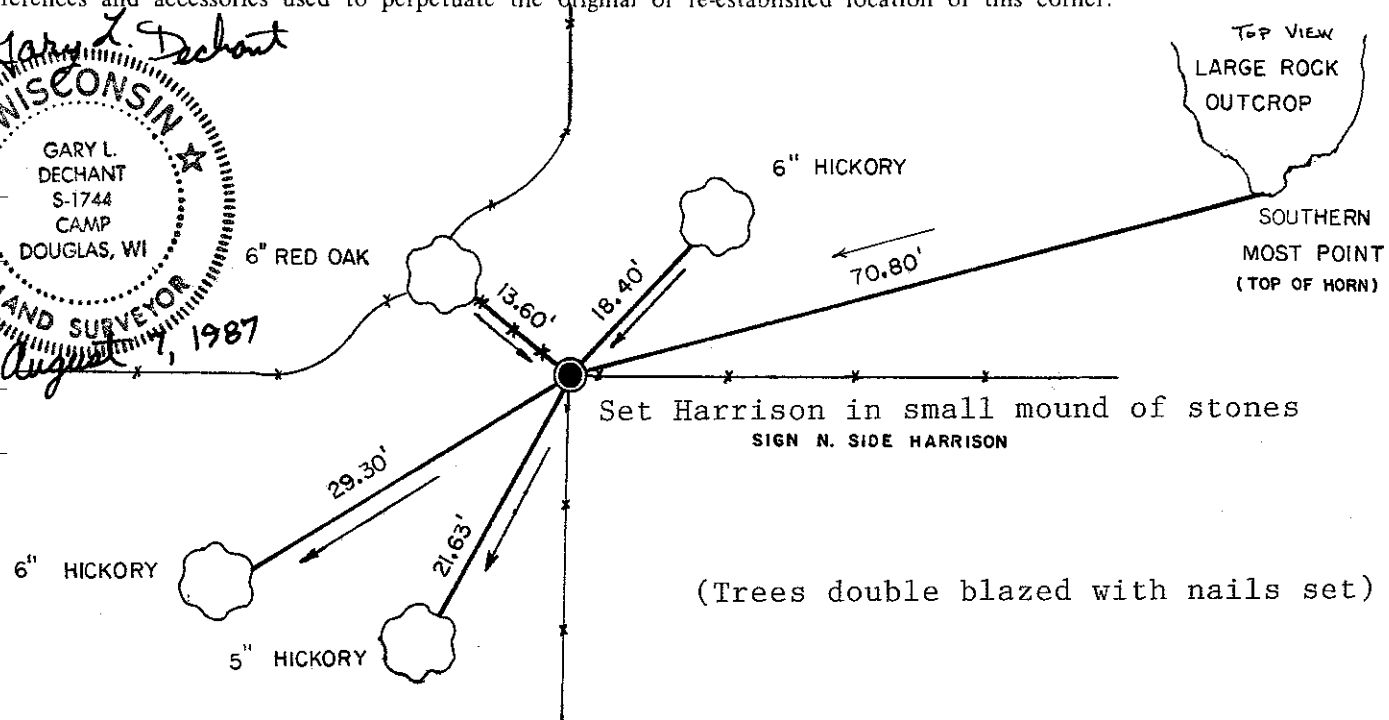
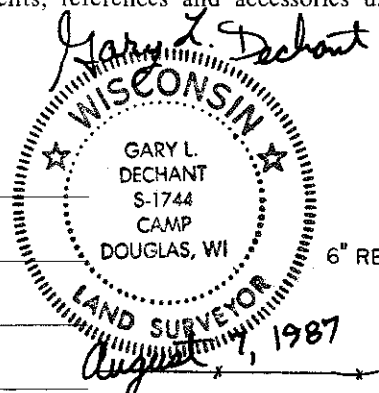

COUNTY SURVEYOR FORM NO. 1

SURVEY CONTROL ORDER

Horizontal \_\_\_\_\_  
Vertical \_\_\_\_\_

WISCONSIN COORDINATE SYSTEM

Corner	East (X)	North (Y)	Elevation (Z)	Zone
Control Sta. Name				

City, Village or Town Wellington  
County of Monroe