

21501120000

I, William C. Jung, do hereby certify that on the 20th day of September 19 82, I found (evidence) ~~(no evidence)~~ of the Northwest corner of Section 18, T 15 N, R 1 E Fourth Principal Meridian, and I re-established said corner according to the Wisconsin Statutes as shown and described hereon.

History of corner establishment since Original Government Survey

No history recorded since the original government survey.

Description of corner evidence found:

I accepted the occupied fence corner as the best available evidence of the original government corner even though my 1/2 mile to the South is long. (See tie sheets for N1/4 and W1/4 Corners of Section 18-T15N-R1E for more information.)

Dated this 26th day of Jan. 19 83.

William C. Jung

Deputy County Surveyor

Title

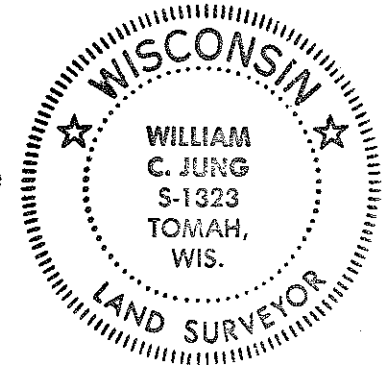

COUNTY SURVEYOR FORM NO. 1

Description of corner and witness monuments, references and accessories used to perpetuate the original or re-established location of this corner:

Witnesses to corner location:

William C. Jung

Melvin Pliner

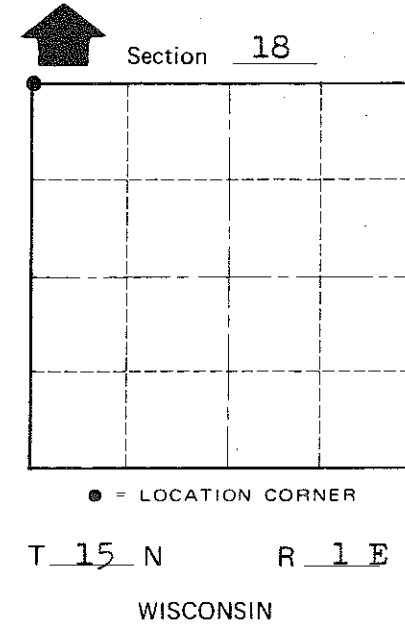
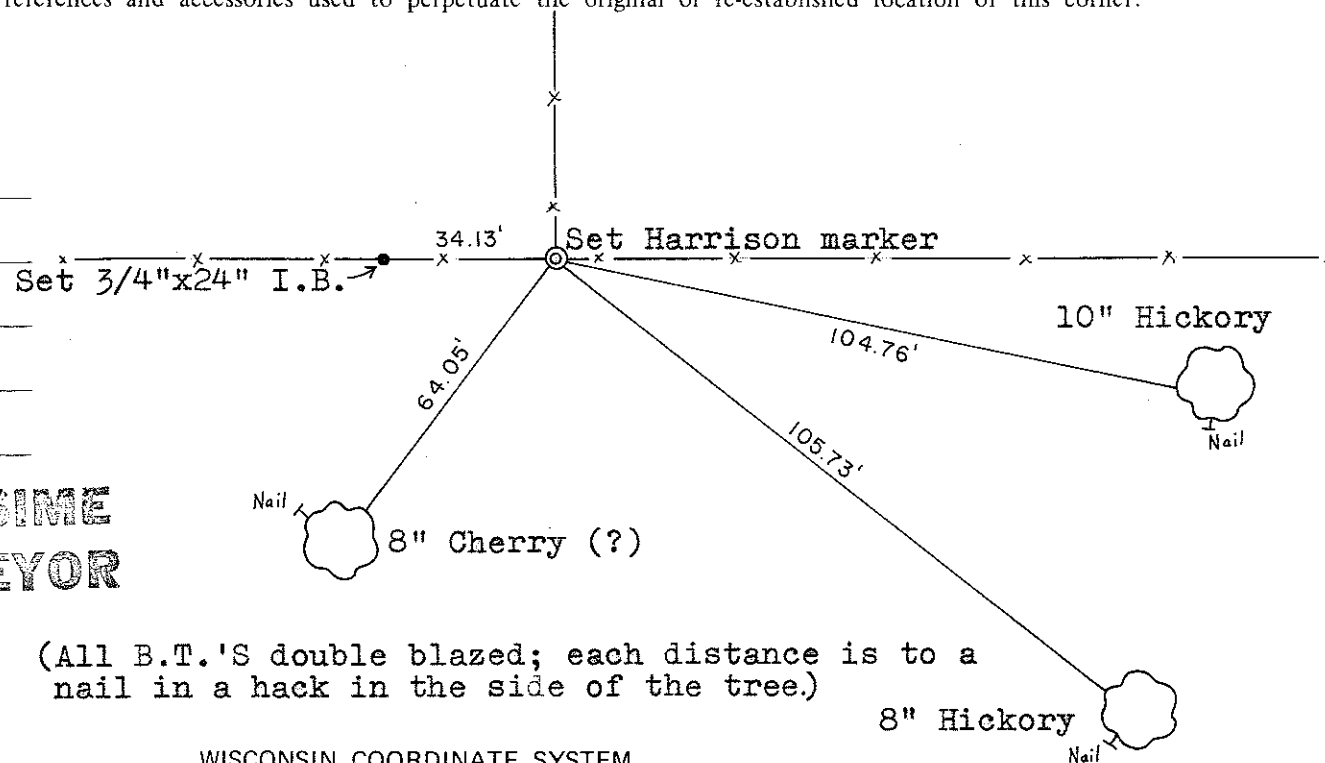

Approved: **HARLEY A. SIME**
MONROE CO. SURVEYOR

(All B.T.'S double blazed; each distance is to a nail in a hack in the side of the tree.)

SURVEY CONTROL ORDER

Horizontal	_____
Vertical	_____

WISCONSIN COORDINATE SYSTEM

Corner	East (X)	North (Y)	Elevation (Z)	Zone
Control Sta. Name				

~~City, Village or~~ Town of Glendale
County of Monroe