

I, Harley A. Sime, do hereby certify that on the 11th day of November 1980, I found (evidence) (~~see evidence~~) of the W1/16NW corner of Section 10, T 15 N, R 1 W Fourth Principal Meridian, and I re-established said corner according to the Wisconsin Statutes as shown and described hereon.

Dated this 11th day of Nov. 1980.

Harley A. Sime - R.L.S. 355

County Surveyor- Monroe Co. Wisconsin
Title

History of corner establishment since Original Government Survey

Frank Davy was here in November of 1926. He set an iron shaft.

Description of corner evidence found:

Found Davy's iron shaft.

COUNTY SURVEYOR FORM NO. 1

Description of corner and witness monuments, references and accessories used to perpetuate the original or re-established location of this corner:

Witnesses to corner location:

Bryan Meyer

Scott Sowers

Approved: HARLEY A. SIME
MONROE CO. SURVEYOR

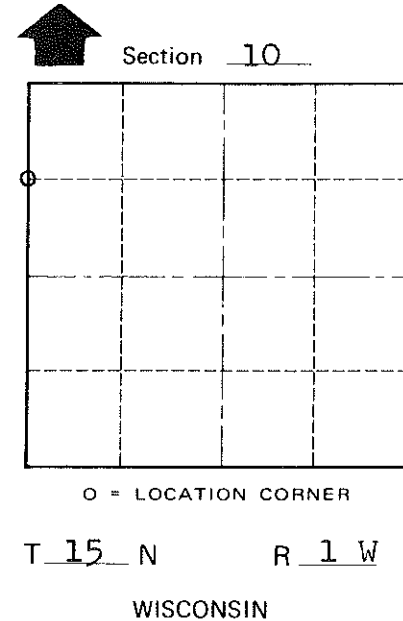
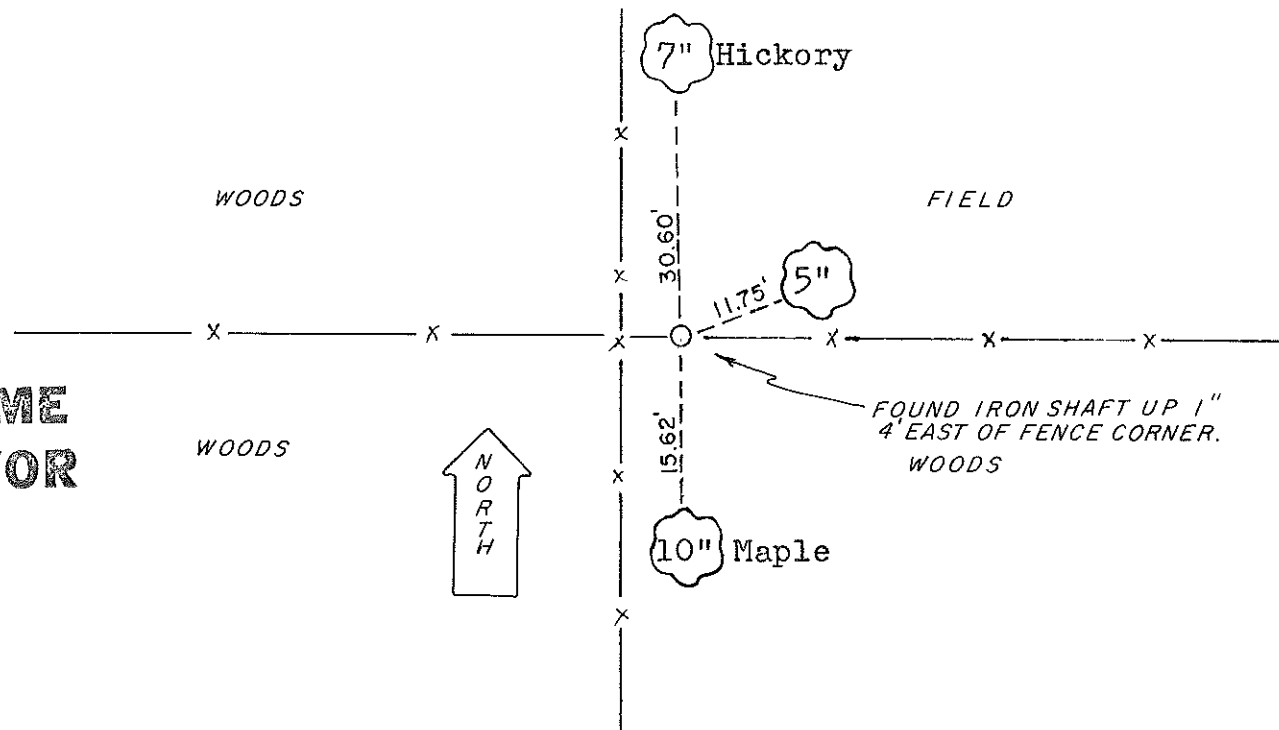

SURVEY CONTROL ORDER

Horizontal	_____
Vertical	_____

WISCONSIN COORDINATE SYSTEM

Corner	East (X)	North (Y)	Elevation (Z)	Zone
Control Sta. Name				

~~City, Village or~~ Town of Wellington

County of Monroe
Wisconsin