

21501092000

I, Harley A. Sime, do hereby certify that on the 11th day of November 1980, I found (evidence) (~~no evidence~~) of the West 1/4 corner of Section 10, T15 N, R 1 W Fourth Principal Meridian, and I re-established said corner according to the Wisconsin Statutes as shown and described hereon.

History of corner establishment since Original Government Survey

Frank Davy was here in November of 1926 and set an iron king bolt and fan mill shaft.

Description of corner evidence found:

Found iron king bolt and fan mill shaft set by Davy, 5' West of fence. Both bearing trees are gone.

Dated this 11th day of Nov. 1980.

Harley A. Sime R.L.S. 355

County Surveyor-Monroe County, Wisconsin

Title

COUNTY SURVEYOR FORM NO. 1

Description of corner and witness monuments, references and accessories used to perpetuate the original or re-established location of this corner:

Witnesses to corner location:

Bryan Meyer

Scott Sowers

OPEN

FIELD

OPEN

FIELD

SIGN PLACED 12/21/90 G.S.

Approved: **HARLEY A. SIME**
MONROE CO. SURVEYOR

Found shaft set by Davy 5' West of fenceline.

Note: Trees are not blazed, but do have nails and caps set. There were no other good ties in the area.

WISCONSIN COORDINATE SYSTEM

SURVEY CONTROL ORDER

Horizontal	_____
Vertical	_____

Corner	East (X)	North (Y)	Elevation (Z)	Zone
Control Sta. Name				

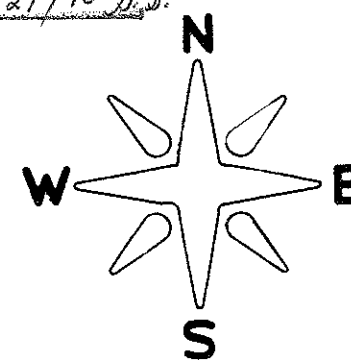
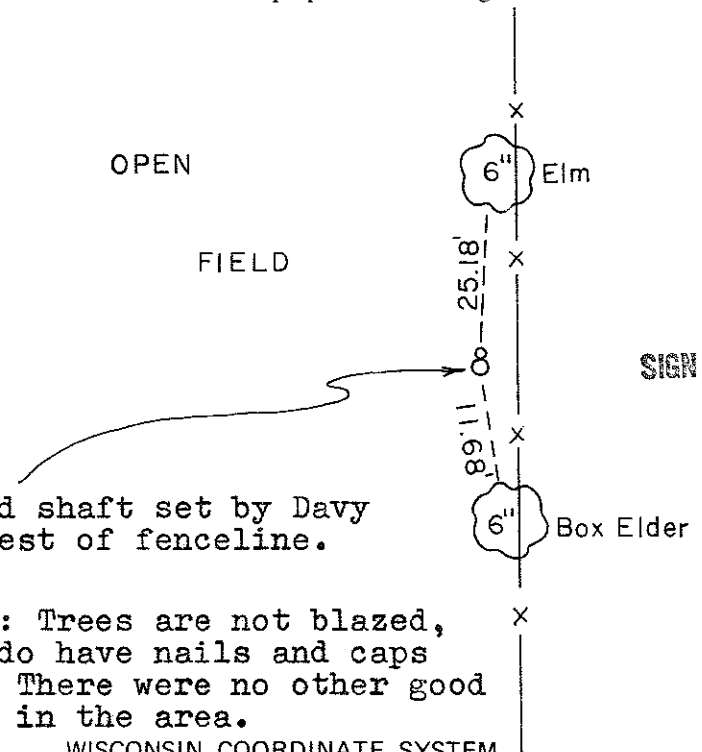

Section 10

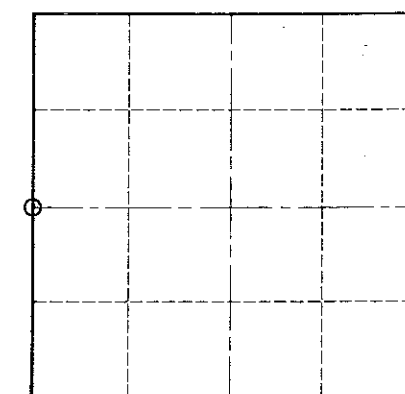

O = LOCATION CORNER

T 15 N R 1 W

WISCONSIN

~~City, Village or Town~~ of Wellington

County of Monroe
Wisconsin