

CERTIFICATE

CERTIFIED LAND CORNER

No. 50

**21501080020**

I, William C. Jung, do hereby certify that on the 22nd day of May 19 78, I found (evidence) (~~no evidence~~) of the S<sup>1</sup>/<sub>4</sub> corner of Section 8, T 15 N, R 1 W Fourth Principal Meridian, and I re-established said corner according to the Wisconsin Statutes as shown and described hereon.

History of original corner establishment:

Fred Holden was here in Dec. of 1902.

Description of corner evidence found:

Accepted fence corner as best available evidence.

Dated this 12th day of Dec. 19 78.

William C. Jung, R.L.S. 1323

Crew Chief, County Surveyor's Office

COUNTY SURVEYOR FORM NO. 1

Description of corner and witness monuments, references and accessories used to perpetuate the original or re-established location of this corner:

Witnesses to corner location:

W. Jung  
G. Dechant

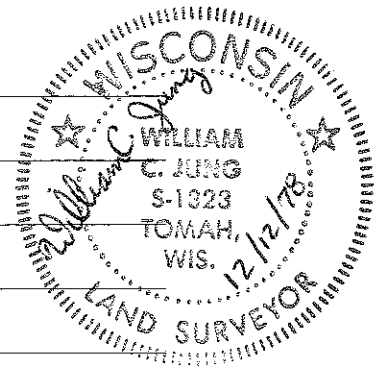

(All trees double blazed with N&C's set)

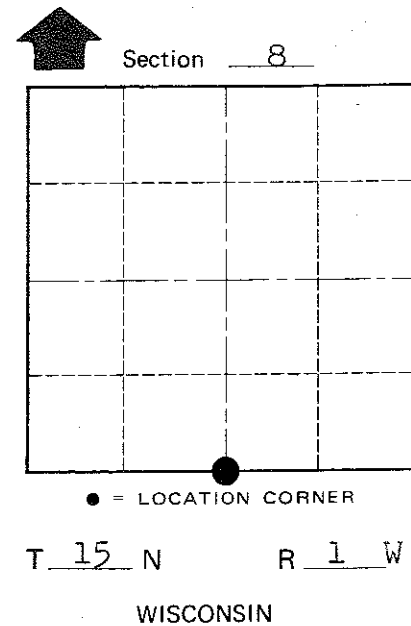
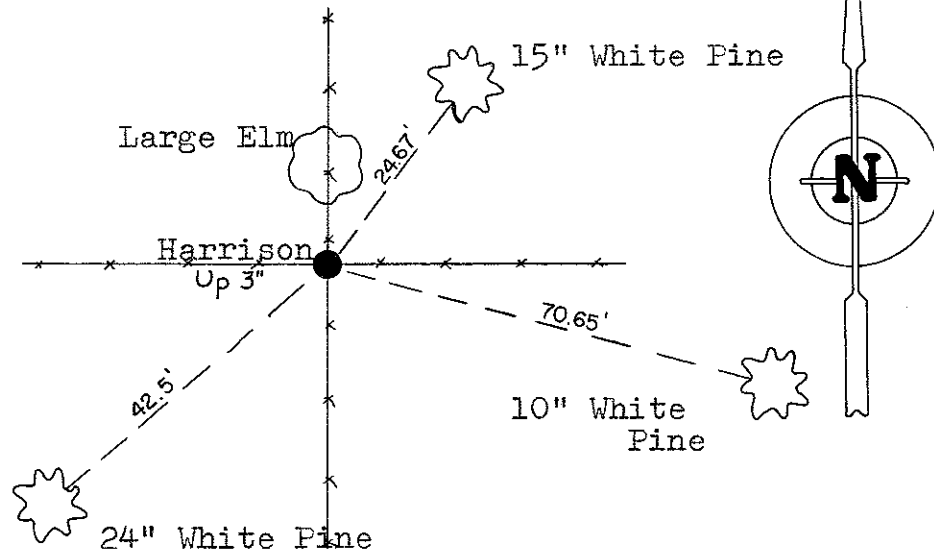

SURVEY CONTROL ORDER

Horizontal	_____
Vertical	_____

Approved by: Harley A. Sime  
County Surveyor

WISCONSIN COORDINATE SYSTEM

Corner	East (X)	North (Y)	Elevation (Z)	Zone
Control Sta. Name				

City, Village or Town Wellington  
County of Monroe