

CERTIFICATE

CERTIFIED LAND CORNER

No. 51

21501070000

I, William C. Jung, do hereby certify that on the 22 day of May 1978, I found (evidence) (~~no evidence~~) of the S.E. corner of Section 7, T 15 N, R 1 W Fourth Principal Meridian, and I re-established said corner according to the Wisconsin Statutes as shown and described hereon.

Dated this 19 day of June 1978.

William C. Jung, R.L.S. 1323
Crew Chief, County Surveyors
Title Office

History of original corner establishment:

Hamilton La Rue was here in Jan. of 1897,
and Fred Holden was here in Dec. 1902

Description of corner evidence found:

Accepted the occupied fence corner as
the best available evidence.

Description of corner and witness monuments, references and accessories used to perpetuate the original or re-established location of this corner:

All trees single blazed with N&c set

Witnesses to corner location:

W. Jung
G. Dechant

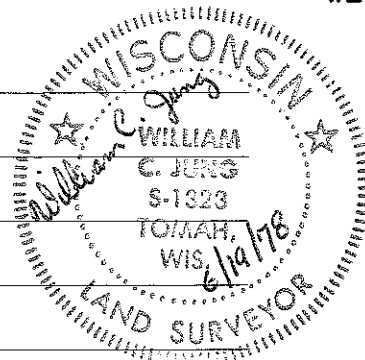

Approved by: Harley A. Sime
County Surveyor

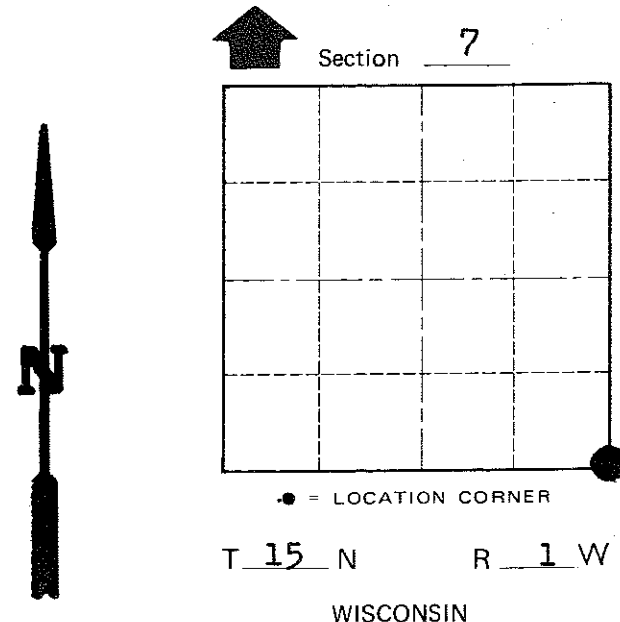
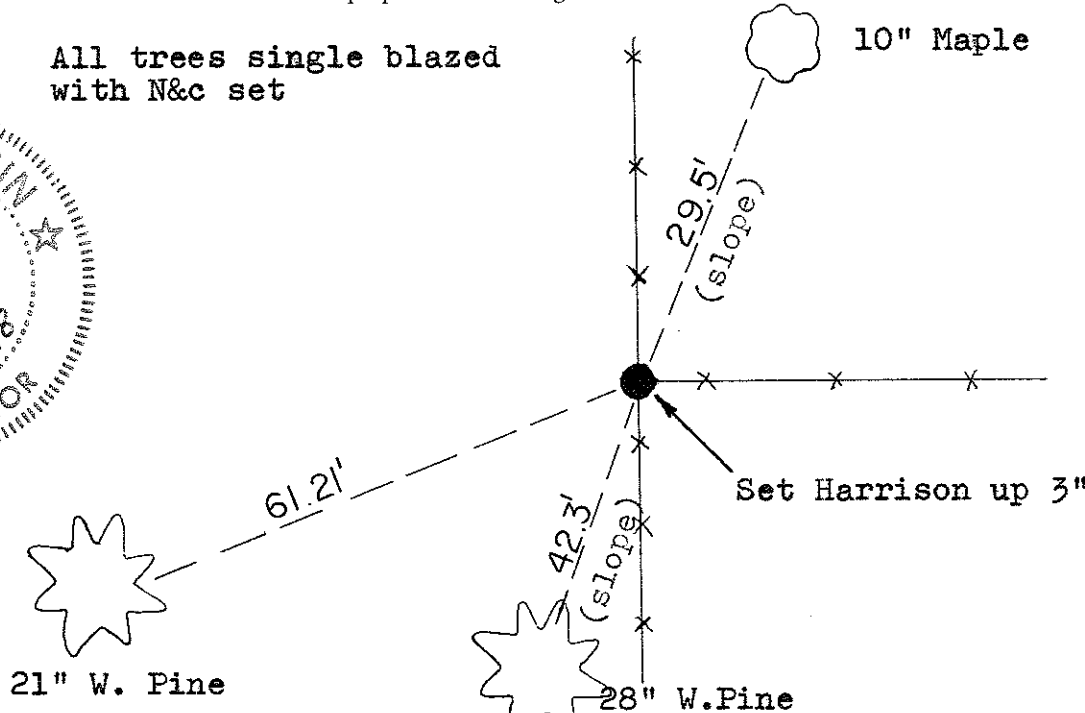

COUNTY SURVEYOR FORM NO. 1

SURVEY CONTROL ORDER

Horizontal _____
Vertical _____

WISCONSIN COORDINATE SYSTEM

Corner	East (X)	North (Y)	Elevation (Z)	Zone
Control Sta. Name				

City, Village or Town Wellington
County of Monroe