

21501062000

I, Garold A. Sime, do hereby certify that on the 17th day of July, 1992, I found (evidence) ~~(no evidence)~~ of the W/4 corner of Section 5, T 15 N, R 1W Fourth Principal Meridian, and I re-established said corner according to the Wisconsin Statutes as shown and described hereon.

Dated this 17th day of July, 1992.

Garold A. Sime

Monroe County Surveyor
Title

History of corner establishment since Original Government Survey

Hamilton LaRue was at this corner in February of 1897.

Fred Zietlow calls for a 1" iron pipe at this corner in his surveys dated Nov. 9, 1968 and June 6, 1969. Bill Jung was at this corner and found a P.K. Nail set next to angle iron fence post. He also found the 1" iron pipe lying flat. He accepted the P.K. as the corner as of 6-23-81.
Description of corner evidence found:

I accepted P.K. Nail as best available evidence of the corner location. This location also fits the distance given to the Northwest corner of the SW/4-Frac.NW/4 very well.

COUNTY SURVEYOR FORM NO. 1

Description of corner and witness monuments, references and accessories used to perpetuate the original or re-established location of this corner:

Existing P. K. Nail at corner.
Set cast iron Harrison Monument 1.32 feet west of P.K. as witness

Witnesses to corner location:

Garold A. Sime, R.L.S.

John Kenworthy

Brent Kostka

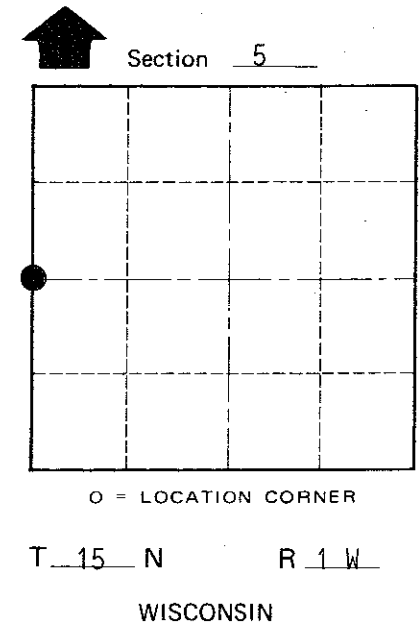
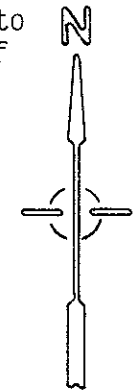
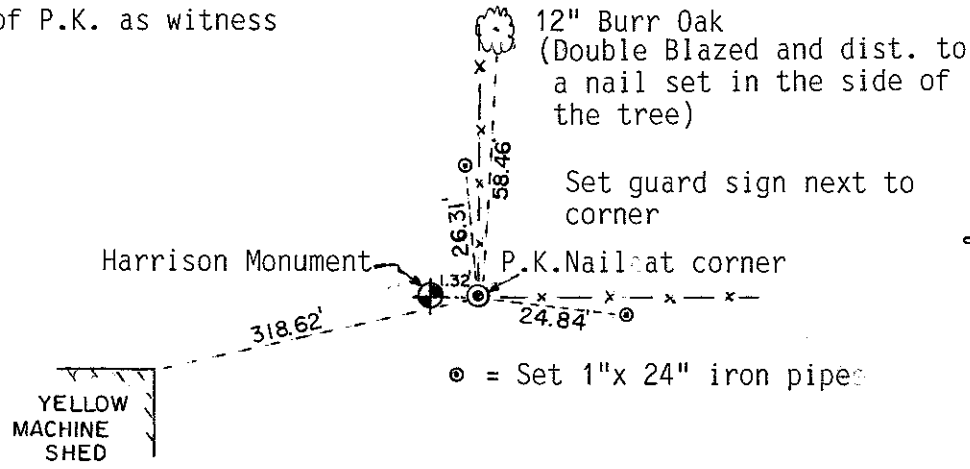
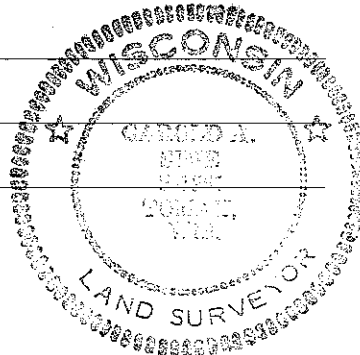

SURVEY CONTROL ORDER

Horizontal	_____
Vertical	_____

WISCONSIN COORDINATE SYSTEM

Corner	East (X)	North (Y)	Elevation (Z)	Zone
Control Sta. Name				

~~City, Village~~ or Town of Wellington
County of Monroe