

21501020020

I, William C. Jung, do hereby certify that on the 4th day of May 1984, I found (evidence) ~~(no evidence)~~ of the South 1/4 corner of Section 2, T15 N, R1 W Fourth Principal Meridian, and I re-established said corner according to the Wisconsin Statutes as shown and described hereon.

Dated this 8th day of May 1984.

William C. Jung

Deputy County Surveyor, R.L.S. 1323

History of corner establishment since Original Government Survey

In his survey done in November of 1901, Fred Holden shows an iron pipe at this corner.

Description of corner evidence found:

I found an old iron monument about 6" South of the East-West tie post. The monument had a 2 1/2" round top and was 18" long. This must be Holden's corner as I found a rotted stump to the Northeast that fits his notes. I set a Harrison marker South of and leaning to the North and over the old monument. The Harrison is the corner. I mounded stones around the Harrison. Holden's old corner appears to be wagon thimble. This has happened before where Holden calls for a pipe and I found a thimble. The thimble appears to be a pipe before you dig it out.

Description of corner and witness monuments, references and accessories used to perpetuate the original or re-established location of this corner:

Witnesses to corner location:

William C. Jung

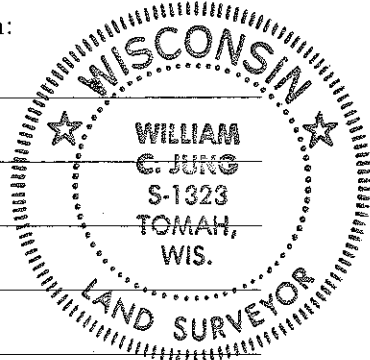

Approved: Harley Sime County Surveyor

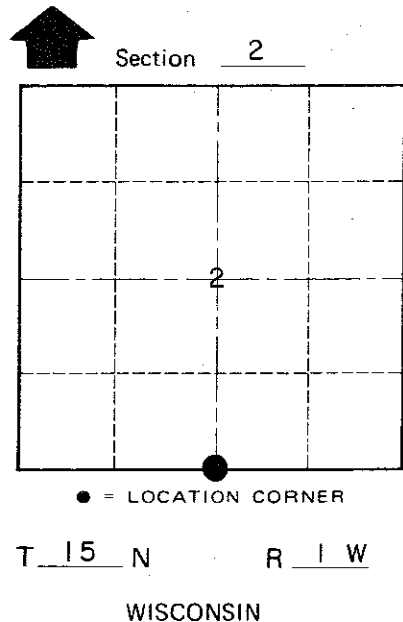
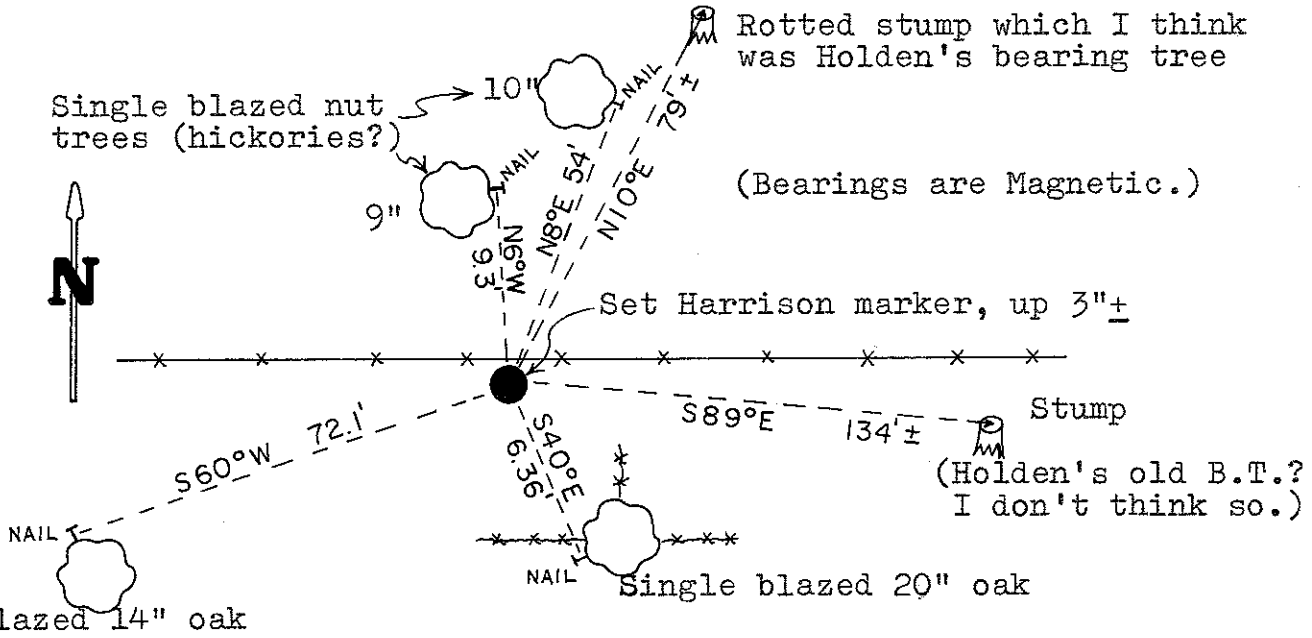

SURVEY CONTROL ORDER

Horizontal _____
Vertical _____

WISCONSIN COORDINATE SYSTEM

Corner	East (X)	North (Y)	Elevation (Z)	Zone
Control Sta. Name				

Note: All distances are to nails in hacks on the sides of the trees.

City, Village or Town Wellington
County of Monroe
Wisconsin

COUNTY SURVEYOR FORM NO. 1