

CERTIFICATE

CERTIFIED LAND CORNER

No. 115

41501312000

I, Harley A. Sime, do hereby certify that on the sixteenth day of January 1980, I found (evidence) ~~XXXXXXXXXX~~ of the West 1/4 corner of Section 32, T 15 N, R 1 E Fourth Principal Meridian, and I re-established said corner according to the Wisconsin Statutes as shown and described hereon.

Dated this 24th day of Feb. 1981.

Harley A. Sime - R.L.S. 355

County Surveyor-Monroe County, Wisconsin.

Title

History of corner establishment since Original Government Survey
 In June of 1904, Fred Holden set a piece of iron sleigh shoe at this corner. In June of 1974, Duane Marten set an iron bar at this corner. He did not find the sleigh shoe.

Description of corner evidence found:

Found Marten's iron bar at the occupied corner; removed the iron bar, and replaced it with a Harrison marker. Accepted the fence corner as the best available evidence of the original government corner.

Description of corner and witness monuments, references and accessories used to perpetuate the original or re-established location of this corner:

Witnesses to corner location:

Gary DeChant

Todd Tormoen

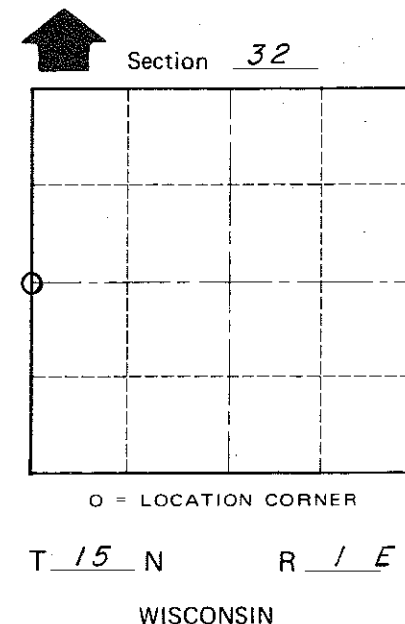
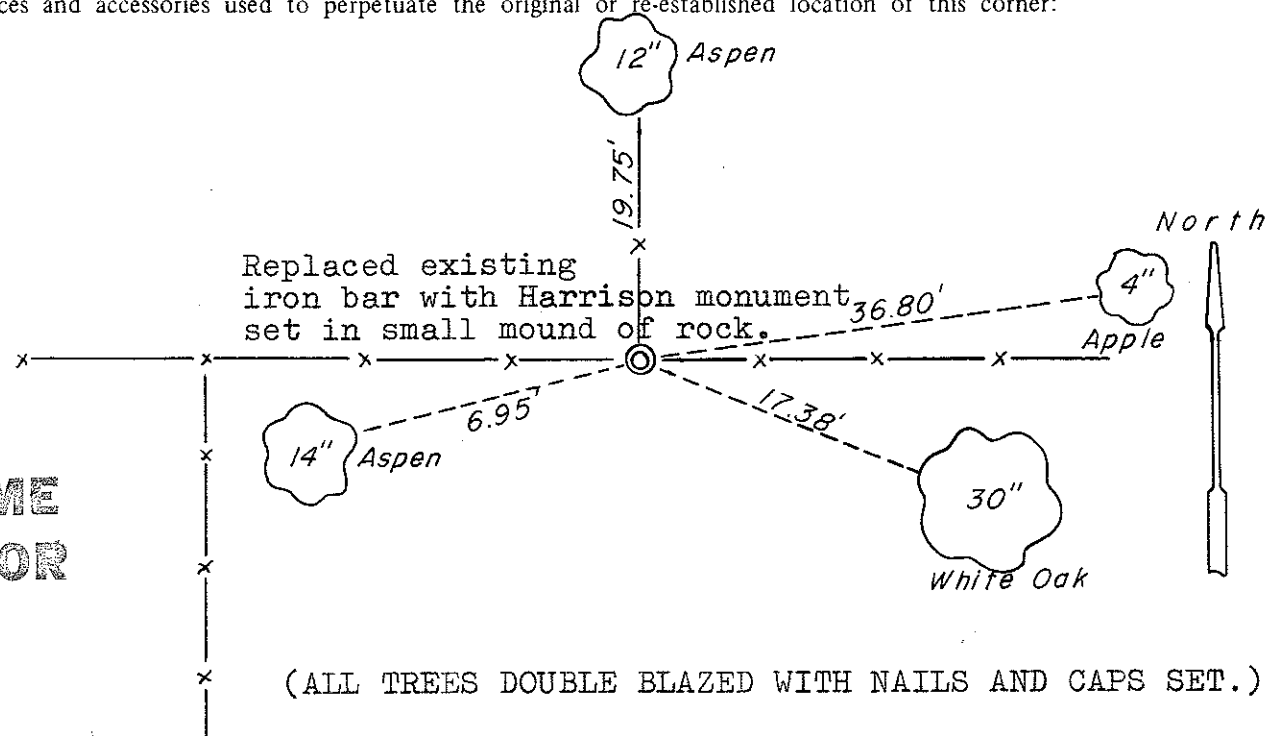

(ALL TREES DOUBLE BLAZED WITH NAILS AND CAPS SET.)

**Approved: HARLEY A. SIME
 MONROE CO. SURVEYOR**

SURVEY CONTROL ORDER

Horizontal	_____
Vertical	_____

Corner	East (X)	North (Y)	Elevation (Z)	Zone
Control Sta. Name				

~~XXXXXXXXXX~~ Town of Glendale
 County of Monroe
Wisconsin

COUNTY SURVEYOR FORM NO. 1