

41501302000

I, Harley A. Sime, do hereby certify that on the 4th day of September 1981, I found (evidence) ~~no evidence~~ of the East 1/4 corner of Section 30, T15 N, R 1 E Fourth Principal Meridian, and I re-established said corner according to the Wisconsin Statutes as shown and described hereon.

Dated this 19th day of Jan. 1982.

Approved: **HARLEY A. SIME**
MONROE CO. SURVEYOR

History of corner establishment since Original Government Survey

In May of 1904, Fred Holden re-established this corner, setting an iron pipe and a stone at the corner.

Description of corner evidence found:

Found Holden's stone with a cross. Set a steel post 1' + South of the stone as a witness marker. Stone was buried; dug a tapered hole around the stone. Made a stone arrow formation 6' Southeast of the corner (distance is to tip of arrow). Dug a trench to the Southwest of corner to prevent the covering of the stone by erosion.

COUNTY SURVEYOR FORM NO. 1

Description of corner and witness monuments, references and accessories used to perpetuate the original or re-established location of this corner:

Witnesses to corner location:

G. Dechant

B. Meyer

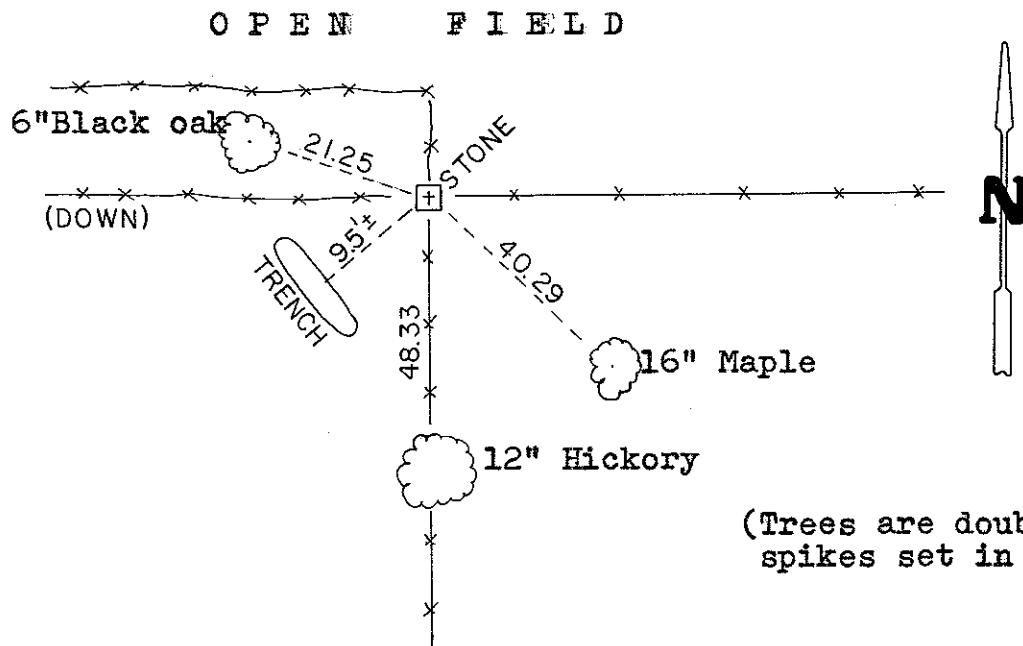

(Trees are double blazed with spikes set in lower blaze.)

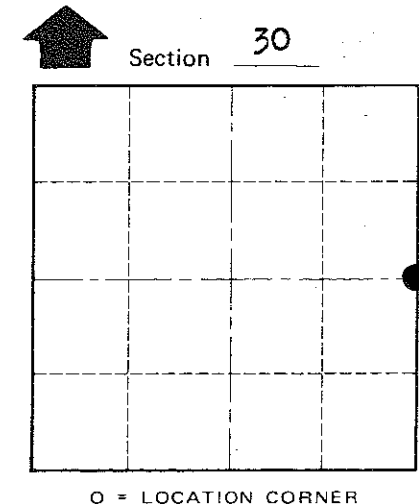

O = LOCATION CORNER

T 15 N R 1 E

WISCONSIN

SURVEY CONTROL ORDER

Horizontal	_____
Vertical	_____

WISCONSIN COORDINATE SYSTEM

Corner	East (X)	North (Y)	Elevation (Z)	Zone
Control Sta. Name				

City, Village or Town Glendale
County of Monroe
Wisconsin