

41501300020

I, William C. Jung, do hereby certify that on the 7th day of September 1982, I found (evidence) ~~(no evidence)~~ of the North 1/4 corner of Section 31, T 15 N, R 1 E Fourth Principal Meridian, and I re-established said corner according to the Wisconsin Statutes as shown and described hereon.

History of corner establishment since Original Government Survey

Holden re-established this corner in June of 1904.

Description of corner evidence found:

I accepted the occupied fence corner as the best available evidence of the original government corner and Holden's corner. This location fits the existing field evidence very well, especially along the North-South 1/4 line of Section 31. The new large wood fence post (which Parkhurst says is at the location of Holden's iron, now gone) at the Center 1/4 of Section 31, is almost exactly on line and equidistant between the North 1/4 and South 1/4 Corners.

Dated this 26th day of Jan. 1983.

William C. Jung
Deputy County Surveyor

COUNTY SURVEYOR FORM NO. 1

Description of corner and witness monuments, references and accessories used to perpetuate the original or re-established location of this corner:

Witnesses to corner location

Jung
Pliner

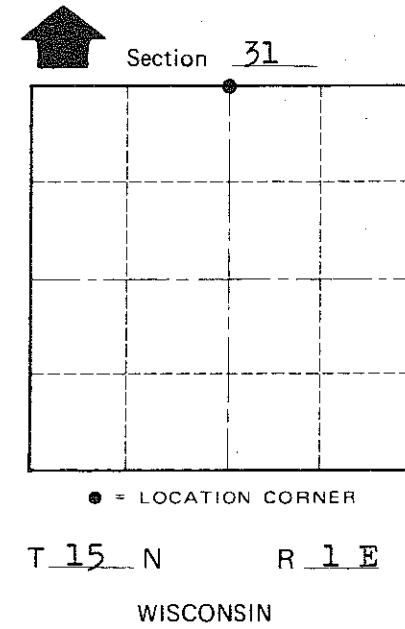
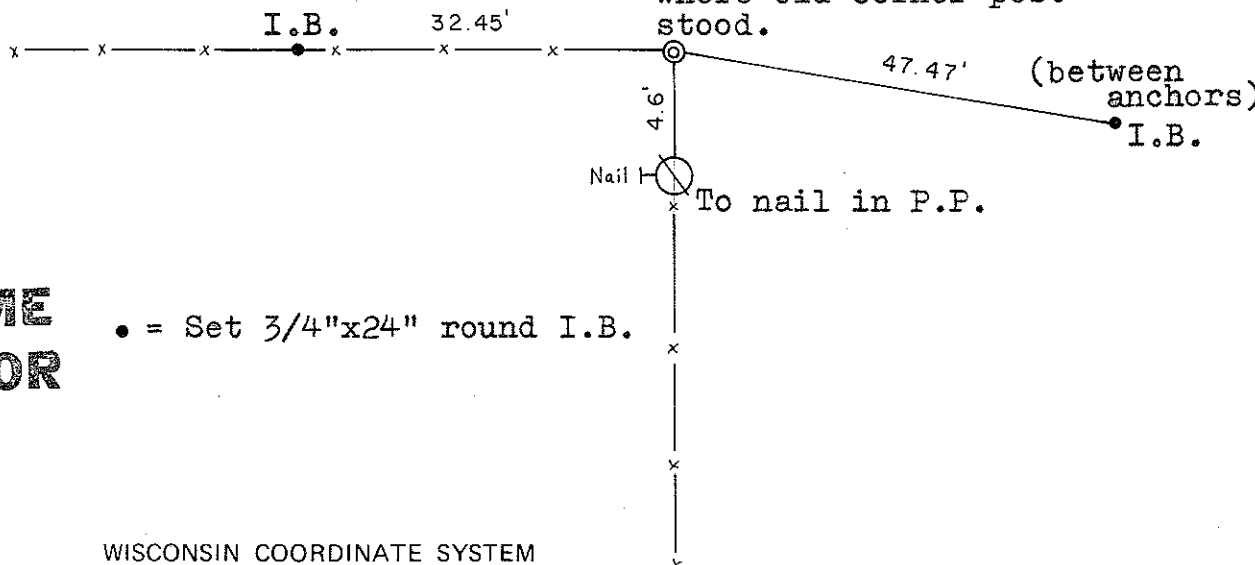
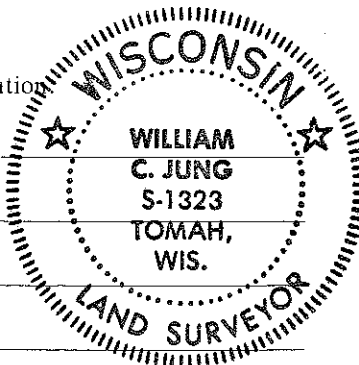

• = Set 3/4"x24" round I.B.

Approved: **HARLEY A. SIME**
MONROE CO. SURVEYOR

SURVEY CONTROL ORDER

Horizontal	_____
Vertical	_____

WISCONSIN COORDINATE SYSTEM

Corner	East (X)	North (Y)	Elevation (Z)	Zone
Control Sta. Name				

~~City, Village or~~ Town of Glendale
County of Monroe