

CERTIFICATE

CERTIFIED LAND CORNER

No. 102

41501250020

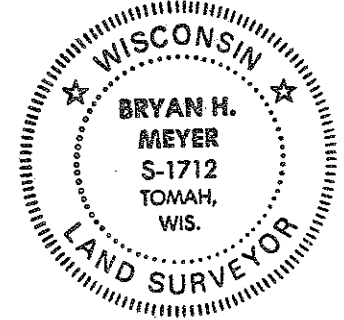

H. A. Sime and Associates
 P. O. Box 705
 Tomah, Wisconsin 54660
 Phone: (608)-372-5392

I, Bryan H. Meyer, do hereby certify that on the 27th day of July 1992, I found (no evidence) of the North $\frac{1}{4}$ corner of Section 36, T 15 N, R 1 E Fourth Principal Meridian, and I re-established said corner according to the Wisconsin Statutes as shown and described hereon.

Dated this 28th day of July 1992.

Bryan H. Meyer
 Deputy County Surveyor
Title

History of corner establishment since Original Government Survey

Nothing recorded.

Description of corner evidence found:

I re-established this corner on line and equidistant between the Northeast and Northwest corners of Section 36, as per law.

COUNTY SURVEYOR FORM NO. 1

Description of corner and witness monuments, references and accessories used to perpetuate the original or re-established location of this corner:

Crew: Kostka, Kenworthy, Meyer
 Date: July 27, 1992
 Weather: Partly Cloudy, 75°±
 Witnesses to corner location:

Brent Kostka
John Kenworthy
Bryan H. Meyer

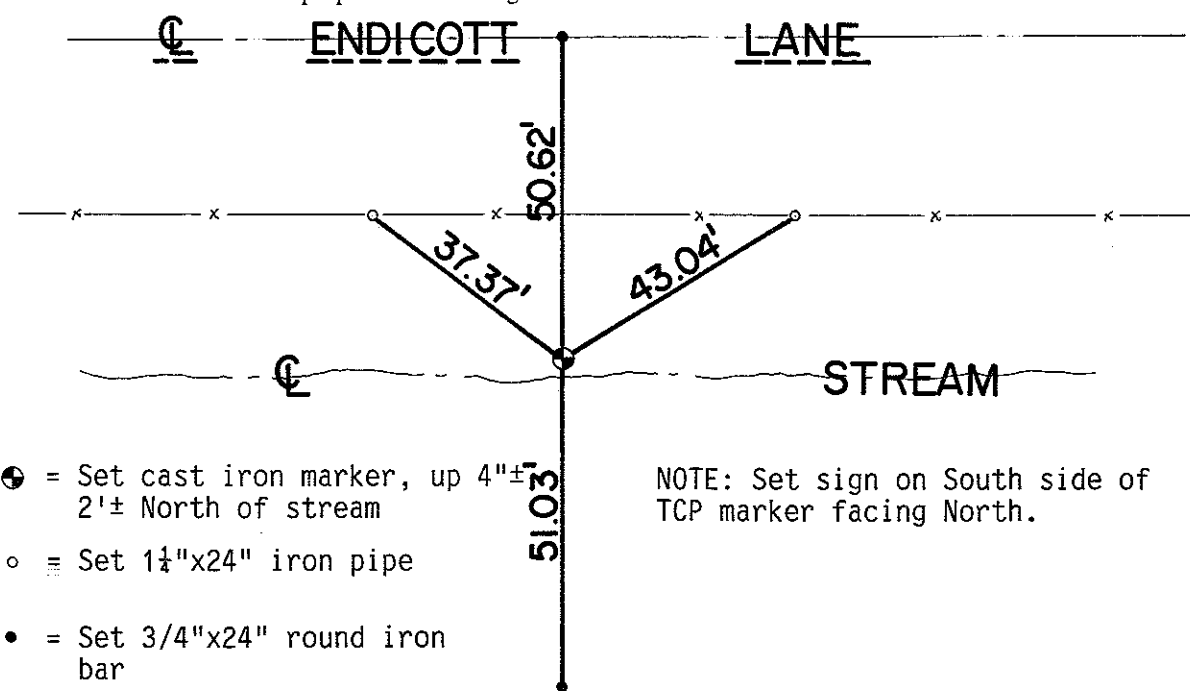

- = Set cast iron marker, up 4"±, 2'± North of stream
- = Set 1½"x24" iron pipe
- = Set ¾"x24" round iron bar

NOTE: Set sign on South side of TCP marker facing North.

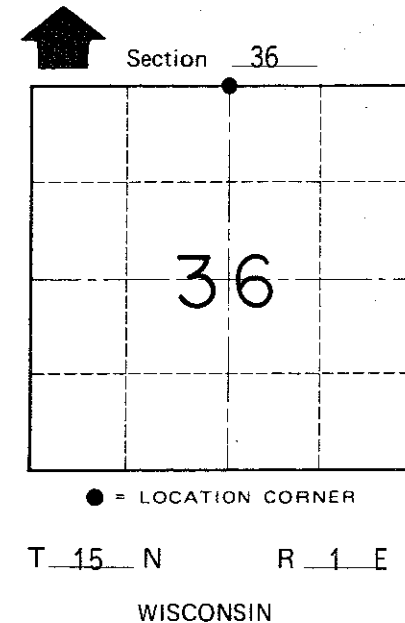

SURVEY CONTROL ORDER

Horizontal	_____
Vertical	_____

WISCONSIN COORDINATE SYSTEM

Corner	East (X)	North (Y)	Elevation (Z)	Zone
Control Sta. Name				

~~City, Village or~~ Town of Glendale

County of Monroe