

4150122000

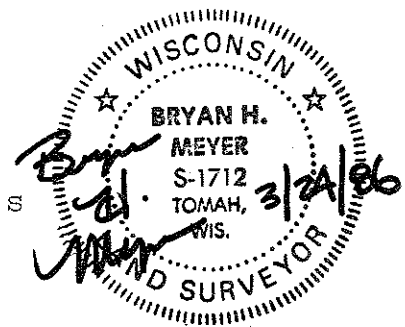

I, Bryan H. Meyer, do hereby certify that on the 24th day of March 19 86, I found (evidence) ~~no evidence~~ of the East 1/4 corner of Section 22, T 15 N, R 1 E Fourth Principal Meridian, and I re-established said corner according to the Wisconsin Statutes as shown and described hereon.

Dated this 24th day of Mar. 19 86.

Bryan H. Meyer
Deputy County Surveyor
Title

History of corner establishment since Original Government Survey

Fred A. Holden was here in May of 1904, March of 1905 and November of 1906. He set a "piece of iron sleigh shoe" in the 1904 survey.

Description of corner evidence found:

Edwin Wolfgram, a local landowner, notified the County Surveyor's office, that a tree that his father told him was a witness tree, had blown down. Upon investigation I found a 36" Jack Oak had fallen to the East. Measuring from the approximate base and going Holden's bearing and distance I found Holden's sleigh shoe and accepted it as the corner.

COUNTY SURVEYOR FORM NO. 1

Description of corner and witness monuments, references and accessories used to perpetuate the original or re-established location of this corner:

Crew: Meyer, Wilhite
Date: March 24, 1986 - 9:00 A. M.
Weather: Sunny, Windy.
Witnesses to corner location:

Bryan H. Meyer

Dallas Wilhite

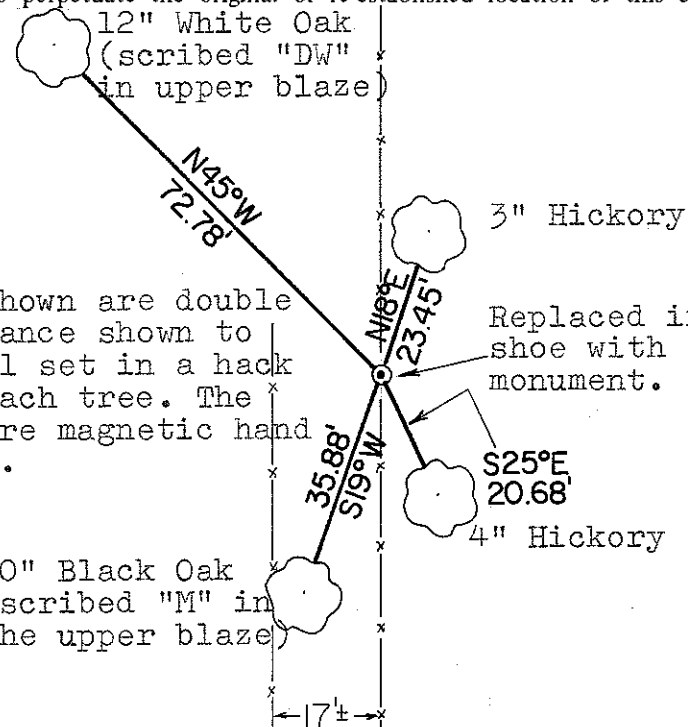

The four trees shown are double blazed; the distance shown to each is to a nail set in a hack in the side of each tree. The bearings shown are magnetic hand compass bearings.

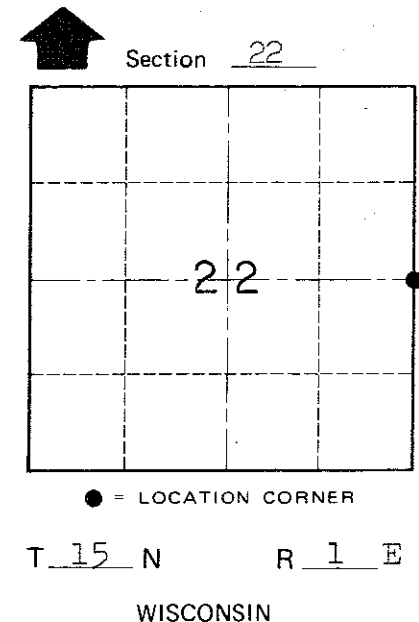

SURVEY CONTROL ORDER

Horizontal	_____
Vertical	_____

WISCONSIN COORDINATE SYSTEM

Corner	East (X)	North (Y)	Elevation (Z)	Zone
Control Sta. Name				

~~City, Village or~~ Town of Glendale

County of Monroe