

CERTIFICATE

CERTIFIED LAND CORNER

No. 86

41501220020

I, William C. Jung, do hereby certify that on the nineteenth day of May 1981, I found (evidence) ~~(no evidence)~~ of the North 1/4 corner of Section 27, T 15 N, R 1 E, Fourth Principal Meridian, and I re-established said corner according to the Wisconsin Statutes as shown and described hereon.

Dated this 31st day of Aug. 1981.

William C. Jung

Registered Land Surveyor 1323

Title

History of original corner establishment:

Fred Holden re-established this corner in May of 1905 and set a piece of sleigh shoe.

Description of corner evidence found:

I accepted the occupied fence corner as the best available evidence of the original government corner and Holden's corner. Existing measured field evidence supports this. I measured fences to the East and they fit this corner very well. The fence to the South fits very well for bearing. I searched for but could not find the sleigh shoe.

Description of corner and witness monuments, references and accessories used to perpetuate the original or re-established location of this corner:

Witnesses to corner location:

William C. Jung

Carlton R. Pietz

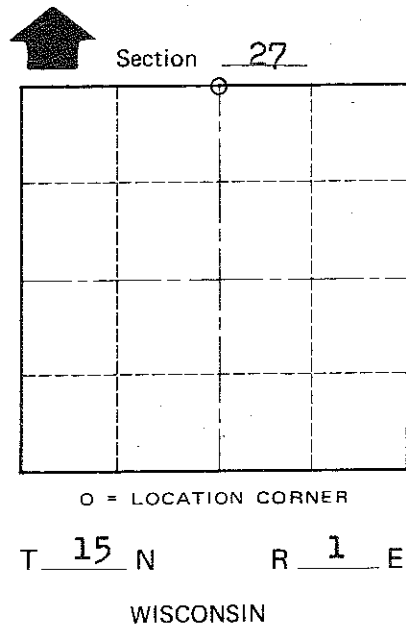
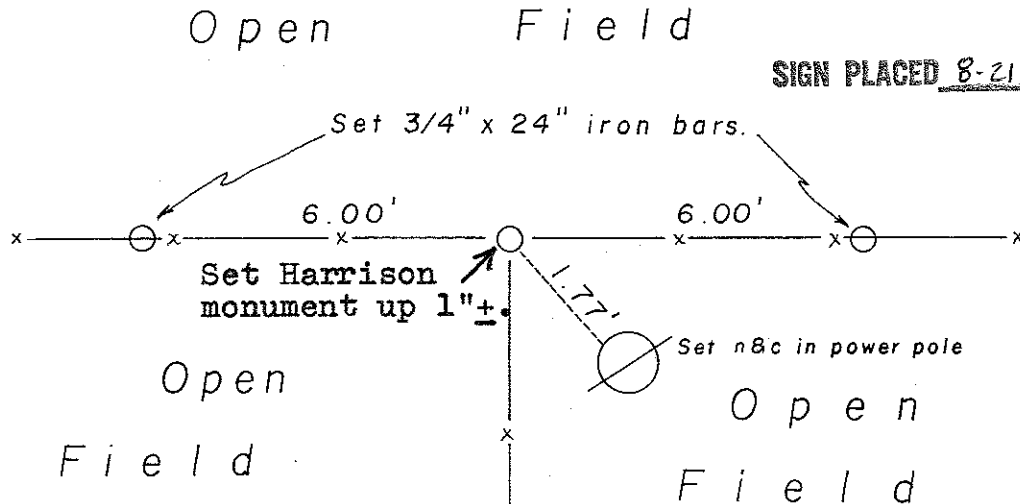
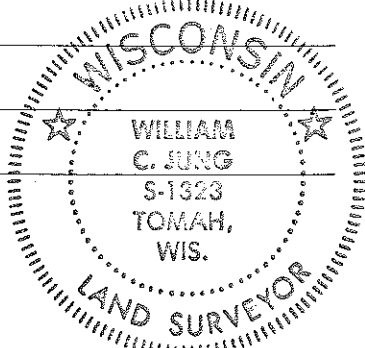

Approved: **HARLEY A. SIME**
MONROE CO. SURVEYOR

SURVEY CONTROL ORDER

| | |
|------------|-------|
| Horizontal | _____ |
| Vertical | _____ |

WISCONSIN COORDINATE SYSTEM

| Corner | East (X) | North (Y) | Elevation (Z) | Zone |
|-------------------|----------|-----------|---------------|------|
| Control Sta. Name | | | | |

~~City, Village~~ Town of Glendale
County of Monroe

COUNTY SURVEYOR FORM NO. 1