

4150120000

I, William C. Jung, do hereby certify that on the twenty-second day of March 1982, I found (evidence) ~~the evidence~~ of the Northeast corner of Section 29, T15 N, R 1 E Fourth Principal Meridian, and I re-established said corner according to the Wisconsin Statutes as shown and described hereon.

Dated this 29th day of March 1982.

William C. Jung, R.L.S. 1323

County Surveyor's Office

Title

William C. Jung

Description of corner and witness monuments, references and accessories used to perpetuate the original or re-established location of this corner:

Witnesses to corner location:

Gary Dechant

Bryan Meyer

**Approved: HARLEY A. SIME
MONROE CO. SURVEYOR**

History of corner establishment since Original Government Survey

Fred Holden found the original corner still existing in May of 1904.

Description of corner evidence found:

I accepted a four-way occupied fence corner as the best available evidence of the original gov't corner.



COUNTY SURVEYOR FORM NO. 1

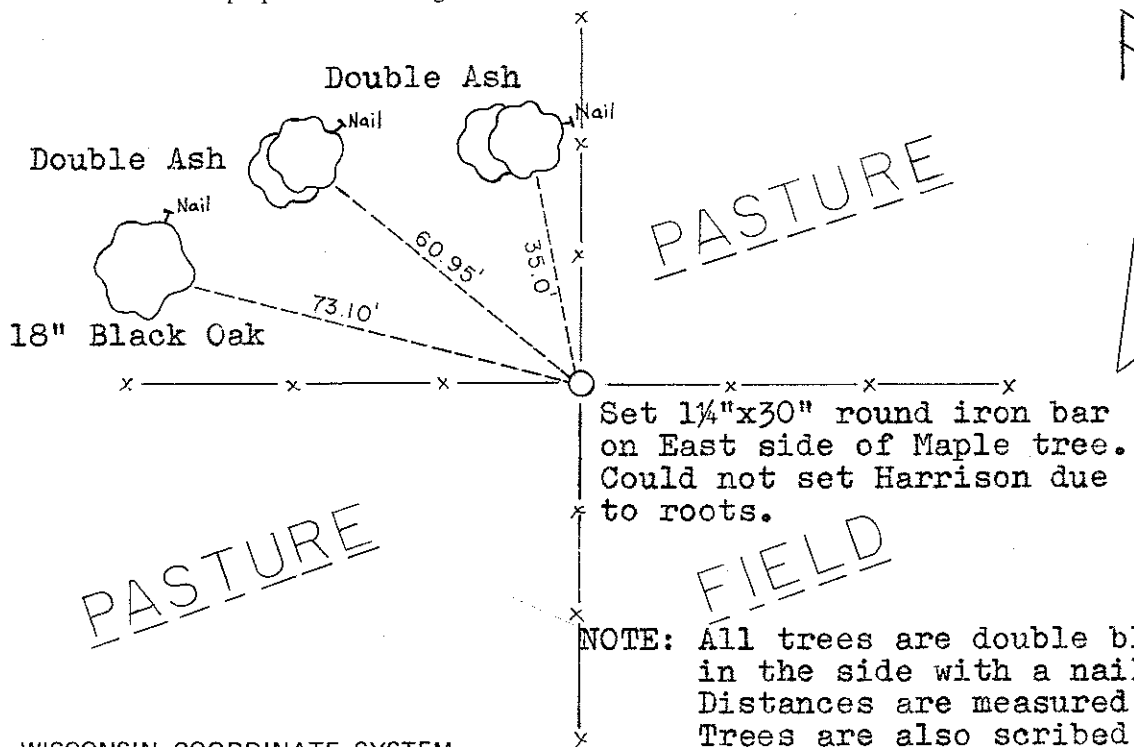

Set 1 1/4"x30" round iron bar on East side of Maple tree. Could not set Harrison due to roots.

NOTE: All trees are double blazed. They are also hacked in the side with a nail set in the hack mark. Distances are measured direct from corner to nails. Trees are also scribed.

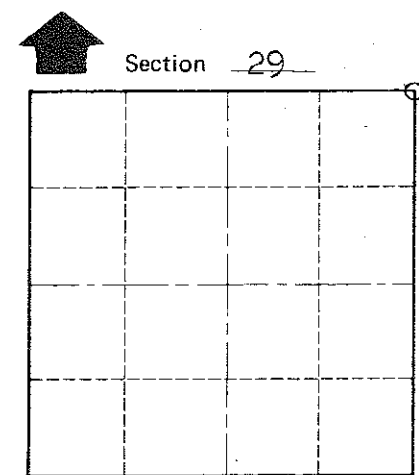

O = LOCATION CORNER
T 15 N R 1 E
WISCONSIN

SURVEY CONTROL ORDER

Horizontal	_____
Vertical	_____

WISCONSIN COORDINATE SYSTEM

Corner	East (X)	North (Y)	Elevation (Z)	Zone
Control Sta. Name				

~~City, Village or~~ Town of Glendale

County of Monroe