

41501152020

I, William C. Jung, do hereby certify that on the 10th day of August 1981, I found (evidence) ~~no evidence~~ of the Center 1/4 corner of Section 15, T 15 N, R 1 E Fourth Principal Meridian, and I re-established said corner according to the Wisconsin Statutes as shown and described hereon.

Dated this 28th day of August 1981.

William C. Jung

Registered Land Surveyor
Title

William C. Jung

Description of corner and witness monuments, references and accessories used to perpetuate the original or re-established location of this corner:

Witnesses to corner location:

Jung

Meyer

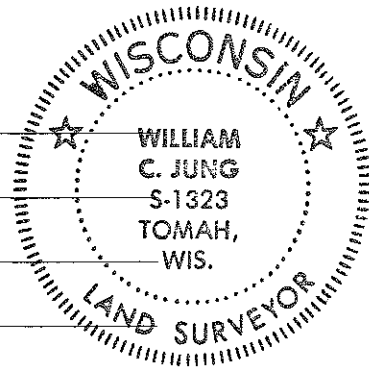

Approved: **HARLEY A. SIME**
MONROE CO. SURVEYOR

History of corner establishment since Original Government Survey

O. R. Dahl found an existing corner at the Center 1/4 corner in July of 1868.

Description of corner evidence found:

Found iron bar set by Feddersen. Iron bar was set over an existing corner. Feddersen excavated at this corner and found the remains of what he felt was an old corner. This point is now at an irregular Center 1/4 corner location.

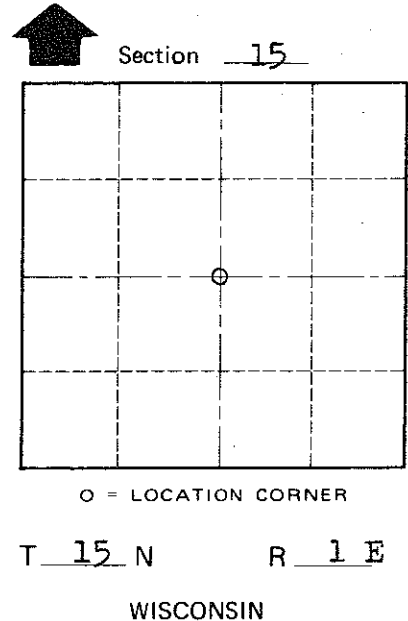
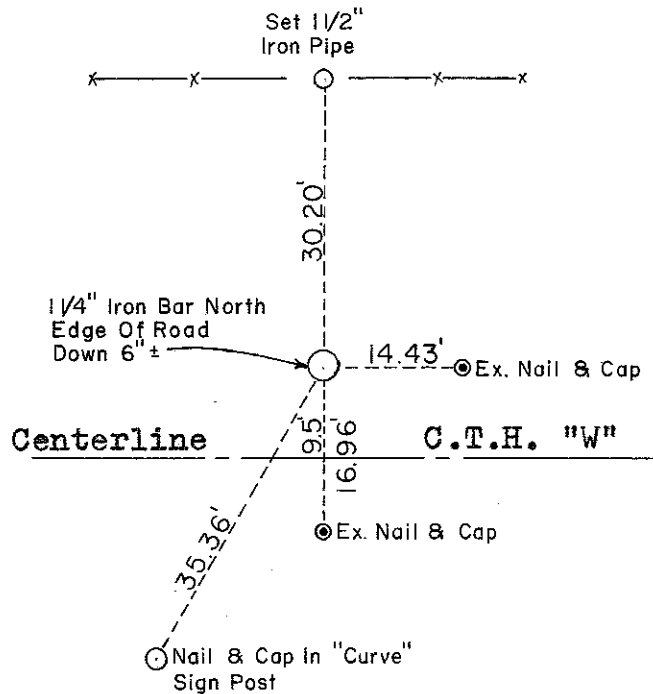

COUNTY SURVEYOR FORM NO. 1

SURVEY CONTROL ORDER

Horizontal	_____
Vertical	_____

WISCONSIN COORDINATE SYSTEM

Corner	East (X)	North (Y)	Elevation (Z)	Zone
Control Sta. Name				

~~City, Village or~~ Town Glendale
County of Monroe
Wisconsin