

# 17 B

**U.S. PUBLIC LAND CORNER  
MAINTENANCE**

**Corner ID : C1/4 Sec.3, T15N-R1E**

**41501032020**

<u>DATE</u>	<u>CREW</u>	<u>MONUMENT TYPE -----</u>
April 5, 2017	Zachariah P.Dechant Gary L. Dechant	Existing 1 1/4" hexagon iron bar, 28' west of stream 27' north of Lumber Ave., set sign 2' north 11' east of north-south fence

<u>References:</u>	<u>Bearing</u>	<u>Distance</u>
1) Set 3/4"x24" round iron bar, down 6"	N8E	13.53'
2) Set 3/4"x24" round iron bar, down 6", 11' west of stream, east side of field entrance	S41E	65.18'
3) Existing 1" iron pipe on forty line, west side of wood post	South	62.71'
4) Set 3/4"x24"round iron bar, down 6", 10 west of fence	West	20.02'



41501032020

I, Harley A. Sime, do hereby certify that on the 30th day of July 1981, I found ~~(evidence)~~ (no evidence) of the C/4 corner of Section 3, T. 15 N, R. 1 E Fourth Principal Meridian, and I re-established said corner according to the Wisconsin Statutes as shown and described hereon.

Dated this 7th day of August 1981.

Harley A. Sime, R.L.S. 355

County Surveyor  
Title

History of corner establishment since Original Government Survey

None

Description of corner evidence found:

Set as per law, intersecting N-S and E-W quarter lines.

See Reverse Side For Maintenance

COUNTY SURVEYOR FORM NO. 1

Description of corner and witness monuments, references and accessories used to perpetuate the original or re-established location of this corner:

Witnesses to corner location:

G. Dechant

B. Meyer

C. Pietz

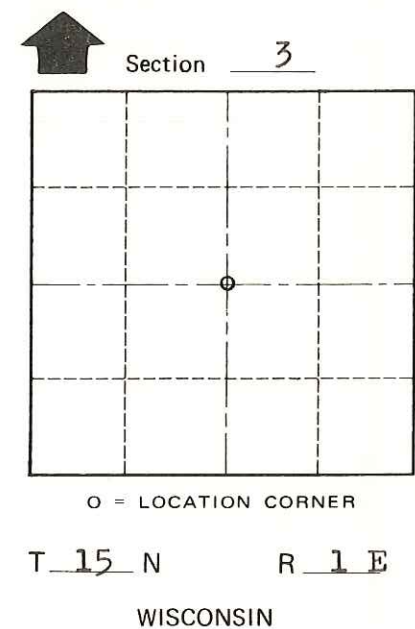
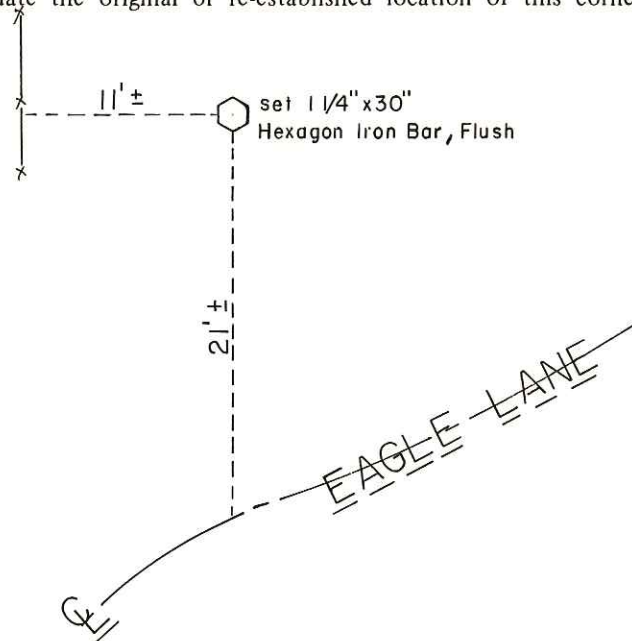

Approved: **HARLEY A. SIME**  
**MONROE CO. SURVEYOR**

SURVEY CONTROL ORDER

Horizontal	_____
Vertical	_____

WISCONSIN COORDINATE SYSTEM

Corner	East (X)	North (Y)	Elevation (Z)	Zone
Control Sta. Name				

~~City Village~~ Town Glendale  
County of Monroe