

41501032000

I, Harley A. Sime, do hereby certify that on the 30th day of July 1981, I found (evidence) ~~(no evidence)~~ of the E $\frac{1}{4}$ corner of Section 3, T15 N, R 1 E Fourth Principal Meridian, and I re-established said corner according to the Wisconsin Statutes as shown and described hereon.

History of corner establishment since Original Government Survey

No known recorded history since the original government survey.

Description of corner evidence found:

Accepted fence corner as best available evidence as it also fits other field evidence well.

Dated this 5th day of August 1981.

Harley A. Sime, R.L.S. 355

County Surveyor

COUNTY SURVEYOR FORM NO. 1

Description of corner and witness monuments, references and accessories used to perpetuate the original or re-established location of this corner:

Witnesses to corner location:

G. Dechant

C. Pietz

B. Meyer



Set Harrison Monument up 1"

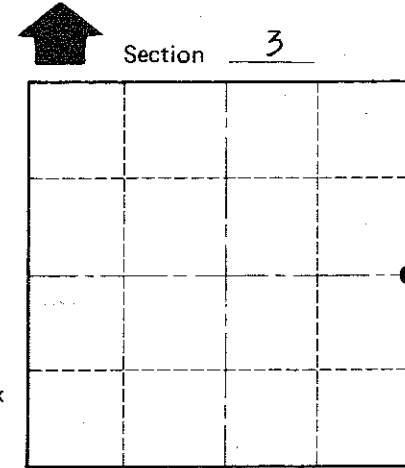
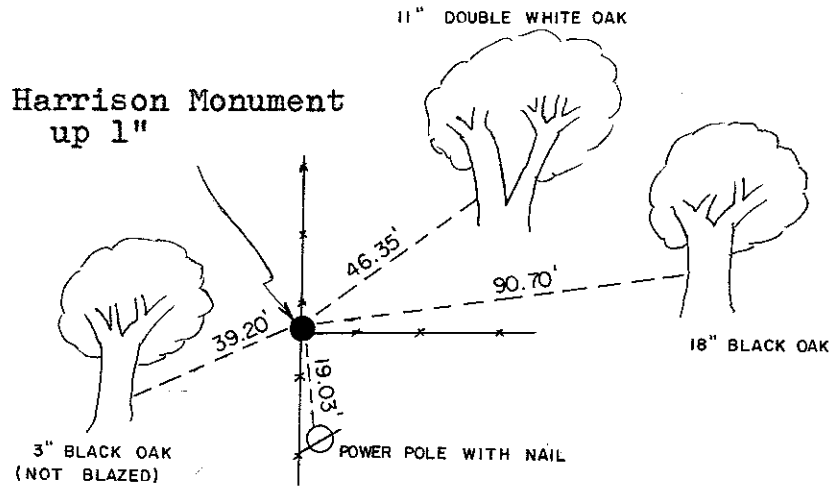

● = LOCATION CORNER

T 15 N R 1 E

WISCONSIN

(All trees doubleblazed with nails set)

**Approved: HARLEY A. SIME
MONROE CO. SURVEYOR**

SURVEY CONTROL ORDER

Horizontal	_____
Vertical	_____

WISCONSIN COORDINATE SYSTEM

Corner	East (X)	North (Y)	Elevation (Z)	Zone
Control Sta. Name				

~~City, Village or~~ Town Glendale
County of Monroe