

V-1 x

Survey of Public highway in the Town of Little Falls
 Jackson County Wisconsin as surveyed by J. A. Seiber
 of said Town by order of the Supervisors of said Town
 as follows viz commencing at the quarter Stake standing
 between Sections 33 & 34 in Range Five W in said
 Town being also in the W line of said Town and
 being the South West corner of P. Magoons 80 Acres
 of Land thence N 81° E 11 chains to a Stake thence
 S 51° 30' E 4 chains 60 links to a Stake thence South
 67° 20' E 3 chains 50 Lks to a Stake thence North 59°
 40' E 20 chs 15 Lks to a Stake thence N 59° 40'
 E 42 chs 56 Lks to a Stake at the corner of Section
 33 & 34 in said Range thence N 81° E to & on
 the gr Sec E line of Sec 35 also on (Easterly) gr
 Sec line of 36 to the E line of said Sec 36 thence N
 81° E 36 chs to a Stake thence S 76° E 10 chs to a
 Stake thence N 81° E 13 chs to a Stake thence
 N 76° E 10 chs to a Stake thence N 81° E on gr
 Sec E line of Sec 32 in R 4 W 48 chs to a Stake
 thence N 57° E 7 chs to a Stake thence South 86°
 40' E 20 chs to a Stake in the gr Sec E line
 of Sec 33 E of the gr Sec E line Stake 7 chs 22
 Lks thence in said gr Sectional line eastward
 to the gr Sec Stake in the W line of Section 34
 & the E line of Sec 33 40 chs thence Southly to the
 of the County of Jackson to a Stake in the line
 of the County Road.

Said Survey to be the center of the Road highway
 to be four rods wide

Dated at Cataract in
 said County this 25th day of April A.D. 1856

J. A. Seiber Surveyor

A Copy
 J. J. Kashburn
 Town Clerk

Survey of Highway in the Town
 of Little Falls in Jackson County Wis
 was made made by me the undersigned at
 the instance and Order of the Supervisors
 of said Town as follows viz. Commencing at a
 tree in center of Highway also being in the
 S. line of Linn County Jackson (in the old
 Sparta Road so called) thence N 15° 30' W 35
 Chs to a stake thence N 9° W 9 chs 6 fks to
 a stake thence N 10° W 15 Chs 9 fks to a Stake
 thence N 17° E 55 Chs 30 fks to a Stake thence
 N 8° 30' E 24 Chs 16 fks to a Stake thence N
 9° E 6 fks thence N 24° 30' E 5 Chs 24 fks
 thence N 31° 30' E 4 Chs 70 fks thence N 14°
 30' E 62 Chs 57 fks thence N 24° E 16 Chs 15 fks
 thence N 24° E 13 Chs 24 fks thence N 25° E
 9 Chs 82 fks thence N 12° E 12 Chs thence
 19° 30' W 16 Chs 30 fks thence N 11° 20' 10 Chs
 9 fks thence N 24° 30' E 10 Chs thence N
 21° 40' W 13 Chs 5 fks thence N 30° 30' W 9 Chs
 20 fks thence N 38° W 11 Chs 8 fks thence 22
 W 11 Chs 15 fks thence 9° 40' W 11 Chs 61 fks
 thence N 8° W 18 Chs 9 fks to a Stake in the
 Black R Road thence N 9° W 5 Chs 36 fks
 thence 9° 30' W 11 Chs 35 fks thence N 17° W
 13 Chs 5 fks thence N 18° 45' W 8 Chs 17 fks
 thence N 49° 30' W 8 Chs 56 fks thence N
 50° W 10 Chs 7 fks to a White Oak tree mar-
 ked H in the line between Secs 4 & 9 in
 R 4 W in said Town said Survey to be
 center line of 4 Rods Highway

Dated at Cataract in the
 County aforesaid this 28th day of April
 A.D. 1856.

A Copy
 of F. Nathans
 Thumblers

J. A. Seiber Surveyor

v-lx

Survey of Highway in the Town
 of Little Falls in Jackson County Wis. as
 by me the undersigned at the instance & order
 of the Supervisor of Said Town as follows viz
 Commencing at a Sectional Stake in the
 E line of Said Town between Sects. 24 & 25
 Thence Westaly on Said Sec line of 24, 25 & 23
 to a stake 10 chs Westaly from Sec corner Thence
 N 77° 20' W 6 chs 20 Lks to a tree marked Thence
 S 60° W 5 chs 78 Lks to a Stake in Section line
 of 23 & 26 Thence Westaly in Said Section line
 19 chs 30 Lks Thence Still on westerly on Said line
 20 chs Thence S 36° 45' W 22 chs 34 Lks Thence
 S 46° 20' W 42 chs Thence Westaly to a Stake
 in the center of the East End of Bluff Pt
 in the Village of Cataract Said Survey to
 be center line of four rods Highway

Dated at Cataract this 1st day of May A.D. 1856

J. A. Seiber
 Surveyor

ci Copy
 J. H. Rathbun Town Clk

Survey of Highway in the Town
 of Little Falls in Jackson County Wis
 as made by me the undersigned at the instance
 and Order of the Supervisors of Said Town
 viz Commencing at a Stake 19 chs 86 Lks E
 of the Gr Sec Stake & in the north line of Sec
 2 in R 4 W in S 4 Town being also in the
 north line of said Town Thence S 25° E 7 chs
 near Ft Marns Thence S 18° W 6 chs 44 Lks
 Thence S 10° 35' E 3 chs Thence S 14° E 17 chs 42
 Lks Thence S 15° E 11 chs 70 Lks Thence S 15° W
 28 chs Thence S 10° 30' W 23 chs 64 Lks Thence S
 14° W 19 chs 50 Lks Thence S 10° 20' W 8 chs 36
 Lks Thence S Easterly 21 chs 38 Lks Thence S 8°
 W 22 chs 22 Lks Thence S 2° 30' E 13 chs 53 Lks
 Thence S 6° 50' E 10 chs 72 Lks Thence S 3° 35' E
 11 chs 6 Lks Thence S 57° 30' E 14 chs 12 Lks Thence
 S 48° 25' E 4 chs 12 Lks Thence S 79° 30' W 9
 chs 6 Lks Thence S 75° E 11 chs 52 Lks Thence S
 57° 20' E 12 chs 50 Lks Thence S 54° 12 chs 54 Lks
 Thence S 45° E 12 chs 48 Lks Thence S 43° E
 6 chs 74 Lks Thence S 34° 30' E 28 chs 75 Lks
 to a Stake in the Gr Sec line 20 chs East of
 the Gr Sec corner of Stake Thence Southerly on
 the E line of Pomeroy's E 80 Acres also being the
 W line Harbert's 80 Acres to S E corner Stake
 of Sd Pomeroy's land Thence S 40° W 8 chs 76
 Lks Thence S 43° 30' 17 chs 48 Lks to a stake
 in the E line of Section 23 in Range 4 W
 Thence Southerly on Gr Sec E line on the
 Dustin E Sec line also on Dunley's E line
 to the NE corner of H Seeby's Gr Section
 Stake Thence on said E line 17 chs Thence
 South 27° 30' W 5 chs Thence S 33° W 40 chs
 80 Lks Thence S 19° 30' W 9 chs 6 Lks Thence
 S 19° 30' W 7 chs 76 Lks Thence S 19° E 6 chs
 76 Lks Thence S 19° E 5 chs 12 Lks Thence
 S 10° 20' W 6 chs 12 Lks Thence S 18° 25' W

V-1

14 chs 50 Lks thence S 22° W 8 chs 60 Lks thence
 S 10° E 11 chs 4 Lks to a stake in the corner
 line also being the S W S W Stake of the 135
 in R A W Aforesaid Survey being the center
 line & said Highway to be 4 Rods wide
 Dated at Cataract this 2nd day of
 May A D 1856

S. A. Seiber
 Surveyor

At a meeting of the board of Supervisors of the
 Town of Spittle Falls May 2nd 1856 it was Resolved that
 above Road Surveys be adopted

A Copy
 S. F. Washburn
 Town Clerk

Wm. B. Buntin
 J. H. Stewart
 A. S. Perkins } Supervisors

V-1

State of Wisconsin }
 County of Jackson } Town of Little Falls

Surveyed June 30th 1856.
 by direction of the Town Board of the Town of
 Little Falls the Cataract and Sparta Road the
 same being situated in Township 19 N of Range
 4 West of 4th Meridian Commenced at at the
 1/4 Stake between Section 27 & 24 and runs as
 follows

Station	Bearing	Dist	R F	Bearing	Dis	Stks
1	East on Section line	49	Rods			
2	S 37° E	186	Rods	S 36° W	30	
3	S 52° E	44	Rods	S 12° W	39	
4	S 25° E	36	Rods	N 75° W	34	
5	S 14° E	54	Rods	N 76° W	35	14 Rods to Creek Small Cold Banks
6	S 24° E	82	"	S 52° W	34	
7	intersects the County line					

J. G. Wabath Alvin Walker Chairman
 J. W. Wabath Examiner

Examined and approved by Surveyor
 W. W. Bentow Justice of the Peace
 Variation of Needle 8° 30' E

Plot of Cataract & Sparta Road Town Little Falls

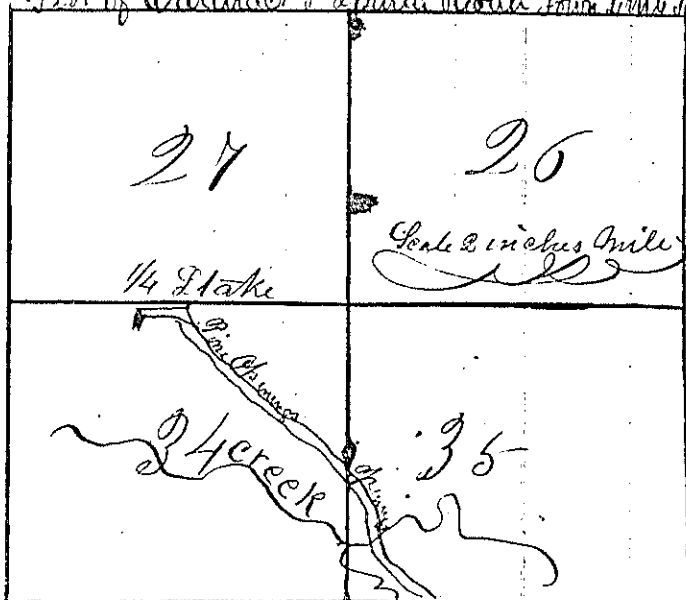

A. Coffey
 J. F. Rathbun
 Town Clerks

The Town 4 rods

Note the bearings are given from the center of the road
 4 Rods Each way making 4 Rods width

Plot of Cataract Road North from Little Falls

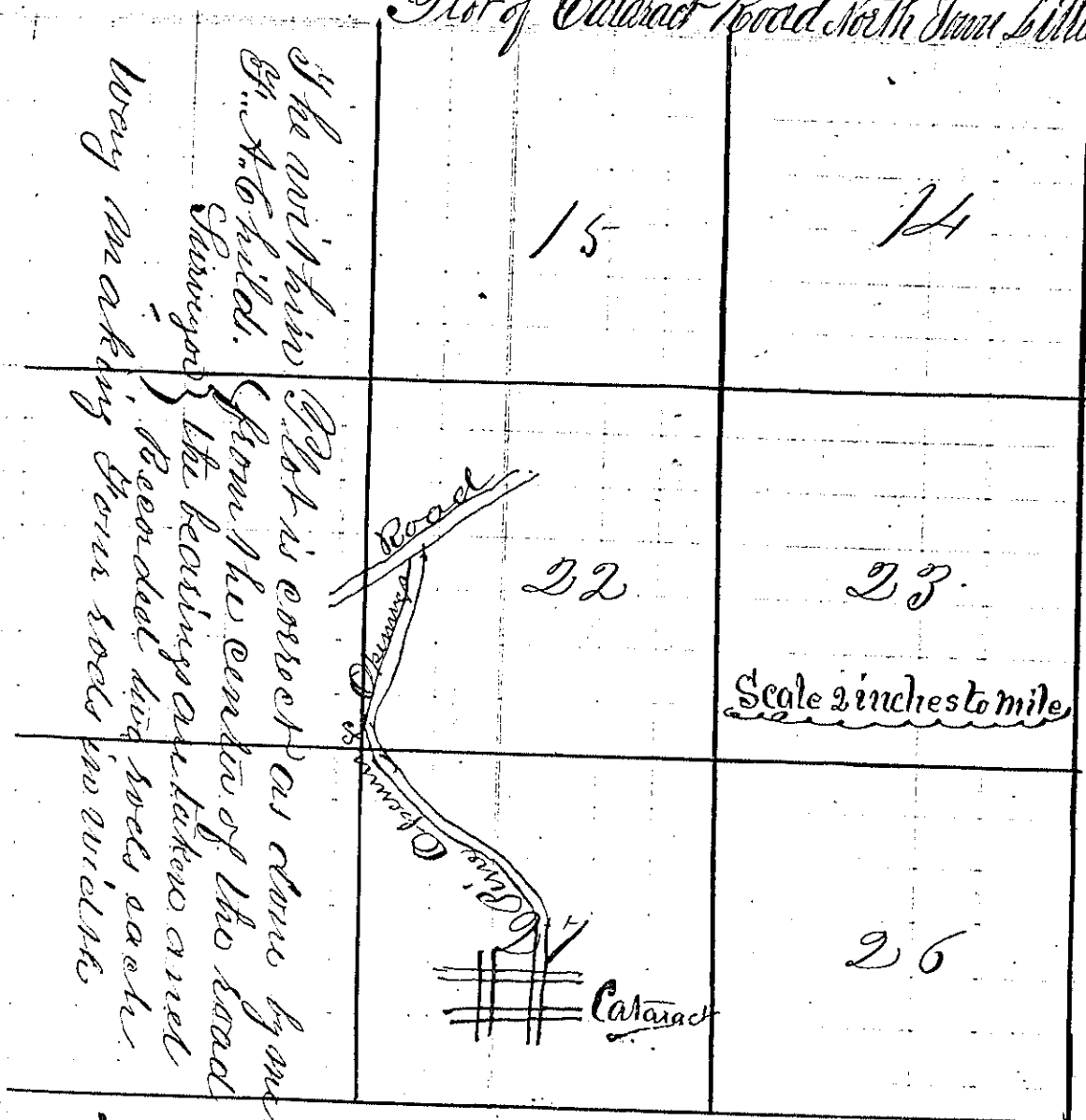

of the north line
 E. N. 60 W. 100 ft.
 (from the center of the road
 the bearings are taken and
 recorded here each
 way making them both in circles)

State of Wisconsin }
 County of Jackson }

Survey July 1st, 1856 by direction
 of the Town Board of the town of Little

Falls the Cataract Road north the same being situated in
 Township 19 N of Range 4 west of 4th Principal Meridian
 Commencing at north end of Black River Street in the
 Village of Cataract and runs as follows

- 1 N 35° W 42 Rods - N 67 E 75 chs
- 2 N 51° W 36 " N 65 E 10 "
- 3 N 26° W 110 " N 44 E 9 "
- 4 N 34° W 45 " S 46 E 25 "
- 5 N 2° E 184 " intersect Road.

A. L. Skinner & S. C. Cooley Chy
 sworn by Benton Justice of Peace
 the Clerk & Surveyor

H. A. Childs
 Surveyor

Variation 8° 30' East

Copy
 J. H. Northon Town Clerk

Cataract Road West

V-1

Town of Little Falls Surveyed July 2nd 1856 by directions of the Town board of the Town of Little Falls the Cataract Road West commencing at the 1/4 stake between Section 27 & 34 West 37 Rods to Creek very Bold Banks

West to Section corner near 27. 28. 33. 34

West 59 Rods to Bank

- (2) N 58° W dis 12 Rods B.Y. P 36° W 35 Links 13 1/2 ^{cross}
- (3) N 83° W " 26 " N 64° E 15 "
- (4) S 51° W " 13 " Section N 17° W 42
- (5) West " 34 1/2 " 1/4 Stake
- (6) " One Mile to " 1/4 "
- (7) " 1/2 Mile Section corner
- (8) S 64° W 30 Rods B.Y. N 14° E 56 Links
- (9) S 42° W 42 " " N 10° W 14 "
- (10) S 51° W 38 " " S 50° E 10 "
- (11) S 34° W 22 " " N 86° W 17 "
- (12) S 20° W 77 intersect Road

A. Skinner & P. Ann Charman
 To H. S. Hubert Oxen
 Varied 8° East Proven by Benton & P

G. A. Childs
 Surveyor



NO WIDTH GIVEN

Map of Cataract Road and Town of Little Falls, Wis.

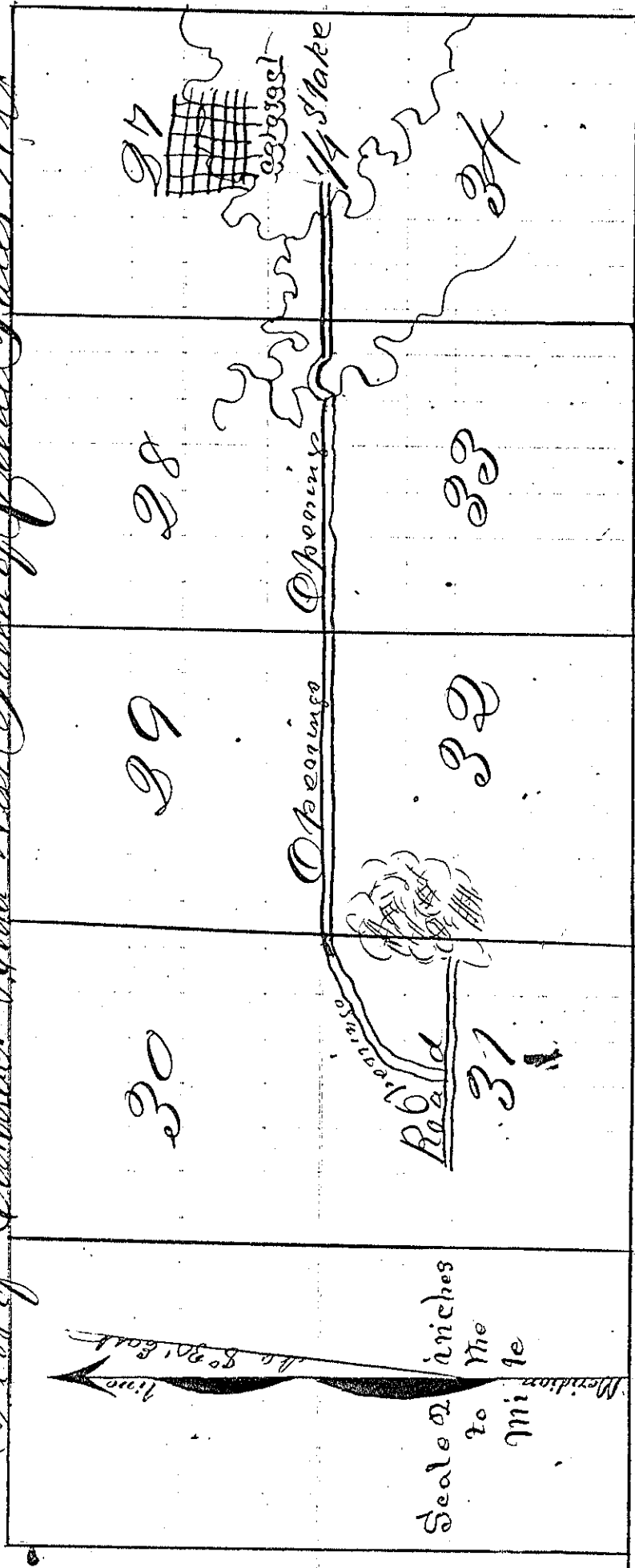

The within Plot is correct as done by me. E. A. Childs Surveyor

Road Survey made by me the undersigned
 Surveyor this 24 day of April 1857 at the
 request of the Supervisors of the Town of Little
 Falls as follows Commencing in the South
 end of and West line of Mountain ^{Extension} ~~the~~
 South $8^{\circ} 20'$ East 231 feet to the centre of
 Burnam Street also at the request of
 said Board Surveyed the Black River
 Extension. It Commencing in the South
 end and east side of Black River
 It South $8^{\circ} 20'$ East 236 feet to a stake
 in the centre of Burnam Street.

A Copy by
 J. F. Rathbun
 Town Clerk

J. A. Galt
 Surveyor

Survey made by me the undersigned at the request of the Supervisors of the Town of Little Falls Monroe County Wis this Twenty Eighth day of April 1857 First commencing at a stake standing in north line of Mill Street about five rods east from the Pope Mill Pond Bridge thence running S. 42° 30' W 27 chs 10 Lks to a stake in the North & South line between lands of P. C. Walker and A. D. Populhance thence running on said line 27 chs 45 Lks to a stake in the centre of the Survey for the Spencer and Brown road thence South 31° W 31 chs to a stake on line of Section 23 in said thence South 45° W 23 chs 33 Lks to a stake thence S 35° W 12 chs 33 Lks to a stake thence S 20° 20' W 4 chs 18 Lks thence South 14° W 21 chs 84 Lks to a stake in the old Black River Road (so called) said road to be four rods wide

J. A. Sabin Surveyor

Who surveyed as above the following for a private road ten feet three rods wide commencing at a stake standing in the W line of the R River road also in line of W part of Cans land thence running South 82° W 13.83 to a stake at the corner stake of Field Case part of Tubbs land on said Twenty Eighth day of April 1857

A Copy by
J. A. Sabin
Town Clerk

J. A. Sabin Surveyor

No 3

M

It is hereby ordered and determined by the Board of Supervisors of the County of Little Falls that the following described Road be laid and established as a public Highway and by Law provided
 Little Falls June 3rd 1871

A. Rinzer
 J. A. Atkinson
 Tho. Matthews } Board of Supervisors

Said Road commences at a point on Black River 162 links S 55th W 1/4 of North Quarter 2nd & takes or Meander State on the south line of Section (6) Towns 19 North R. 4 West of the 4th Tier and runs thence as follows

No of Course	Bearing	Dist. Ch.	Dist. Miles	Angle	True Bearing	Distance Rods
1	S 49 th E	820		W oak 6	N 40 th W	62
2	N 88 1/4 E	873		S Pine 12	N 70 th W	30
3	S 53 3/4 E	2483		S Oak 10	N 19 1/2 W	24
				B oak 12	S 30 th W	31
4	S 33 rd 5' East	741		W oak	S 6 1/2 E	30
5	S 13 th W	1692		W oak 6	S 58 th E	24
6	S 23 1/4 W	1110		B oak 12	N 81 th W	31
6	S 22 1/4 W	1110		W oak 12	S 29 th E	30
7	S 9 W	147		W oak 12	S 43 1/2 W	17
8	S 38 1/2 E	1019		B oak 6	N 85 th W	70
9	S 49 th 25' E	3592		B oak 10	S 26 3/4 W	63
				B oak 10	N 35 th East	71
10	S 44 th E	1783		W oak 14	N 67 th W	40
11	S 53 rd 10' E	2066		B oak 12	S 85 1/2 E	100
12	S 29 th 35' E	3206		B oak 4	N 88 1/2 E	32
13	S 40 th E	1235		B oak 8	N 63 th W	53
14	S 7 1/2 E	703		B oak 4	N 73 3/4 W	45 1/2
15	S 27 3/4	1247		B oak 6	S 13 1/2 E	34

1992
 Chs. Corns
 of Section
 5-6-7-8

Carried to next Page

X

V-1

No of Courses	Bearings	Dist. Miles	Angle	Remarks
15	S 54° 3' E	4.14		Corner of Section 8.9.16-17
17	S 22 1/2° East	26.60?		9 Pine 6 S 61 1/2° E 44
18	S 24 3/4° E	4.00		9 Pine 4 N 75° W 19
18	S 34 3/4° E	11.00		9 Pine 12 S 49° W 44
19	S 25° 10' E	35.32		11 Oak 12 N 61 3/4° W 31
20	S 29° E	13.71	To op	Stake on North Side 21 (No 4 R to W)
21	South on Op line	11.56		11 Oak 14 S 46° W 35
				11 Oak 14 N 21 1/4° West 28
22	S 4 1/4° E	23.40		11 Oak 14 N 3° E 57
23	S 46° 35' E	15.26		11 Oak 10 N 19° W 52
				11 Oak 10 N 37° E 54
24	East on	13.17		To 14 Stake on E Side Sec 21 (No 3 2 to D)
Total		5.00 Miles		

I do hereby certify that the above field notes and plat are true and correct of a survey made by me on the 3rd of June 1859 by directions of the Board of Supervisors of the town of Little Falls, Monroe Co. Wisconsin

C. C. Miller
County Surveyor

S. H. Harman }
M. D. Atchinson } Ch.
Harrison Atchinson } Flazman

Plat on
the next page

Copy by J. L. Rathbun
Town Clerk

V-1

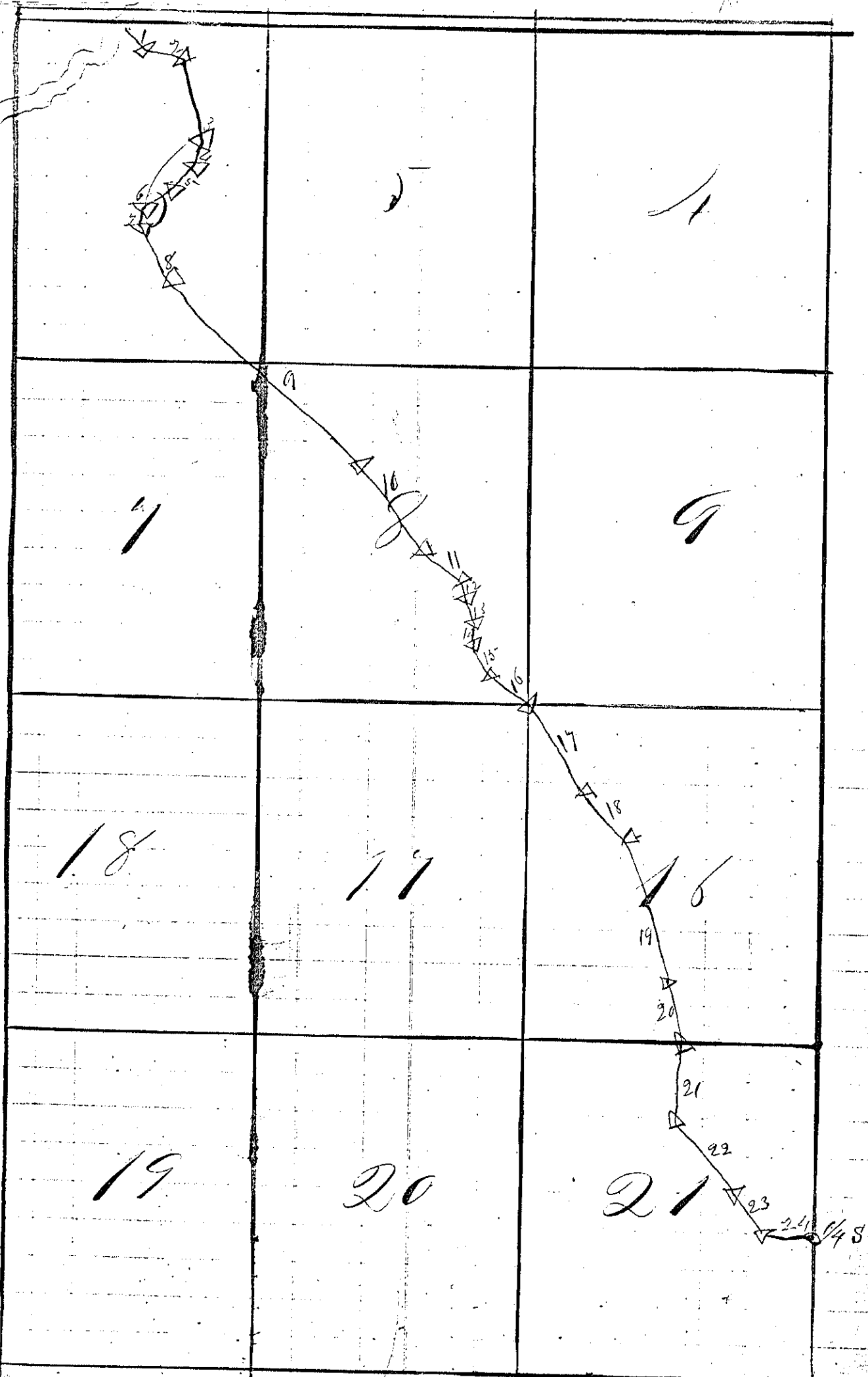

Road Privy No. 1 V-1

It is hereby ordered and determined by the Board of Supervisors of the Town of Little Falls in the county of Monroe and State of Wisconsin that the following described Road be laid and established as a public highway as by law provided. Little Falls June 29th 1887

A Ringier } Board of Supervisors

Var of Needle 8 1/2° East

Said road commences at a point 232 chains N 27 1/2° W of an 1/8 Stake on the west 1/2 of South Section line of Section No Thirteen (13) Township No 19 N of Range No 4 West of the 4 Meridian the same being a point of intersection with a Town road running North and South and runs thence N 49 3/4° E 37.23 chains to an 1/8 Stake on the South half (S 1/2) of N 1/2 S 1/4 line thence S 89° E on 1/8 line 39.72 chains to East Section line of said Section 13 T 19 R 4 W

I hereby certify that the above filed notes and plat are true and correct of a Survey made by me on the 26th day of June 1887 by direction of the board of Supervisors of the Town of Little Falls Monroe Co Wisconsin.

A copy by J. F. Rathbun County Clerk

C. C. Miller County Engineer
J 19 18 4 W

D. H. Miller } Chairman
A. Johnson }
A. Burges } Assessor

NO WIDTH GIVEN

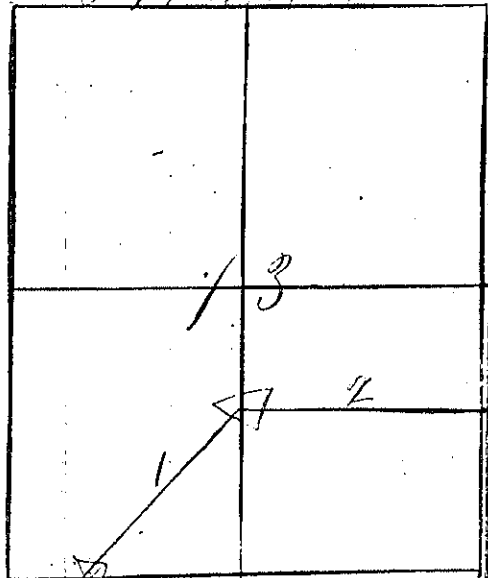

Road Survey No 3

r-1

It is hereby ordered and determined by the Board of Supervisors of the Town of Little Falls that the following described Road be laid and Established as a Public Highway as by Law Provided

Little Falls July 1839
A Ringed

} Board of Supervisors

Said road Commences at a point on west side of Section Seven (7) on Township line between T 19 N of R 4 S West 13.53 chains North of South West corner of Said Section Seven (7) and runs thence South on Township line to a point 33.33 chains South of the west 1/4 stake of Section (7) E (marked by) in T 18 N of R 4 West of 4th Mer Angle trees at com-) Br oak | 4 | S 83 1/2° E | 24
mencement of line an) Br oak | 6 | S 36° E | 38

Angle trees at end) Br Oak | 6 | N 60° W | 33
of line an) Br Oak | 37 | S 36° E | 46

Length of Road 5 1/4 miles

I hereby certify that the above field notes and plat are true and correct as a Survey made by me on the 27th of June 1839 by directions of the Joint Board of Supervisors of Little Falls and Bristol.

Wm A Thomas } Chairman
V McManus }
David Little } Assessor

C L Miller
County Surveyor

NO WIDTH GIVEN

Plat on ~~next~~ Page 178

v-1

X

T' 19 N R 5 W
12

T' 19 N R 4 W
7

13

28

24

19

25

30

T' 18 R 5 W

T' 18 N R 4 W

36

31

7

6

18

Survey No 6

It is hereby ordered and determined by the Board of Supervisors of the Town of Little Falls Monroe Co Wis that the following road be laid and established a public highway as by Law provided

Little Falls July 1859

A Ringev) Board of Supervisors

Said Road commences at a point on a State road running from Sparta to Black River Falls; 4.82 Chains West of an 1/4 Stake on the South half (S 1/2) of North and South quarter line in Section Four (4) T 18 N; R 4 West of 4th Meridian and runs thence as follows

Var of a Needle 8° 30' East

No of Courses	Bearings	Dis in Chains	Dis in Miles	Angle in Degrees	Bearings	Dis	Rem
1	S 89 1/2 W	50.69	G. P. Ringev	Back 8	N 82 1/4 E	185	
				Back 6	N 24 1/2 E	90	
				Spine 12	S 85 W	40	35-61 at 1/2 line
2	N 54 W	60.00		Back 5	N 30 E	26	on line 2 1/2
				Back 12	S 6 1/2 W	131	
3	N 40 W	22.00		Back 14	S 45 1/2 W	160	
				Back 12	N 28 E	30	
				Back 10	N 44 1/2 E	55	

Intersecting a road from Sparta to Birchham Valley 5-47 Chains N 13 1/4 W from North west corner of Section five T 18 N R 4 West

Jepo Beallev) Charman

V-1

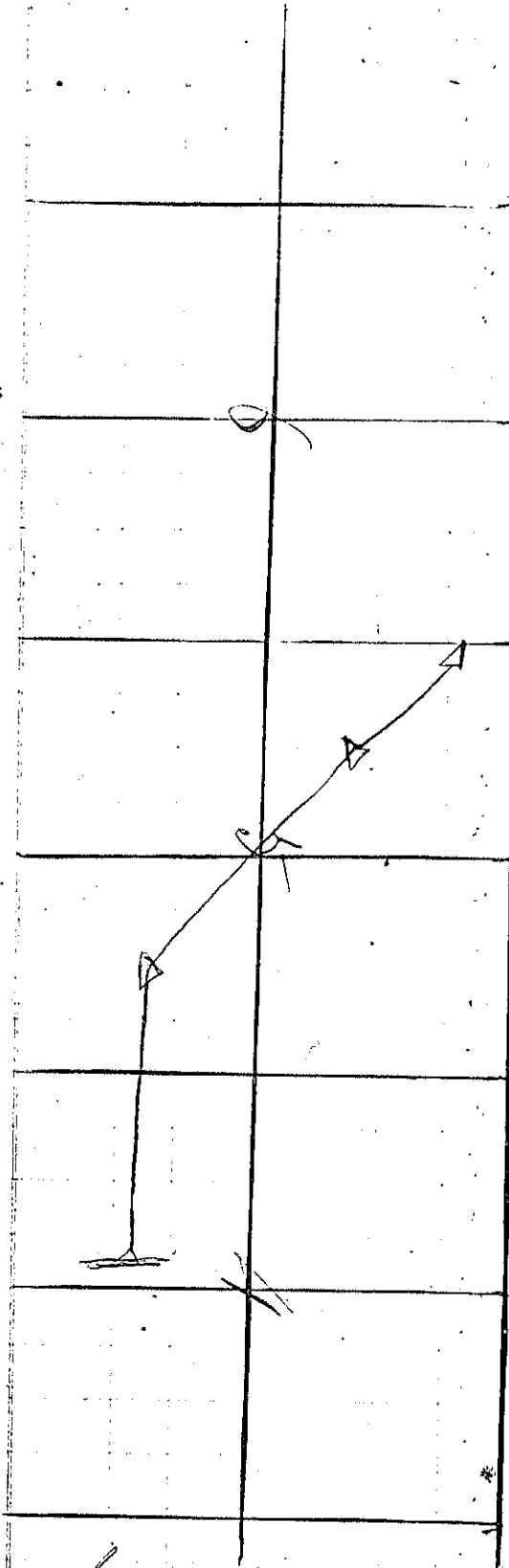

From 18 of 18 to E. A. Mill

may
ed

30

W.S.M

I do hereby certify that the above field notes
 and plat are true and correct of a Survey
 made by me on the 29th of June 1857
 by direction of the Board of Supervisors
 of the Town of Little Falls

L. S. Miller
 County Surveyor

A Copy By J. H. Rathbone
 Town Clerk

No 3

1-1

up
Town of Little Falls
County of Monroe

At a meeting of the Supervisors of the said Town of Little Falls on the day of _____ A.D. 1857 a majority of the said Supervisors having met agreeable to notice and having examined and deliberated upon the subject matter embraced in this order it is here by ordered and determined that a highway four rods wide be laid out in said town the center line of which according to actual survey thereof which the said Supervisors has caused to be made commences at a point 25.86 chains North of the North West corner of Section 19 T 19 N of R 4 W and runs thence as follows.

No of courses	Bearings	Distance in chains	Angle Trees	Dist	Bearings	Dis	var of Needle 8 1/2 E
1	S 46° 40' E	30.00	B Oak 13 W oak 12	13	N 67° E	63	
2	S 69° E	17.00	B oak 12 No trees	12	N 22° E	29	
3	S 89 3/4° E on the line	60.00	No trees (near 45.65 to Section Corner)	2	S 53 3/4° W	33	57 2 1/4 S 7 E
4	S 20° E	7.10	No trees (near				
5	S 27° 25' E	27.26	No trees (near				
6	East on the line	86.00	(To corner 50 chains S of Sec 28)	10	S 69° 41'	34	40 3/4 of Sec 29 Sunk 6 of Section 28
7	N 30 1/2° E	17.10	Plain	6	N 34 1/2° W	36 1/2	At Sec line
8	S 77 1/2° E	31.54	B oak 6	6	S 2 1/2° E	36	
9	S 38 1/2° E	13.00	W oak 8	8	N 27° E	33	
10	S 48° 25' E	10.53	B oak 6	6	N 61° W	27	
11	N 89 3/4° E	20.86	To the intersection of Jackson and Main Street in the Village of Cataract				
		331.05					

Wm D. Matthews
Almon Washburn

V-1

The Witness Whereof we have hereunto
set our hands

Thomas Matthews)
B. P. Alcherson) Board
A. Pinger) Supervisors

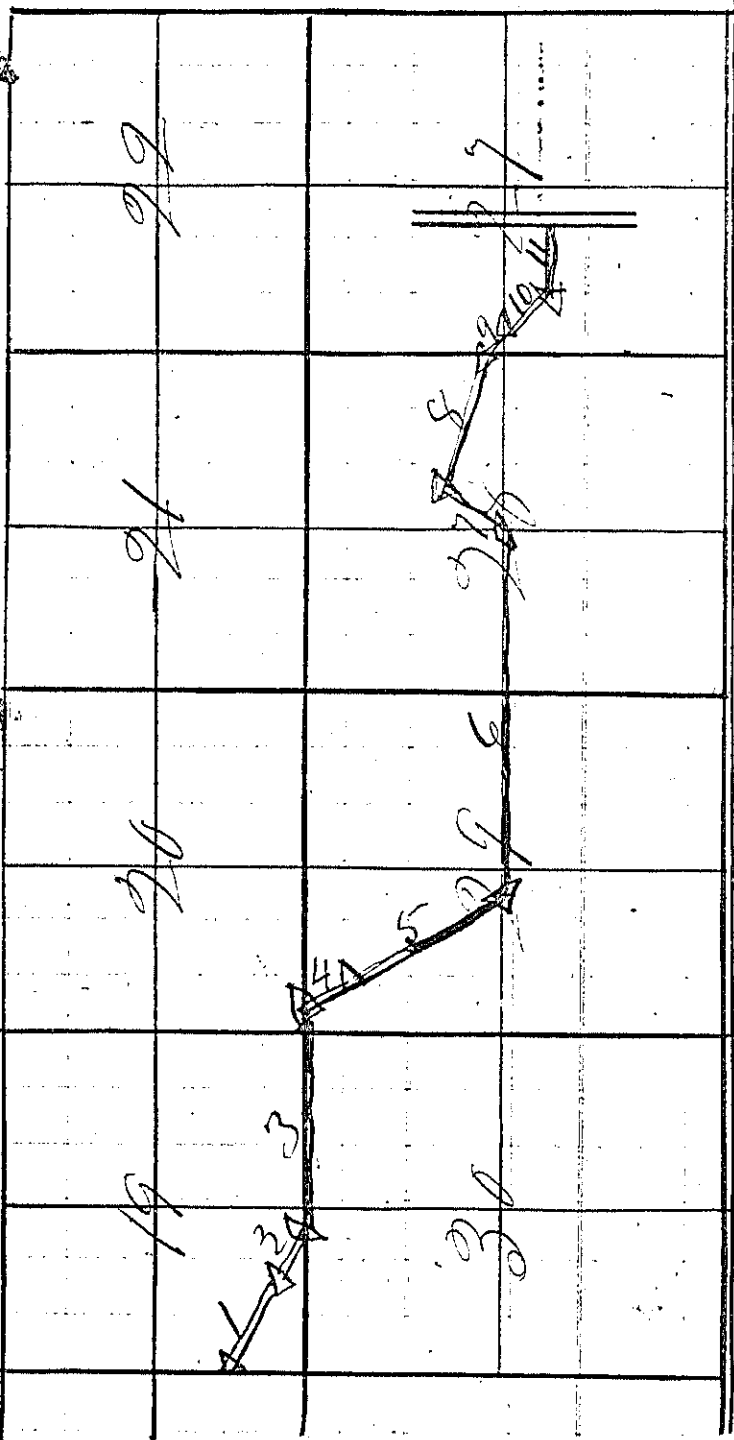

I hereby certify that the field notes and
plat incorporated in the above order are correct
of a survey made by me on the 23rd day
of October A.D. 1887 by directions of I feel
Boquard of Supervisors of the Town of South
Fall
W. B. Miller

A Copy of the
Original by J. A. Rathbun
Town Clerk

No 6

County of Monroe }
 Town of Little Falls } ss

At a meeting of the Supervisors of the said town of Little Falls on the day of AD 1857 a majority of the said Supervisors having met agreeable to notice and having examined and deliberated upon the subject matter embraced in this order it is hereby ordered and determined that a highway four rods wide be laid out in said town the center line of which according to actual survey shall which the said Supervisors have caused to be made commences at the East corner of Sec one (marked P) in T 18 N of R 4 west and runs thence as follows

Var & Meas 8 1/2 E

No of Course	Bearings	Dist in Chains	Angle	Trees	Bearings	Dist
1	West on line	15.00				
2	N 14° 30' W	10.06	Brook	8	S 39 1/2° W	135
3	N 33° 3' W	13.00	9 Pine	10	N 59 1/2° E	67
			Boats	10	N 65 1/2° W	87
4	N 15° 50' W	24.77	9 Pine	10	S 22 1/2° W	125
			This point is 345 Ch west of N 1/4 Sec 1			
5	West on Sec line	13.11	Brook	6	S 31° E	16
			Brook	6	N 18° W	13
			Corner 1, 2, 3, 5, 36			
6	N 76° 25' W	12.00	Brook	6	N 50 1/2° W	10
7	S 70 1/2° W	7.77	Brook	6	N 27° W	89 1/2
8	West on Sec line	16.36	to 1/4 State and 3 Lie Sec 35 T 19 N R 4 W			
9	S 18.10° W	2.42	9 Pine	8	S 18 3/4° E	92
10	N 64.20° W	3.64	9 Pine	8	S 14° W	37
			Woot	10	N 54 3/4° E	90
11	West on Sec line	12.14	9 Pine	10	S 52 1/2° W	33

15944 Intersect at town road from Cataract to N. part
 John Andrus }
 Charles Walker } Chmn

In witness whereof we have
hereto set our hands

Thomas Mathews) Duared	
B. G. Atkinson) sb
A. Ringler) Supervisors

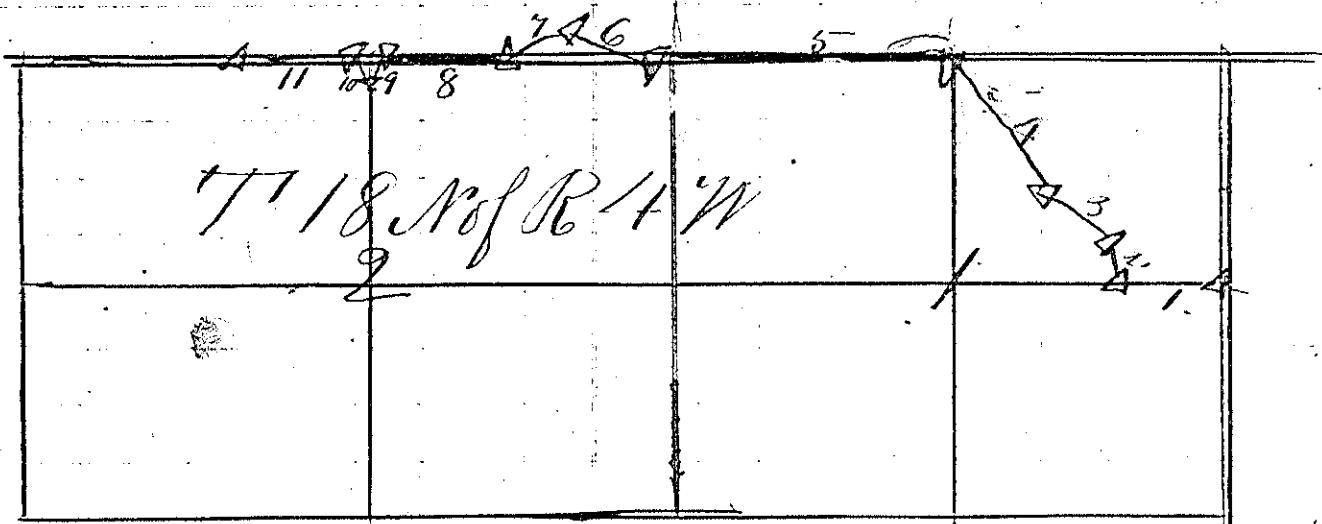

T 18 N of R 4 W

I hereby certify that the filed
notes and plat incorporated in
the above order are correct of a
Survey made by me on the 30th
day of September A.D. 1857 by
direction of the Board of Super-
visors of the Town of Little Falls

C. C. Miller
County Surveyor

No 9

1-1

County of Monroe
Town of Little Falls 53

At a meeting of the Supervisors of the Said Town of Little Falls on the day of _____ A.D. 1857 a meeting of the Said Supervisors having met agreeable to notice and having examined and deliberated upon the subject matter embraced in this order. It is hereby ordered and determined by them that a highway four rods wide be laid out in Said town the center line of which according to actual survey thereof which Said Supervisors have caused to be made commences 20 links East of the North $\frac{1}{4}$ Section of Section one (1) (marked) T 19 North of Range No 4 west and run thence as follows

Run of Needle S 42° E

No of Course	Bearings	Dist in Chs	Dist in Miles	Angle in Dees	Dist Bearings	Dist
1	South	20.00		W oak 10	N 72° E	53
2	S 10° E	26.00		W oak 6	N 80° E	64
3	S $22\frac{1}{2}^{\circ}$ E	45.76		W oak 18	S $6\frac{1}{2}^{\circ}$ W	55
4	East on $\frac{1}{4}$ line	7.33		W oak 6	N $20\frac{1}{2}^{\circ}$ E	139
				To $\frac{1}{8}$ Stake on E side		N $6\frac{1}{4}^{\circ}$
				of Sec 12		T 19 N R 4 W

The within & several of us hereunto set our hands

Thomas Matthews
B. G. A. Johnson
A. King
} Board of Supervisors

V.P.A.

I do hereby certify the field notes and plat incorporated in the above order are correct of a survey made by me on the 2nd day of Oct 1857 by directions of the Board of Supervisors of the Town of Little Falls

John N. Williams }
Jesse Burchard } Chas

Wm. C. Billes
Co Surveyors

T19 R4 W

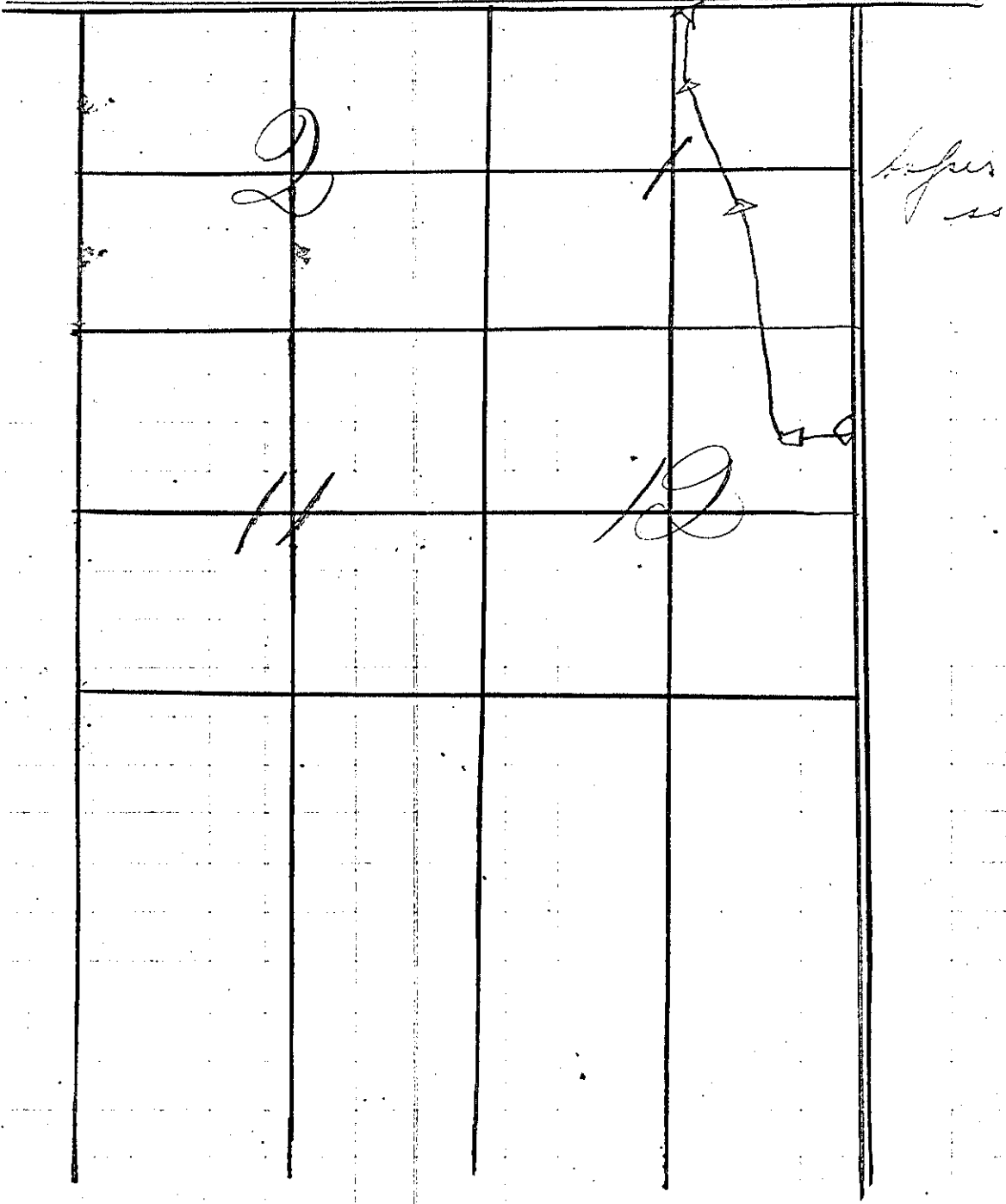

Louise Co
Town of Little Falls } 29

At a meeting of the Supervisors of the said Town of Little Falls on the 12th day of June AD 1856 a majority of the said Supervisors have met agreeably to notice & having examined and deliberated upon the subject matter embraced in this order; It is hereby ordered and determined by them that a highway four rods wide be laid out in said town the center line of which according to actual survey then of which said Supervisors have caused to be made commences at the center 1/4 Stake of Section nine (9) T 18 N of R 4 W of the 4 Mer - & 8 ranges thence west on the 1/4 line 59.75 chains thence S 17° 50' W 3.50 chains thence S 31° W 6.65 chains intersecting the old town road and following the same to the county line on the west side of said town

In witness whereof we have hereunto set our hands

Thomas Matthews
Mark P. Madison } Board
B. H. Robinson } of
Supervisors

B. W. H. Stettin
Town Clerk

P.S. That part of the old town road running west from from the state Road near and parallel to the said 1/4 line as far as the above survey to the intersection of the old town road is hereby discontinued.

Samuel Gaultier }
Town Clerk } Board of Supervisors
Thos. Matthews

Monroe County D. Is
 Town of Little Falls

V-1

At a meeting of the Supervisors of the town of Little Falls on the 22^d day of June 1888 a majority of said Supervisors having met agreeably to notice and having examined and deliberated upon the subject matter embraced in this order It is ordered & determined by them that a town road four rods wide be laid out in said town the center line of which according to actual survey thereof which said Supervisors have caused to be made commences at an angle stake of a town road west of John Audip (near west end of Huff) & runs thence N 16° W 23.3 $\frac{1}{100}$ chains to a Burr Oak tree 12" diameter thence S 62° 40' W 24.7 $\frac{1}{100}$ chains (on this line at point 5.13 chains is 2.68 north of South 14 stake of Sec 36 T 19 N R 4 W) intersecting the aforesaid town road on South Sec line of Sec 36 about 80 rods west of 14 Stake all that portion of the former town road lying between the commencement and terminus of this survey is hereby discontinued

In witness whereof we have hereunto set our hands

Thomas Mathews
 B. S. Atkinson

} Board

B. W. Hitchkiss
 Town Clerk

County of Monroe }
 Town of Little Falls }

V-1

At a meeting of the Supervisors of the said town of Little Falls on the 12th day of June. A. D. 1858 a majority of the said supervisors having met agreeably to notice & having examined & deliberated upon the subject matter embraced in this order It is ordered that & determined that a town Road four rods wide be laid out in said Town the center line of which according to actual survey thereof which said Supervisors have caused to be made commences at a point on a town road from Cataract to Sparta near the south west corner of the SE 1/4 of SW 1/4 of Sec 35 T 19 N of R 4 West of the 4th mer & runs thence as follows

No of Courses	Bearing	Distance	Angle	Bearing	Distance
1	S 15 3/4° W	5 55	Back	6 N 54 1/2° W	21
2	South on line	75 25	Back	8 N 76° E	65
3	S 45° 56' E	28 26	Back	20 N 42° W	31 1/2
4	S 52° 35' E	13 50	Back	10 N 72 1/2° W	24 1/2
			Back	10 S 77 1/2° E	63 1/2
5	S 31° 35' E	38 91	Back	10 N 58 1/4° E	72 1/2
			Back	8 N 76° W	57
6	S 39 1/2° E	16 22	Back	6 S 35° W	34
			Back	6 S 36° E	83
7	S 28° 35' E	30 26	Back	8 S 28° E	110
8	S 1 1/2° E	7 58	Back	24 S 80° E	85
9	S 34 1/4° E	20 14	Back	18 N 57 3/4° E	40
10	S 11 1/4° E	19 71	Back	15 N 54 1/2° W	25
			Back	14 S 63° W	53

Intersecting the old town road from Cataract to Sparta on south side of Sec 13 in T 18 N R 4 West of foot of Ridge All that part of the old town road lying between the commencement & terminus of the survey

Embraced in this order is hereby dis-
continued in witness whereof we have
hereunto set our hand

Thomas Mathew } Board
B. G. Atchinson }

B. H. Atchinson

Town Clerk

Monroe County } ss
Town of Little Falls }

At a meeting of the Super-
visors of the said town of Little Falls on the
11th day of June A. D. 1858 a Majority of the
said Supervisors having met agreeably to
notice & having examined & deliberated upon
the subject matter embraced in this order
It is hereby ordered & determined by
them that a highway four rods wide be
laid out in said town the center line
of which according to actual survey then
of which said Supervisors have caused to
be made commences at the center of East
end of Jackson Street in the village of
Cataract & runs thence $N 58^{\circ} 40' E$ 11,00 chains
thence $N 31\frac{1}{4}^{\circ} E$ $7\frac{7}{100}$ chains intersecting
an old town road running from
Cataract & that part of the old town
road running east from Cataract as
far as the above mentioned intersection
is hereby discontinued.

It is also ordered & determined by them
that a highway four rods wide be laid
out in said town the center of line of
which according to actual survey then of
which said Supervisors have caused to be
made commences at the North end of Palmyra
river street in the village of Cataract &
& runs thence as follows

may var of middle 8 1/2 E

no. of rods	Bearings	Dist in chains	Angle between	Bearings	Distance
1	N 1/2 E	4 1/4			
2	N 33° 10' W	7 14		To white oak 12" diameter	
3	N 56° 35' W	6 65		Boak 8 S 4° W	15
4	N 23 1/2° W	5 37		Boak 8 N 62 1/2° W	65 1/2
5	N 18° 35' W	53 77		S 12 N 2° E	63

Intersecting the old Black River road near the 44 stake on east side of side of the old town road running north from the village of Cotuit to the Black River road is hereby discontinued. In witness whereof we have hereunto set our hands

Thomas Mathews } B d
B. Stinson }

R. Mott Kip
John Clark

Road Survey No 1

Monroe County }
 Town of Little Falls } ss

Whereas upon the Application of six freeholders residents in Said Town of Little Falls for the altering of a highway described as the undersigned Supervisors of Said Town did on the 16th day of May A D 1859 meet at the house of P. C. Walker in Said town for the purpose of them and there deciding upon such application it being the time and place fixed by us for that purpose: did proceed to examine personally such highway and having there and there heard such reasons as were offered for and against altering the same did then and there decide upon such applications and determine to alter such highway as hereinafter described having as required by law first made out a notice and fixed therein a time and place at which we would meet and decide upon such application and the applicant for such highway having five days previous to our Said meeting caused such notice to be duly given to all the occupants of the land through which the said highway passes and such notice having also been posted up in three public places in said town ten days before the time of our said meeting it is ordered and determined and we do hereby order and determine that a highway be and the same is hereby altered pursuant to said application whereof an accurate survey has been made which is as follows to wit commencing at a point 7.45 chains south of the centre 1/4 Section of Sec 9 T 18 N R 4 W where an old State and Town road crosses the ~~1/4~~ S 1/4 line of said Section and runs thence as follows

W O 12-881 & 66

- 1 North on W Line 12.50 (W O 12) N 80 1/2 E 70-W O 5-1882 & 78
- 2 East 10.30 W O 12 N 56 E 22-W O 8 N 84 1/2 E 28
- 3 N 1 1/2 W 14.40 To N 1/4 station on N & S 1/4 Line
- 4 North on W Line 133.46 To center of State Sec 33 T 19 N R 4 W
- 5 West on W Line 11.00 To center of Street in Village of Alton

The line of said survey to be the center of said highway; and the same is established four rods in width and the said Supervisors did also then and there decide and determine, that the State and Town road so much of the same as lies between the commencement and terminus of the present survey route shall and the same is hereby declared to be discontinued & vacated

In Witness Whereof we have hereunto set our hands this 18th day of May A D 1839

P. C. Walker
 J. P. Atkinson } Supervisors

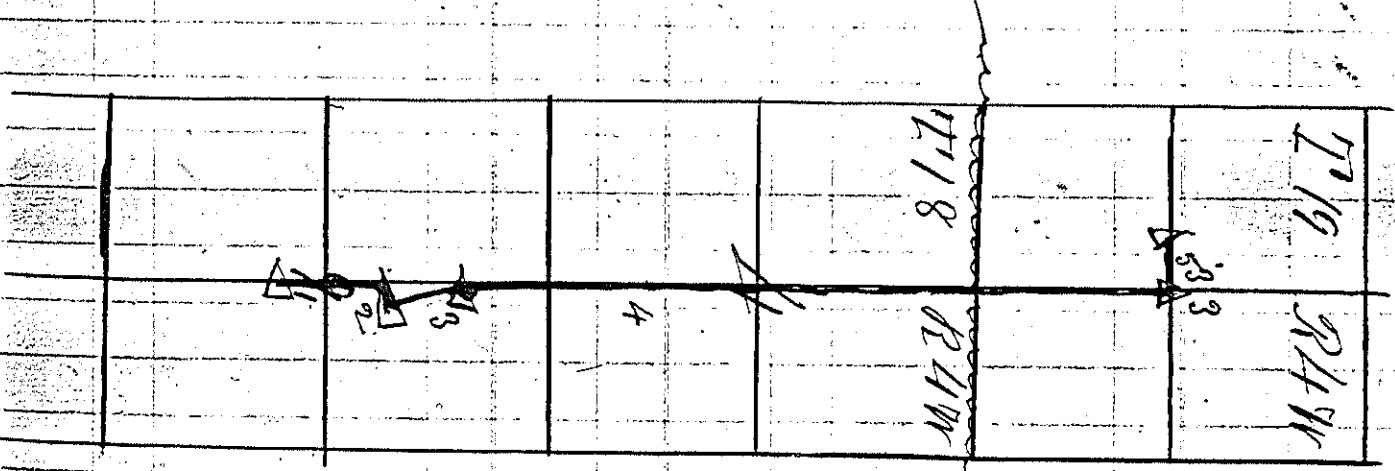

A Copy By
 J. P. Atkinson
 Town Clerk

v1 X

For damages also O Harris in Section 4 Town 18 Range 4th awarded Five dollars damages also to G. W. Root in Section 33 Town 19 Range 4th being on the North East 1/4 of the N W 1/4 awarded Five Dollars for damages also to N. Goulding in Section 33 Town 19 Range 4th awarded three dollars for damages also to G. Louis in Section 4 Town 18 Range 4th awarded Five cents for damages also to S Pratt in Section 9 Town 18 Range 4th awarded Five cents for damages P. W. Pratt in Section 4 Town 18 Range 4th awarded Five cents for damages to the owner of the N E 1/4 N W 1/4 of Section 9 Town 18 R 4th awarded Five cents for damage To owner of W 1/2 S 1/4 Sec 4 Town 18 Range 4th awarded Five cents damages and we do hereby adopt the following Survey made by R. C. Miller on the 18th day of May A.D. 1859

In Witness Whereof we have hereunto set our hands this 20th day of December A.D. 1859

J. B. Walker }
 M. S. Atchison }
 Super }
 visor }

Whereof an accurate Survey has been made which is as follows To wit Commencing at a point 7.45 South of the centre 1/4 stake of Section 9 T 18 R 4th where an old stake and Iron road crosses the N & S 1/4 line of said Section and runs thence as follows

(N 0 12 S 8 1/2 E 66)	W 0 12 N 80 1/2 E 70	W 0 8 N 87 E 78
1 North on 1/4 line } 12.50	W 0 12 N 80 1/2 E 70	W 0 8 N 87 E 78
2 East } 60.50	W 0 12 N 56 E 22	W 0 8 N 84 1/2 E 28
3 N 7 1/2 W } 14.40	To N 1/2 stake on N & S 1/4 line	
4 North on 1/4 line } 135.46	To centre 1/4 stake see 33 T 19 N R 4 W 3	
5 West on 1/4 line } 11.00	To centre of Street in Village of Alloway	

The line of said survey to be the centre of said highway; and the same is established four rods in width — And the said Supervisors did also then and there decide and determine that the State and town road so much of the same as lies between the Commencement and terminus of the present surveyed route shall and the same is hereby declared to be discontinued and vacated.

In Witness Whereof we have hereunto set our hands this 20th day of December A.D. 1859

P. C. Walker } Supervisors
 M. D. Atkinson }

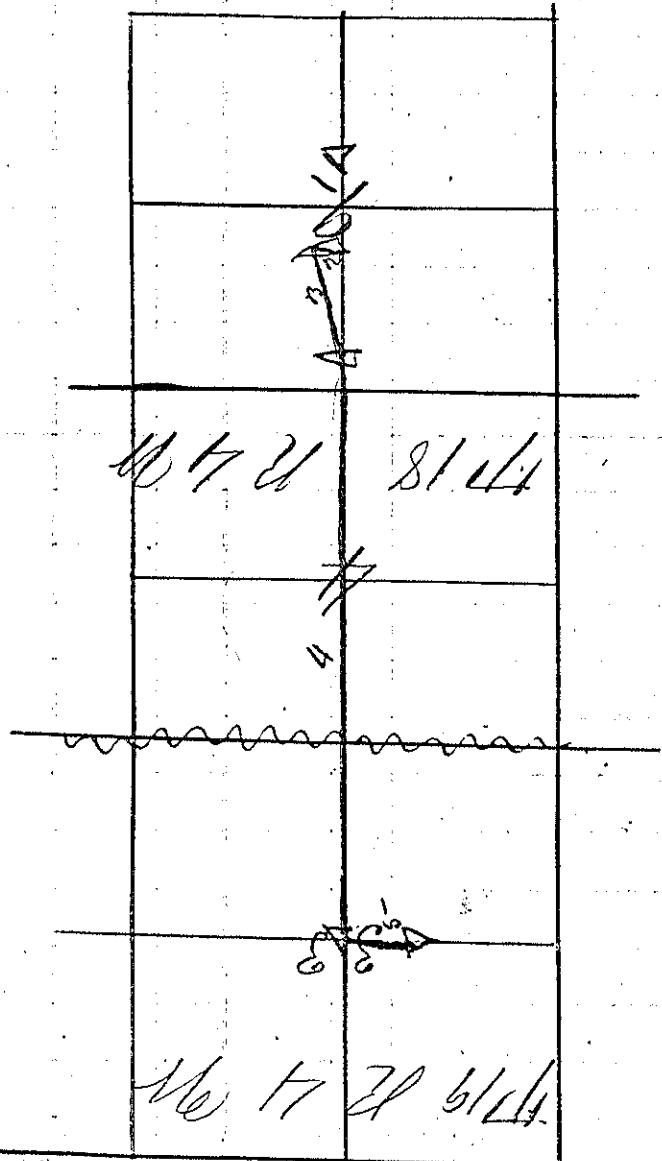

A copy by
 J. F. Reapton
 Town Clerk

Road Survey No 2

County of Monroe
Town of Little Falls

Whereas upon an application of six freeholders residing in the said Town Little Falls the laying out of highway hereinafter described: We the undersigned Supervisors of said Town did on the 16th day of May 1859 met at the house of P. C. Walker in said Town for the purpose of them and there deciding upon such application it being the time and place fixed by us for that purpose: did proceed personally to examine such highway and having then and there heard such reasons as was offered for and against laying out the same did then and there decide upon such application and determine to lay out said highway as hereinafter described having as required by law first made out a notice and fixed therein a time and place at which we would meet and decide upon said application and the applicant for such highway having five days previous to our said meeting caused such notice to be duly given to all the occupants of lands through which said highway passes and such notice having also been posted up in three public places in said Town ten days before the time of our said meeting: it is ordered and determined and we do hereby order and determine that a highway be laid out pursuant to said application: Whereof an accurate survey has been made which is as follows to wit: commencing at the center $\frac{1}{4}$ stake of Section Six (6) in T 18 N R 4 W and runs thence East on $\frac{1}{4}$ line 20.00 chains to E $\frac{1}{2}$ stake on E 4 $\frac{1}{2}$ $\frac{1}{4}$ line thence S 72° E 6.00 ch; B. oak 4 $\frac{1}{2}$ 72° E. 21 $\frac{1}{2}$ $\frac{1}{4}$ line

Y-1

Thence N 72° E 6.00 ch: B Oak 8 N 157° E 6.44 chs
Thence East on the line 56.84 chs B Oak 12 S 46
14 W 60 links.

Where it intersects a state road
From Sparta to Prescott the line of said
Survey to be the center of said highway
and the same is established four rods
in width.

We Witness Whereof we have hereunto set our
hands this 19th day of May A.D. 1859

P. B. Walker } Supervisors
M. S. Atkinson }

T. 18 N R. 4 W

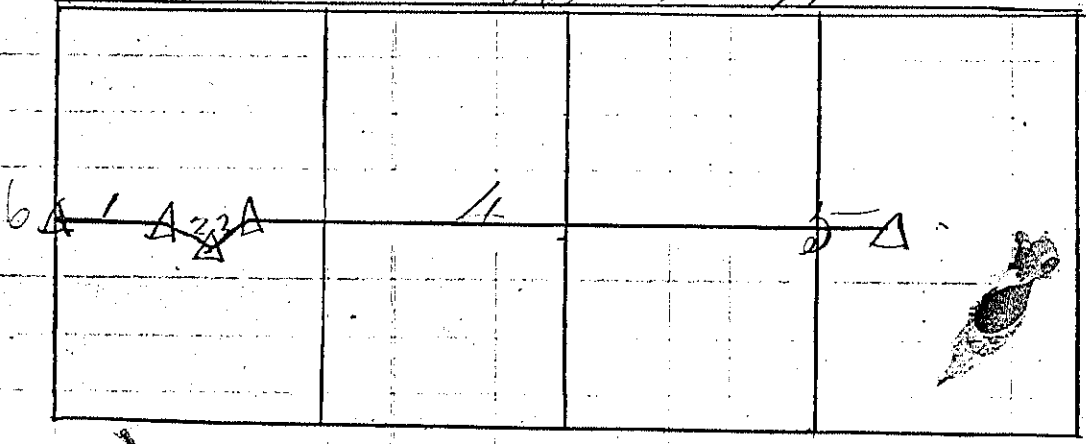

A Copy by J. F. Rathbone
Town Clerk

✓ Road Survey No 3

Monroe County
Town of Little Falls

Whereas upon the Application of Six freeholders residing in said town of Little Falls for the laying out of a highway hereinafter described and the undersigned Supervisors of said town did on the 16th day of May AD 1889 meet at the home of P. C. Walker in said town for the purpose of then and there deciding upon such application it being the time and place fixed by us for that purpose did proceed to examine personally such highway and having then and there heard such reasons as were offered for and against laying out the same did then and there decide upon such application and determined to lay out such highway as hereinafter described having as required by law first made out a notice and filed the same a time and place at which we would meet and decide upon such application and the applicants for such highway having five days previous to our said meeting caused such notice to be duly given to all the occupants to all the land through which said highway passes and such notice having also been posted in three public places in said town ten days before the time of our said meeting it is ordered and determined and we do hereby order and determine that a highway be and the same is hereby laid out Pursuant to said application whereof an accurate survey has been made which is as follows to wit Commencing at the South East corner of Sec 30 T 19 N R 4 W and running thence

V-6 X

House	Bearings	Dis	Angle	Tree	Pia	Bearings	Distance
1	N 89 1/2° W on the line	59.49	Double	B Oak	6	S. 55 1/4 E	37
2	S 64 3/4° W	7.34		To Black oak 8 in diameter			
3	S 77° W	11.61		To Grey Pine 8 inch diameter			
4	N 71 1/2° W	13.13		To S.W. corner Sec. 30			

The line of said survey to be the center of said highway and the same is established from
 100 ft wide

Our witnesses where we have hereunto set
 our hands this 14th day of May A.D. 1889

J. B. Walker } Supervisors
 M. P. Atkinson }

T 19 N R 4 W

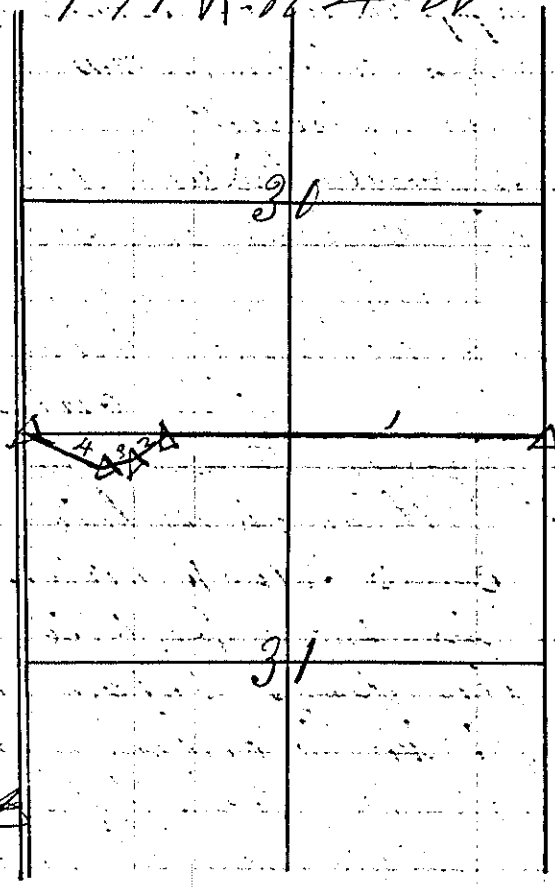

A Copy By
 J. L. R. Atkinson
 Town Clerk

Road Survey No 4

Monroe County, La
Town of Little Falls

Whereas upon an application of six freeholders residing in the said town of Little Falls for the alteration of a highway hereinafter described are the undersigned Supervisors of said town did on the 16th day of May A.D. 1839 met at the house of J. C. Walker in said town for the purpose of then and there deciding upon such application it being the time and place fixed by us for that purpose did proceed to examine personally such highway and having then and there heard such reasons as were offered for and against altering the same did then and there decide upon such application and determine to alter such highway as hereinafter described having as required by law fixed therein a time and place at which we would meet and decide upon such application and the applicant for such highway having five days previous to our said meeting caused such notice to be duly given to all the occupants of lands through which said highway passes and such notices having also been posted up in three public places in said town ten days before the time of our said meeting it is ordered and determined and we do hereby order and determined that highway so named the same is hereby altered pursuant to said application as follows to wit Commencing at an angle stake of town road in North West quarter of sec 8 in T 19 N of R 4 W and running thence (bearing tree at commencement of road) B @ 10 S 26 W 63

Courses	Bearings	Distance	Trees	Dis	Bearings	Dis
1	S 43° 55' E	21.20	B Oak	12	N 51 1/2° E	45
2	S 35° E	17.81	B Oak	14	N 85° E	19 1/2
3	S 48° 35' E	22.50	B Oak	10	S 1° W	72
4	S 41 1/4° E	13.60	B Oak	4	S 78 1/2° E	6 1/2
5	S 59 1/2° E	2.69	To	South East corner of sec 8		

Where it again intersects old town Road the line of present Survey to be the centre of said highway and the same is hereby established for all rolls in width

It is also ordered and determined that such part of old town as lies between the commencement and terminus of present surveyed route is discontinued and vacated

In witness whereof we have hereunto set our hands and seals this 19th day of May A.D. 1859

J. C. Miller } Supervisors
J. P. Atkinson

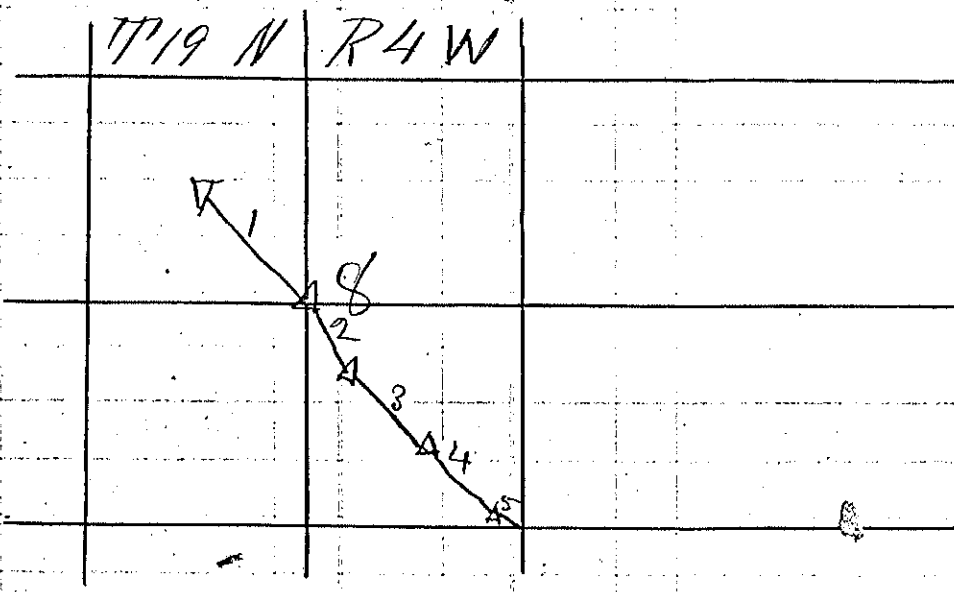

A Copy By J. F. Rathburn
Town Clerk

Road Survey No. 5

Monroe County
Town of Little Falls

Whereas upon the application of six petitioners residing in said town of Little Falls for the laying out of a highway herein after described and the undesignated portions of said town did on the 19th day of May A.D. 1859 meet at the house of P. C. Wata in said town for the purpose of them and them deciding upon such application at being the time and place fixed by us for that purpose did proceed personally to examine such highway and having there and then had such surveys as were required for and against laying out the same did then and there decide upon such application and determine to lay out said highway as herein after described having as required by law first made out a notice and for the same at some one place at which we would meet and decide upon such application and the applicant for such highway having first been sworn to our said notice and said notice to be given to all occupants of lands through which said highway passes and such notice having also been posted up in three public places in said town ten days before the time of our said meeting it is ordered and determined and we do hereby order and determine that a highway be laid out the same to be laid out pursuant to said application and that where an accurate survey has been made which is as follows to wit: commencing at a point on S.W. 1/4 line 2344 East of the corner of the lot of section 29 T. 13 N. R. 4 W. (near the south west corner of N. E. of section farm) and run thence