

# Town of Angelo Records

## Roads & Road Business

At a meeting of the Board May 12 1835  
the Town was divided into four road  
Districts for description (See old Book)

May 21 1835 a road laid commencing  
on Town line from S E corner of Sec 31  
Town 17 Range 3 to the Mill at Angelo  
(See old Book)

✓ May 11 1835 a road laid commencing  
on the east line of Sec 24 running  
west to Walnutts (See old Book)

June 12 1835 <sup>(this is Cole valley road)</sup> a road laid commencing  
at the S W corner of Sec 18. Town 17 running  
east on sec line to Sec 13 (See old Book)

June 2 1835 a road laid commencing  
at the Village of Angelo running North  
through 17 & 18 by Shaffer & Wilson and  
Table Rock (See old Book)

Oct 3 1835 a road laid commencing  
at Farm's farm running to St Johns  
(See old Book)

Oct 2 1835 a road laid commencing on  
Sec line near the Village of Angelo running  
by Lafayette to east line of Town 18  
(See old Book)

2.

July 21 1856 road laid commencing on  
Sec 23 running to sec 14 (See Old Book)

Co  
f

March 1 1856 road laid commencing + end

2

March 1 1856 Board met and reorganised  
Road dist into 9 dist (See Old Book)

No of  
Comm

1

2

3

4

5

6

7

8

9

In  
the  
I do  
true  
by

Oct 9 1856 A Road Surveyed and laid as follows Viz Commencing on Township line 2300 Chains west of the S E Corner of Sec 36 in Town 17 Range 3 west. and run as follows Viz

No of Corners	Bearings	Dis in Chains	Dis in Miles	Angle Degrees	Dis	Bearings	Dis	Remarks
				W Oak	8	S 75 1/4 W	59 1/2	on Sec line at place of Beginning
				" "	4	N 70° E	39	
1	N 40 1/2 W	46.10		Br Oak	14	N 30 1/2 E	84	
				W Oak	4	S 62° W	96 1/2	
2	N 70.20 W	10.06		W Oak	30	S 49 1/2 E	37	
				" "	8	S 69° W	32	
3	N 3 1/4° W	20.50		L Oak	3	S 77 1/2 W	114	
4	N 35° W	4.57		W Oak		S 45 1/2 W	77	
5	N 1/4° E							
	on 1/8 line	108.54		To Center of State Road				
6	S 88 1/2 E							
	on line of State Road	20.09		To North & South 1/4 line of Sec 24				
	N 3/4 E			Gr Pine	6	N 40 1/2 W	20	
7	on 1/4 line	31.50		" "	6	S 65 1/2 W	23	
8	N 41 1/2 E	15.70		Gr Pine	6	N 41° W	14 1/2	
				" "	6	N 85 1/2 E	29	
9	N 61 1/2 E	28.28		Gr Pine	6	S 18 1/4 W	26	
				" "	4	S 47 1/2 E	19	

336

Intersecting on Town Road 346 Chains West of the North East Corner of Sec 24 Town 17, N Range 3 West I do hereby certify that the above field notes are true and correct of the aforesaid survey made by me on this 9<sup>th</sup> day Oct 1856

C. C. Miller  
County Surveyor

6

County of Morrow  
Town of Angels 55

At a meeting of the Supervisors of  
the Town of Angels on the 20<sup>th</sup> day of July A.D.  
1857 all of sd Supervisors having sheet agreeable to  
previous Notice and examined and deliberated upon  
the subject matter embraced in this order.

It is ordered and determined by them that a  
highway be laid out in said Town of the width  
of four rods the center line of which according  
to an actual survey thereof which said Supervisors  
have caused to be made

commencing at the 1/8 Stake on the  
North 1/2 of West section line of section  
eight (8) in Town 17 North of Range 3  
West and runs thence as  
follows  
on the next page

No of  
Course

See  
a  
here  
Aug

I  
an  
Aug 5  
of the

may be read from Village to Farmed Valley

No of Courses	Bearings	Distance in Chains	Distance in Mils	Angles	Notes	Bearings	Distances	Remarks
1	S 70 E	45.65			6 L Pine	S 12 E	6.2 1/2	
					4 L Pine	N 26 1/2 E	6.7	
2	S 80 1/4 E	38.17			6 Br Oak	N 77 1/4 E	7.6	
					8 Br Oak	S 65 W	8.2	
3	South on Section Line	33.69			12 L Pine	S 82 E	9.3	30.94 at corner sec 8.9.16.17
					12 Br Oak	S 50 3/4 W	12.3	
4	S 40 3/4 E	23.87			6 Br Oak	N 9 E	4.6	
					6 Br Oak	N 60 1/4 E	4.9	
5	S 60 50 E	45.79			To a small L Pine			
6	S 52 27 E	113.32			10 L Pine	N 21 1/2 E	2.9	
					8 L Pine	S 14 W	5.7	
7	S 64 1/4 E	35.20			4 Br Oak	N 29 W	4.1	12.87 to 1/2 stake on W side
					10 L Pine	N 81 1/2 W	7.4	sec 23 marked N 3 P to E
8	South on 1/83 Line	7.40			6 L Pine	S 44 1/4 W	8.9	
					10 L Pine	N 37 1/2 E	12.11	

HITS CORNER OF SEC. 8, 9, 16, 17

Intersecting Town Road from Ridgeville to Sparta

In Witness whereof we have hereunto set our hands at Angelo this 17<sup>th</sup> day of August A.D. 1837

L. M. Huntley  
Amos Grinols } Supervisors  
David Littell }

I hereby certify that the above field notes are correct of a survey made by me on the 20<sup>th</sup> day of July 1837 by direction of the Board of Supervisors of the Town of Angelo

C. C. Miller  
County Surveyor

County Menner  
Town of Angelo

At a meeting of the Supervisors of  
said Town of Angelo on the 21<sup>st</sup> day of July A.D.  
1857 all of said Supervisors having meet agreeable  
to previous notice and having examined and deliberated  
upon the subject matter embraced in this order,  
It is ordered and determined by them that a  
highway be laid out in said Town of the width  
of four rods, the center line of which according to an  
actual survey thereof which said Supervisors have  
caused to be made,

Commencing at a point on  
section line between Sections 8 & 9 in  
Town 17 North of Range 3 west 9.87  
Chains south of west 1/4 stake of Sec 9  
(marked No 3 from R to C) and runs  
thence as follows  
on the next Page

No of  
Corners

1

2

3

4

5

6

7

J

M

L

S

A

J

C

St

Bo

E

A

Var of needle  $8\frac{1}{4}$  East

No of Corners	Bearings	Distance in Chains	Distance in Miles	Angle Feet meters	Bearings	Distance	Remarks
				Black 6	N $77\frac{1}{4}$ E	76	
				Black 8	S $65$ W	82	
1	North on } Sec line	7.87	To $\frac{1}{4}$ Stake				No 3' from Pt. C
2	East on } $\frac{1}{4}$ line	212.33		G Pine 10	S $31\frac{1}{2}$ W	88	(160.17 to $\frac{1}{4}$ Stake on west side of see 11 <sup>th</sup> marked to 5' Pt. C)
				G Pine 8	S $72$ E	35 $\frac{1}{2}$	
3	S $51.40$ E	17.17		G Pine 6	N $48\frac{1}{2}$ E	39	
				G Pine 6	S $31\frac{1}{2}$ W	70	
4	S $68\frac{1}{2}$ E	6.32		G Pine 8	S $37$ E	34	
				G Pine 10	S $70\frac{1}{4}$ W	32	
5	East	9.50		G Pine 8	N $11\frac{1}{2}$ E	45	
				Black 8	N $24$ W	42	
6	N $53$ E	31.40		Black 6	N $43\frac{1}{2}$ E	39	
				Black 6	N $29\frac{1}{2}$ W	45	
7	N $86.40$ E	50.75		Black 8	N $26\frac{1}{2}$ W	20	by Plat this distance should be about 25.75
				Black 6	N $73$ E	16	

Intersecting a road laid from Lafayette to  
Mound Prairie

In Witness whereof we have hereunto set our  
hands at Angelo this 18<sup>th</sup> day of August  
A D 1857

S. M. Huntley }  
Amos Grinols } Supervisors  
David Little }

I hereby certify that the above field notes are  
correct of a survey made by me on the 21<sup>st</sup>  
day of July 1857 by directions of the  
Board of Supervisors of the Town of Angelo

E. Peters }  
A. Peters } Chairman

C. C. Miller  
County Surveyor

County of Monroe }  
Town of Angelo } 55

At a meeting of the Supervisors of  
Said Town of Angelo on the 22<sup>nd</sup> day of July 1857.  
All of said supervisors having met agreeable to a  
previous Notice and having examined and deliberated  
upon the subject embraced in this order,

It is ordered and determined by them that a  
highway be laid out in said Town of the  
width of four rods the center line of which  
according to an actual survey thereof which  
said Supervisors have caused to be made  
commencing at a point on a Town Road  
from Angelo to Best Point 7.65 Chassis  
west of the center 1/4 stake of section 4  
in Town 17 North of Range 3 west  
and runs thence as follows  
on the next Page

No of  
Courses

1

2

3

4

5

6

7

8

9

10

11

12

13

14

15

16

17

18

19

20

21

22



No of Courses	Bearings	Distance in Chains	Distance in Mts	Angle	Dir	Bearings	Distance	Remarks
1	East on <sup>line</sup> 1/4	47.89				S 17 1/2° E	73	1/4 stake? 765 to center of
						S Pine 8		
						S Pine 8	62	47.89 to East 1/4
2	N 45° E	54.51				N 1/2° W	22	Stake of sec 4
						S Pine 6		
						S Pine 5	25	
3	East on							of sec 2, 3, 34, 35?
	Town line	99.91				To corner sec 1, 2, 35, 36.		19.91 to corner
4	S 28 3/4° E	55.69				W Oak 10	56	
						B Oak 8	52 1/2	on Ridge
5	S 83° E	1.57				S Pine 10	27	" "
6	S 15 1/2° E	36.04				S Pine 8	13	
						B Oak 12	40	
7	S 35 1/4° E	27.18				B Oak 4	13	
						S Pine 8	35	
8	S 21 1/4° W	28.00				B Oak 4	27	
						S Pine 6	31	
9	S 35 1/2° W	13.63						To North 1/4 Stake of sec 13, marked No 1 from
10	South on 1/4 line	80.00						To South 1/4 Stake of sec 13, marked No 1 from

In witness whereof we have hereunto set our hands at Anxelo this 18<sup>th</sup> day of August A D 1837

S. M. Huntley  
 Amos Grinols } Supervisors  
 David Sittell

I hereby certify that the above field notes are correct of a survey made by me on the 22<sup>nd</sup> day July 1837 by directions of the Board of Supervisors of the Town of Anxelo

E. Peters }  
 S. D. Stewart } Chairman  
 C. C. Miller }  
 County Surveyor

Monroe County  
Town of Angels Is

States road

At a meeting of the Supervisors of said Town of Angels on the 13<sup>th</sup> day of August A D 1837 a majority of said Supervisors having met agreeable to previous notice and having examined and deliberated upon the subject matter of this order. It is, <sup>ordered and</sup> determined by them that a highway be laid out in said Town of the width of four rods, the center line of which according to an actual survey thereof which said Supervisors have caused to be made, commences at the quarter Post on the west bounds of section No seven (7) Township No seventeen (17) North of Range Number three (3) west of the fourth principal meridian, running thence East on the quarter line eighteen (18) chains fifty (50) links to intersect the Highway leading from Sparta to Athens. In witness whereof we have hereunto set our hands at Angels this 19<sup>th</sup> day of August A D 1837

J M Huntley  
Amos Griggs } Supervisors  
David Littell

I hereby certify that I made the survey incorporated in the above order by directions of the Supervisors of the Town of Angels and said Supervisors officiating as Clerks &c

E A Rice

Deft County Surveyor

Warner County  
Town of Angelo SS  
& Town of Leon

At a joint meeting of the Supervisors of the said Towns of Angelo and Leon on the 8<sup>th</sup> day of September A.D. 1857 agreeable to notice a majority of the Supervisors of each of the said Towns of Angelo and Leon having met and examined and deliberated upon the subject matter embraced in this order it is ordered and determined by them, that a highway four rods wide be laid out on or near the town line between said Towns, the center line of which highway according to an actual survey thereof which said Supervisors have caused to be made commences at the South East Corner of Section No thirty one (31) Town seventeen (17) North of Range three (3) West Running thence

NOW WELLS

- E 121. 00 <sup>chain</sup> <sup>links</sup> on Town line to a quarter Post on Sec 33.
- S — " 50 on quarter line
- E 20. 00 parallel to Town line to 1/8 Post
- N — " 30 on 1/8 line to Town line
- E 126. 50 on Town line to a Stake
- N 40° E 19. 08 to a Stake
- N 64° E 11. 22 to a Stake
- N 62° E 8. 58 to a Stake
- N 33° E 7. 00 to a Stake
- N 70° E 11. 78 to a Stake
- N 32° E 4. 69 to a Stake
- N 40° E 12. 50 to a Stake
- N 30 1/4° E 37. 50 to a Stake
- N 87 1/2° E 4. 98 to intersect a road on the

on 1/8 line, 50 links South of the 1/8 Post on Sec 36 Town 17 N of R 3 West  
And it is further ordered and determined  
(ref.)

That said road be divided at the quarter Post  
 on the south bounds of section No 33  
 into two roads districts, the one west of  
 said quarter post shall belong to Leon and  
 the one east to Angelo for the purposes of  
 working opening and improving  
 In witness whereof we have herunto  
 set our hands this 21<sup>st</sup> day of September  
 A D 1857

David Little) Supervisors  
 Amos Griggs) of  
 Angelo  
 Moray Skayton) Supervisors  
 James Brooks) of  
 Leon

I hereby certify that on the 8<sup>th</sup> day Sept  
 A D 1857 I made the Survey of a Town line  
 Road for a majority of the Supervisors of  
 each of the Towns of Angelo and Leon  
 The said Supervisors officiating as Chairman  
 &c

E A Rice  
 Deft Co. Surveyor

May 1928

Wells & Angelo townships

Angelo scale 1/4 mile

town line 4nd road

Sparks

4	5	3	1
Jelfelbin	Wamborn	Hastings	Kickapoo Road 1862
32	33	34	35
Wamborn	Wamborn	Kickapoo	Kickapoo

Wells 1/4 mile Division

Wells town

Angelo 2 miles natural

1 laid 8 Sept 1857 Town of Wells

June 21-1862 " "

Feb 25 1878 " Wells Comm.

Monroe County }  
Town of Angelo, La

At a meeting of the Supervisors of the said Town of Angelo on the 9<sup>th</sup> day of September A D 1857 a majority of said Supervisors having met agreeable to notice and having examined and deliberated upon the subject matter embraced in this order. It is ordered and determined by them that a highway four rods wide be laid out in said Town. The center line of which according to an actual Survey thereof of which said Supervisors have caused to be made, commences at a stake on the south bound of section No 33 Town 17 Range 3 West sixteen (16) chains thirty one (31) links east from the quarter Post. Beginning thence

N 12 1/2 W 20.57 <sup>ch. 06</sup> to 1/8 line B. J. L Oak 20 5676 2. 73

--- W 3.50 on 1/8 line B. J. G Pine 10 N 16 E 0. 78

N 40 W 12.96 to the quarter line

N --- 19.50 on the quarter line

N 79 1/2 W 29.00 to a stake B. J. G Pine 8 546 1/2 W. 0. 19

N 88 1/2 W 14.48 to Section line B. J. B Oak 12 N 43 1/2 W 0. 82

--- W 29.84 to intersect the Valley Road B. J. L Oak NW 0. 50

In witness whereof we have hereunto set hands this 26<sup>th</sup> day September A D 1857

David Littell, Supervisor  
Armed Grinds

I hereby certify that on the 9<sup>th</sup> day September A D 1857 I surveyed by order of a majority of the Supervisors of the Town of Angelo a highway

E. A. Rice  
Deft. Co. Surveyor

Monroe County  
Town of Argyle S.S.

At a meeting of the Supervisors of the said Town of Argyle on the 31<sup>st</sup> day October 1857 agreeable to notice all of said Supervisors having met and deliberated upon the subject matter of this order It is ordered and determined by them that a highway be laid out four rods wide the center line of which according to an actual survey thereof which said Supervisors have caused to be made, Commences at a Stake on the East & West quarter line on sections No 32 & 17 R3 & N. and in the center of the highway leading from Sparta to the Kickapoo at Welch's mill, Running thence

- N 126.58 on quarter line to a Stake B. J. Chestnut Oak 169 S <sup>Ch</sup> 216
- 59 69 W 0. 50
- N 73 W <sup>Ch</sup> 1. 79 to a Stake B. J. Chestnut Oak S 35 W 0. 37
- N 78 1/2 W 1. 89 to a Stake B. J. White Oak S 69 W 0. 47
- S 73 W 4. 00 to the quarter line
- W 9. 60 on said quarter line to quarter post on the Town line,

In witness whereof we have hereunto set our hands this 31<sup>st</sup> day October 1857

S. M. Huntley  
Amos Grimes } Supervisors  
David Lottel

I hereby certify that on the 31<sup>st</sup> day October 1857 I surveyed a highway for the Supervisors of the Town of Argyle of which the above is a survey said Supervisors officiating assisted by Dean and Tom who were duly sworn as Churmen &c

E. A. Rice  
Supt Co Surveyor

County of Morris  
Town of Engle SS

The Supervisors of the said Town of Engle, having been petitioned by six freeholders and after having given ten days notice meet agreeable to said notice at the House of S. M. Huntley on the 28 day March 1859; and after having examined and deliberated upon the subject matter embraced in this order; it is hereby ordered and determined by them, that a public highway four rods wide, be laid out in said Town the center line of which according to actual survey thereof which the said Supervisors have caused to be made commences at the east 1/8 Stake on the South Section line of Sec 30 in T. 17. N of R. 3 W and runs thence as follows Var. of merid 8 3/4 E

Course	Bearings	Distance	Chngl Poles	Diag	Bearings	Distance
1	North on 1/8 line	76.00	No Irons near			
2	N 30° 05' W	28.15	B Oak 12	N 30 1/4 W	99	
			B Oak 14	N 82 1/2 W	119	
3	N 35 3/4 W	9.67	B Oak 8	N 56° W	73	
4	N on 1/4 line	96.26	Stake is 393 links North of Cen 1/4 S. Sec 19			
5	N 51° E part RR	23.90	Stake 23 links South of Cor Sec. 7, 8, 17, 18			
6	North on Sec line	52.61	no Irons near			
7	N 65° W	12.66	B Oak 12	S 80 1/4 W	101	
8	N 58 1/2 W	11.10	To South end of Water Street in the Village of Athens			

In witness whereof we have hereunto set our hands

S. M. Huntley  
John E. Ensign Supervisors  
Benj. F. Sims



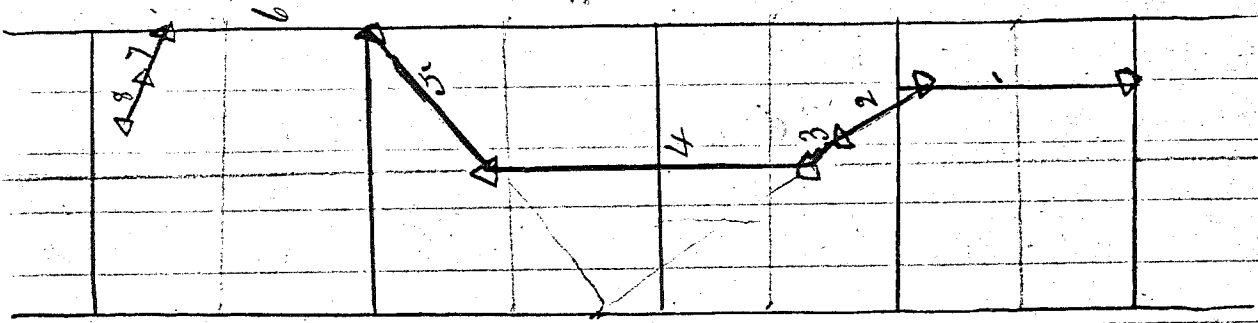

I hereby certify that the field notes and plat incorporated in the above order are correct of a survey made by me on this 29<sup>th</sup> day of March 1859, by directions of the Supervisor of the Town of Angeles

Var of needle  $8\frac{3}{4}$  E

C. C. Miller

Deft Co Surveyor

Murray Huntley }  
S. H. Dulaba } Ch

County of Monroe } S.S.  
Town of Angola }

The Supervisors of the said Town of  
Angola having been petitioned by six freeholders  
and after having given ten days notice meet  
agreeable to said notice at the House of Geo Hull on  
the 28<sup>th</sup> of March 1839; and after having examined  
and deliberated upon the subject matter embraced  
in this order. It is hereby ordered and determined  
by them, that a highway four rods wide be laid  
out in said Town the center line of which according  
to actual survey thereof which the said Supervisors  
have caused to be made commences at the E 1/8  
Stake on East & West 1/4 line of Sec 30 in T17N R3  
W and runs thence as follows

- |   |                   |       |              |              |     |
|---|-------------------|-------|--------------|--------------|-----|
| 1 | South on 1/8 line | 3.67  | No Iron near |              |     |
| 2 | S 50 3/4 E        | 11.95 | B. Oak       | 6 S 73 1/2 W | 146 |
| 3 | S 67 3/4 E        | 19.84 | B. Oak       | 8 S 65 1/2 W | 43  |

Intersecting the Old Town road; which Town road  
between the commencement and terminus of the  
above road is hereby discontinued and vacated

In witness whereof we have hereunto  
set our hands

S M Huntley  
John E. Ensign } Supervisors  
Benj. F. Sims }

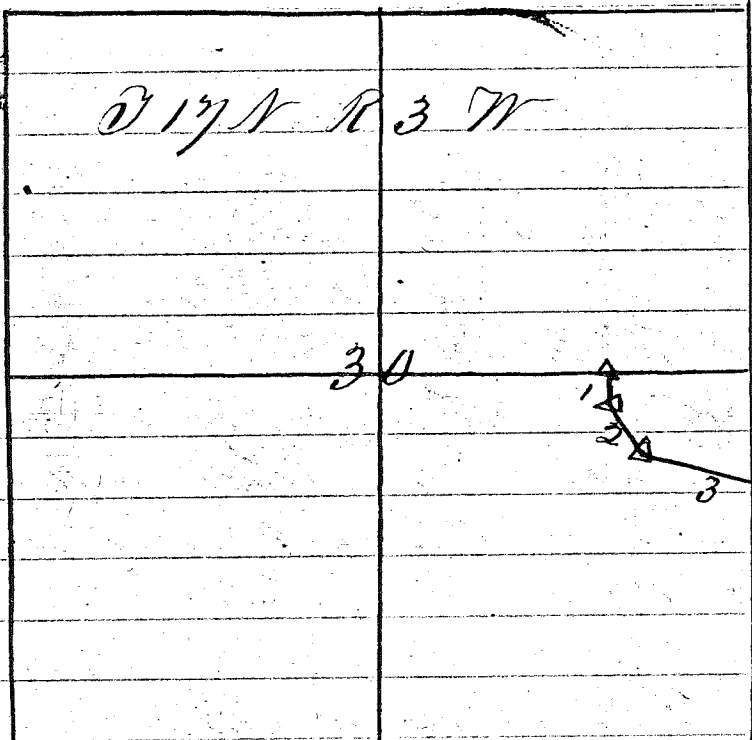

I hereby certify that the field notes and  
 plot incorporated in the above order is  
 correct of a survey made by me on the  
 29<sup>th</sup> day of March 1859 by directions of  
 the Supervisors of the Town of Angels  
 Van of needle  $8\frac{3}{4}$  E

C. C. Miller

Murray Huntley } ch  
 S. H. Bullock }

Sept Co Surveyor

County of Monroe } S.S.  
 Town of Angola } S.S.

The Supervisors of the said Town of Angola having been petitioned by six freeholders, and after having given ten days notice; not agreeable to said notice, at the House of S. M. Huntley on the 28<sup>th</sup> day of March 1859; and having examined and deliberated upon the subject matter embraced in this order; It is hereby ordered and determined by them, that a public highway four rods wide be laid out in said Town the center line of which according to actual survey thereof which the said Supervisors have caused to be made commences at a point on the State Road from Sparta to Lisbon 380 links East of Township line in the S W 1/4 of Sec 18 T 17 N R 3 W and runs thence

- |   |         |         |       |   |             |     |
|---|---------|---------|-------|---|-------------|-----|
| 1 | S 39° E | 5.38    | RO    | 8 | N 88 1/2° E | 164 |
| 2 | East    | 7.40    | Line  | 8 | S 12 1/2° E | 14  |
| 3 | N 51° E | post RR | 33.94 |   |             |     |

Intersecting a Town road which continues along line of Success & M RR at a point 393 links north of center State of Sec 18

In witness whereof we have hereunto set our hands

S. M. Huntley  
 Benj. F. Davis } Supervisors  
 John E. Emery