

WEST OAK ST.

POINT 296.4' EAST OF THE EAST LINE OF THE COURT HOUSE SQUARE

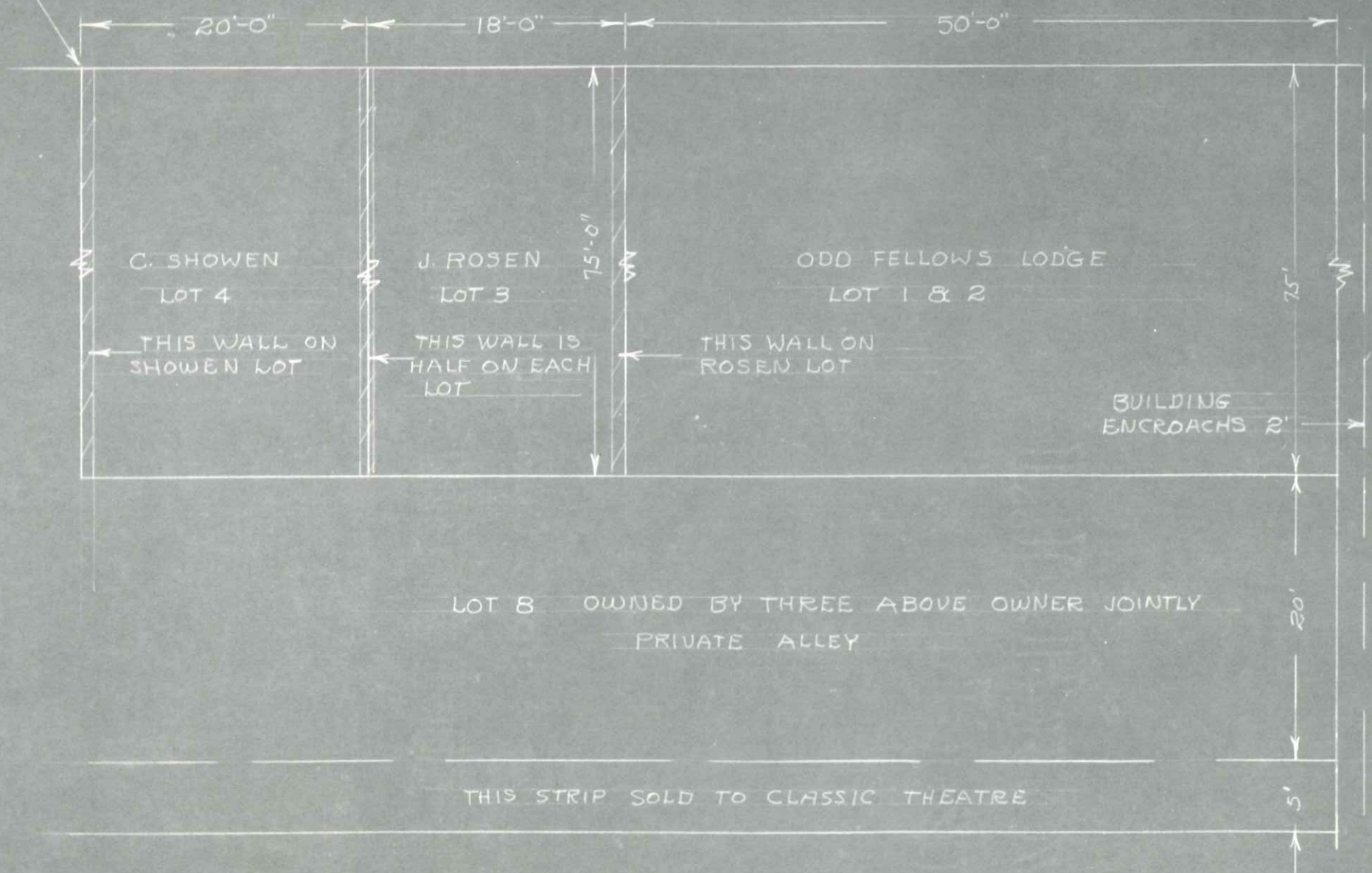

DESCRIPTION

SURVEY OF LOTS 2 & 3 OF NOLANS SUBD.
CITY OF SPARTA

3-15-47

O BERGMAN

BY ORDER OF CHAS SHOWN & J. ROSEN.