

Survey & Subdivision of Part of
 Section 17 Township 18 North Range 2 West

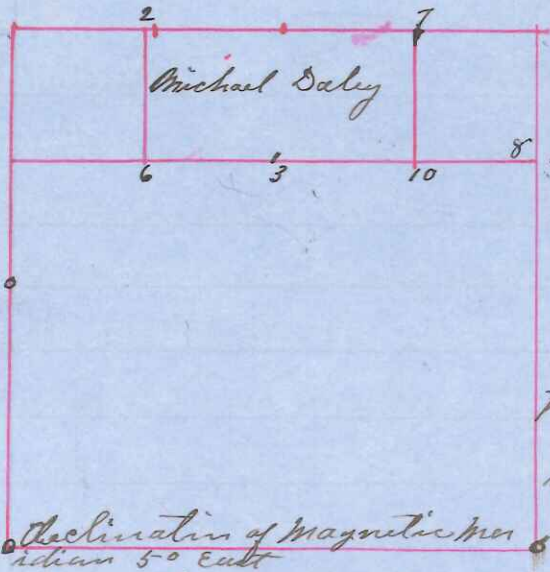

Commenced at SE Corner of section identified by one Sawt bearing tree yet standing to wit B Pine 11 S 36 E 694 links Chaining North 800 to Temporary corner. then going to SW Cor of Section 18 located by survey of Sec 18 Chaining North 160 chains identified NW Cor Sec 8 by Stumps of original wit trees thus locating NW Cor of 17 thence chaining East 79 chains + 79 links according to gov

Declination of Magnetic Meridian 5° East

Survey located the NE Cor of Section Establishing the 1/4 part on North side Equidistant from sec corner Making bearing therefor
 W 0 3 S 64 E 131 - fo 5 S 21 1/2 E 131
 " " Sub Corner 2 fo 2 1/2 N 40 E 13 1/2
 " " 3 fo 7 N 79 W 46 fo 3
 " " 6 of Pine 6 S 81 1/2 E 248 1/2 B 20 12 S 24 E 28
 " " 7 fo 7 S 55 E 235 fo 5 S 13 1/2 E 578
 " " 10 fo 8 S 40 E 347 W 0 6 S 44 E 397 1/2
 15 " for 1/4 part West side Survey of section 18 made

Jan 23rd + 24th 1901

Sworn assistants
 Michael Daly }
 A B Hall } Chairman
 Leo Harpner P. Laysman

fo 3 S 57 W 103 1/2 fo 4 S 35 W 133 1/2
 Done Jan 24th + 25th 1901 and Certificate issued to Michael Daly this 29th day of Jan 1901
 Paul A Holder
 Co Surveyor

- 13 1911 st #8 Set Stone
- 8 " # 3 fo 5 - South 1 link Set Iron Stake
- 21 S E Original
- 1 NE Set Stone