

Sec 28 Town 16 N Range 4 W

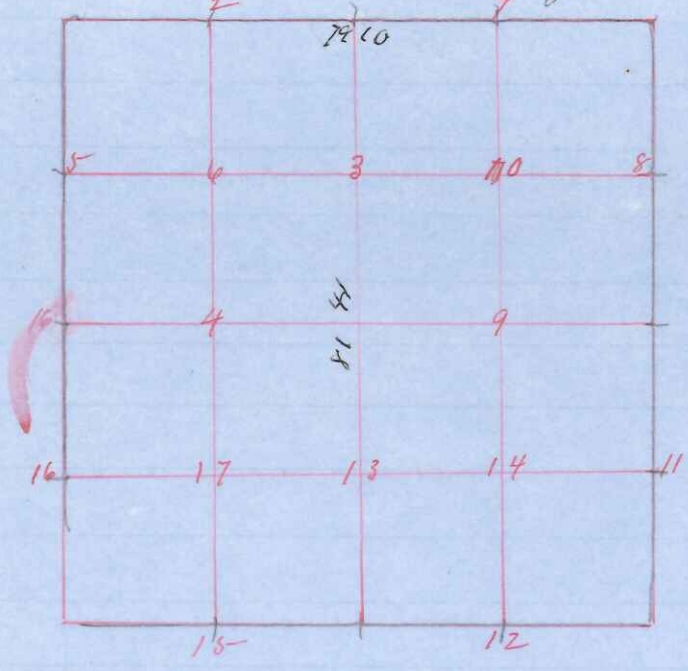

Survey made June 1910

Sworn assistants
 Harry Berg
 Gustave Gilbertson } Chairman
 Adolph Gilbertson)
 Peter McCabe } Placers

NW Sec Corner for Stub 10 S 84 1/2 W 16 1/2
 " Route 270 E 161

and old sth pt agreeing with Subt Water
 Hickory 16 N 18 W 27 N 1/2

NE Sec Cor for Route S 77 E 5-8
 " down N 79 E 46

Stone at corner set by former survey
 all agreeing with Subt Water

N 1/4 Sec Cor Reestablished in line
 S 1/4 " " " by Kenyon 1890