

Sec 6 Town 17 Range 3 W

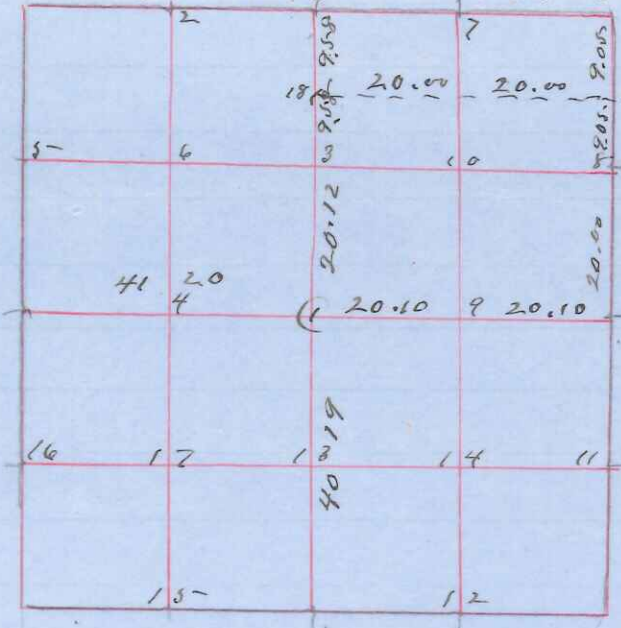

Survey made May 10<sup>th</sup> 1910  
 by Fred A. Holder and C. W. Keach

NE Sec Cor 130 10 N 50 E 80 Stone  
 120 12 N 59 W 46 Stone  
 120 12 N 15 E 26 "  
 200 10 S 54 W 115 " Stone at corner

N 1/4 Stone in road verified by Town  
 of NW Banning

- 18 # 8 Stake
- 26 # 18 Stake
- 27 # 19 "

S 1/4 Stone in road verified by  
 Bro 10 N 26 E 107  
 E 1/4 Bro 8 N 40 E 72 Stone  
 " 8 S 44 W 44 Stone  
 " 12 N 80 E 27 Stone  
 Set drive well point  
 Stone at corner verified  
 W 1/4 by Bro 5 N 85 W 134  
 Bro 1 N 20 E 75

C Stake at intersection of street 1/4 line  
 I hereby certify that the above diagram and  
 field notes are correct of the Partial Survey  
 of Sec 6 Town 17 N Range 3 W as Surveyed  
 by direction of F. S. Rich  
 dated this 12<sup>th</sup> day of May 1910

Fred A. Holder  
 Surveyor Monroe Co Wis