

Sec 2 Town 16 Range 4 W

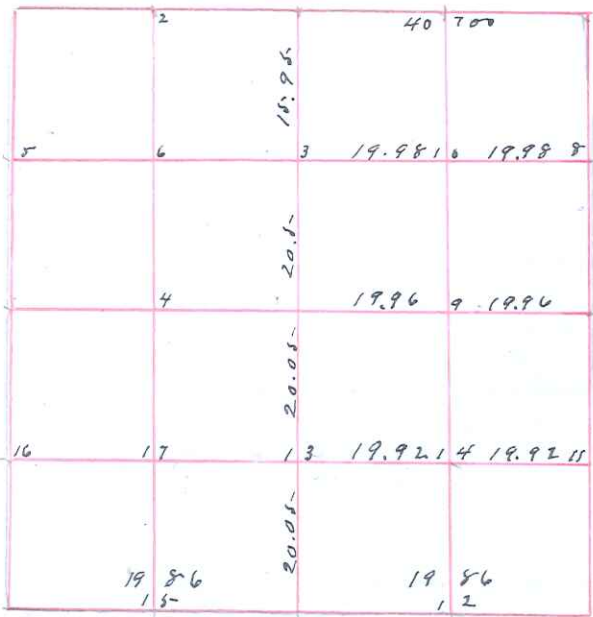

Survey made Nov 23 + 24 1909  
 Survey assistants

Chairmen

Ben Lee  
 Cyrus McCumber  
 Haysman Ed Gantke & others

N.E. Sec Corner

Original - Iron Stake

- NW " " Not touched  
 RR Iron at Corner placed from
- SW " " Original Bearings by Kenyon 1885  
 Reestablished and per rule from identified
- SE " " Corner  
 Set Iron nail at old corner
- N 1/4 " " Original  
 Bro 5-S 16 1/2 E 67  
 Jo 6 North 5-3 1/2  
 Reestablished in line set 1 in Iron pipe
- S " " " Cherry 2 1/2 N 65 1/2 W 38 1/2  
 Reestablished in line
- E " " " 1 in Iron pipe at corner
- W " " " Not touched
- C Set Iron pipe at corner  
 Bro 18 S 43 E 64 1/2
- # 3 3/4 Pipe at corner  
 Bro 12 S 23 W 20  
 Iron pipe at corner
- # 8 Jo 4 N 65 E 5 1/2
- # 9 Iron pipe at corner
- # 12 Bro 16 S 84 W 38  
 Iron pipe at corner
- # 13 Bro 18 N 28 1/2 E 83
- # 14 Jo 6 S 88 1/2 E 22

I hereby Certify that the above Diagram and field notes  
 are correct of the survey of the E 1/2 of Section 2 Town 16  
 North Range 4 West as surveyed by direction of Ben  
 Lee and others dated this 3rd day of January 1910

Paul A. Holder

Surveyor Marshall County Wis