

Sec 30 T 17 R 2 W

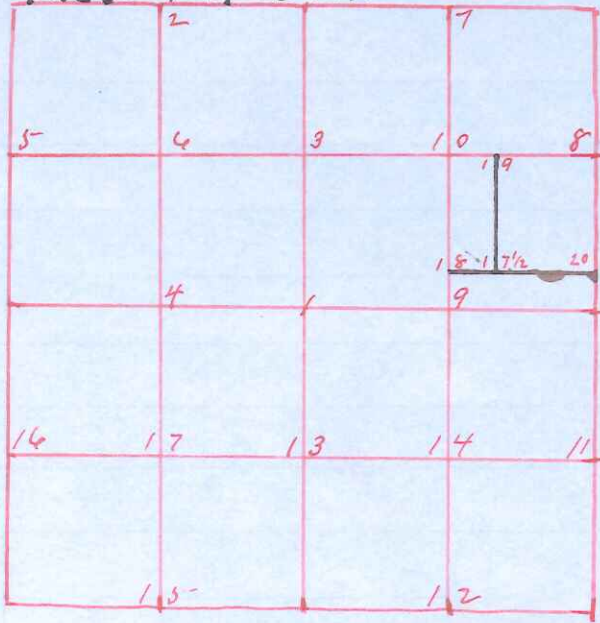

Survey made April 21st 1907
by direction of J. W. Williams
Sworn Assintants

Chainmen
J. W. Williams
Steve Harrington

Flagman
John A. Jones
Nathan Hall

Field Notes

- N E Sec Cor set for distance W + S 1 1/2 in pipe at corner
- S E " " Original corner
- E 1/4 " " Stake
- N 1/4 " " "
- # 7 Br 0 6 N 70 1/2 E 10 1/2
- # 8 10 8 S 43 1/2 E 21
- # 11 12 12 N 5-3 90 13
- # 14 10 10 N 80 E 55-
- # 17 1/2 26 Br 0 10 N 73 E ~~61~~ 61
- # 18 27 Br 0 20 N 70 1/2 E 46 1/2
- # 19 28 12 12 S 47 E 103
- # 20 29 Stake

Recorded Oct 24th 1908

Paul A. Holders

Co Surveyor