

Sec 28 towns 16 R 2 W

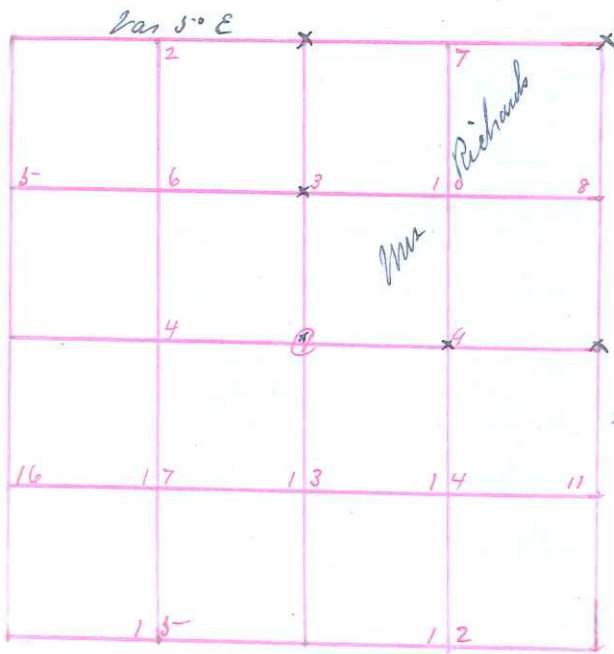

Office County Surveyor
Monroe Co Wis

Survey Made June 1904
Lines run by both line & third sights
all random lines corrected
set Center Post of Sec on Strait NOS
1/4 Line & Equidistant

NE Sec Corner Jo 14 S 56 W 28
do 12 S 22 E 8

N 1/4 Original No 10 N 46 W 24

do 10 S 16 E 17 1/2 one B tree standing badly decayed

S 1/4 one Original tree still standing

E 1/4 Original corner maintained by Mr Richards ^{old State Pt} Potted Toward

C Jo 14 S 75 W 44 Set Iron Pipe at corner

#3 Stake at corner

#9

I hereby certify that the above diagrams and field notes
are correct of the Partial Survey of Sec 28 towns 16 R 2 West
as surveyed by direction of Mrs Richards
dated this 13th day of September 1904

Frederic A. Holder
Co Surveyor Monroe Co Wis