

32 <sup>Weg</sup> 8/5/82  
 Sec 36 lower 15 N  
 Range 1 East

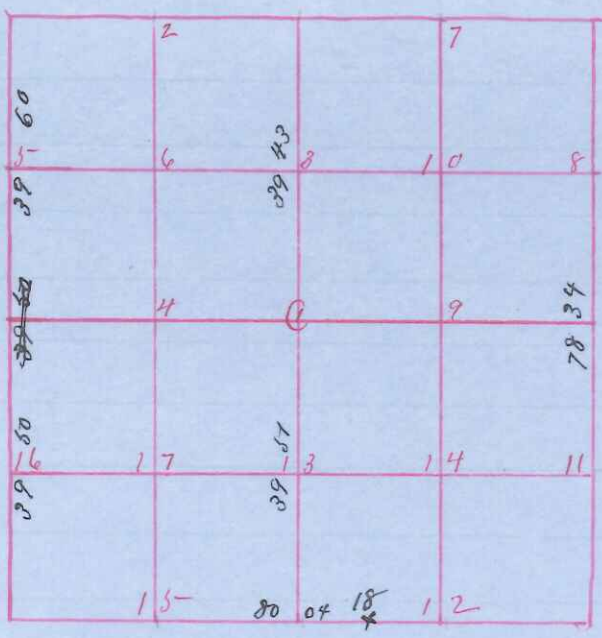

Office of County Surveyor  
 Monroe County Wis  
 Survey made May 26<sup>th</sup> 27<sup>th</sup> + 28<sup>th</sup> 1904  
 Lines run by fore and hind sights  
 all random stakes corrected  
 Chairman

Mr Matt  
 Peter Thouson  
 & B Curtice

Flagman

Hans Thouson  
 Tom Bailey  
 Ben Thouson

- Field Notes
- NE Sec Corner Original New Tree Willow 14 N 85 E 53 1/4  
 by Remain of old bearings & Old Stake in highway E Bailey
  - NW " " by remain of all bearings & Old Stake in highway E Bailey  
 Original Red 10 S 37 1/2 E 48 1/4  
 No old N 22 E 18
  - SW " " by old bearings from at corner  
 Original Red 10 S 39 E 12
  - SE " " Old Stake at Plain Hickory 10 S 38 W 56 Set from Pipe  
 Original all Stake at bearings Red 10 S 16 N 24 E 31 - Red 10 S 12 S 3 E 11
  - N 1/4 " Set Stone 16 x 8 x 12 + Ink
  - S " " Original  
 Set 3/4 Pipe in all stake hole
  - E " " Reestablished in line  
 Set 3/4 in Pipe
  - W " " Original Red 10 S 18 N 79 W 19  
 No " 28 N 22 E 36 Set from Sleigh Stake 2 ft long
  - C Angle from at corner
  - #2 1/2 in from 20 in long
  - #3 3/4 in rod 5 ft long at corner
  - #4 Piece Sleigh Stake at corner
  - #5 1/2 in from rod
  - #6 Piece Sleigh Stake 2 ft long
  - #7 1 in from rod
  - #8 " " "
  - #9 Angle from at corner
  - #10 1 in from rod
  - #11 3/4 in Pipe at corner
  - #12 from batt
  - #13 angle from
  - #15 Stake
  - #16 Stone hollow drilled in top
  - #17 Stake
  - #18 from bar 2 ft long Eyebolt N 87 1/2 W

I hereby certify that the above diagram & field notes are correct of the  
 Survey of Sec 36 T 15 N R 1 E as surveyed by direction of E Bailey others  
 about this 6<sup>th</sup> day of February 1905 -  
 Paul A. Holder  
 Co Surveyor Monroe Co Wis