

Sec 8 town 15  
range one west

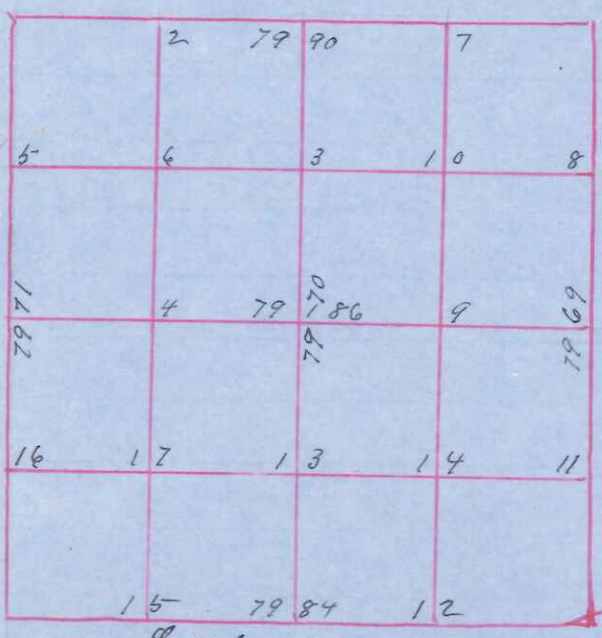

Dec 4° 30' E

State of Wisconsin  
County of Monroe  
I Paul A Holden Surveyor in and for County  
and State aforesaid do certify that I have  
surveyed and subdivided sections 8  
town 15 Range one west <sup>done</sup> in accordance with  
State Laws and the Field notes of Orig-  
inal Govt Survey  
Dec 11-12-13-15 & 16<sup>th</sup> ad 1902

Field notes

- SW Section corner Stake B Tree by Ingalls
- Original NE " new run Bass wood 11 S 56 1/2 E 180 Original hick tree south 10 rods 10 links
  - " SE " " Two Stump 24 N 35 W 19 Original B tree 2 old stake points
  - " SW " " Fence Post placed where original corner was Basswood 14 S 48 E 62 Chaining from town line one west again perfect with 8 field notes
  - W Stake nailed to Sugar maple Muld W 05-617 E 11
  - W 1/4 " " 1/2 in Iron rod at corner 70 10 West 50
  - " E 1/4 " " W Pine 10 S 2 E 37 Elm 10 N 17 W 6 1/2
  - " S 1/4 " " Ironwood 6 S 31 E 5-
  - " W 1/4 " " W 12 S 58 1/2 E 8

Subdivisions corners

- Sub # 1 Stake at corner
- " 2 1/4 in Iron Rod
- " 3 Stake at corner
- " 4 " "
- " 5 W Pine 8 S 54 E 68 1/2 W 10 N 81 E 45-
- " 6 Stake
- " 7 W 20 S 70 1/2 E 65-
- " 8 Stake
- " 9 " "
- " 10 " "
- " 11 " "
- " 12 " "
- " 13 " "
- " 14 " "
- " 15 W Pine 18 N 73 W 24
- " 16 Elm 16 S 43 E 45 1/2
- " 17 Stake

- Sworn Assistants  
Chairmen
- James Minton
  - Thomas Barry
  - Flagmen
  - Ray Quinn
  - Henry Green
  - Witness
  - Thomas Kelch
  - James Barry

Witness my hand this 20<sup>th</sup> ad 1902  
Paul A Holden  
Geo Surveyor