

Section 24 Town 17
Range 4 West

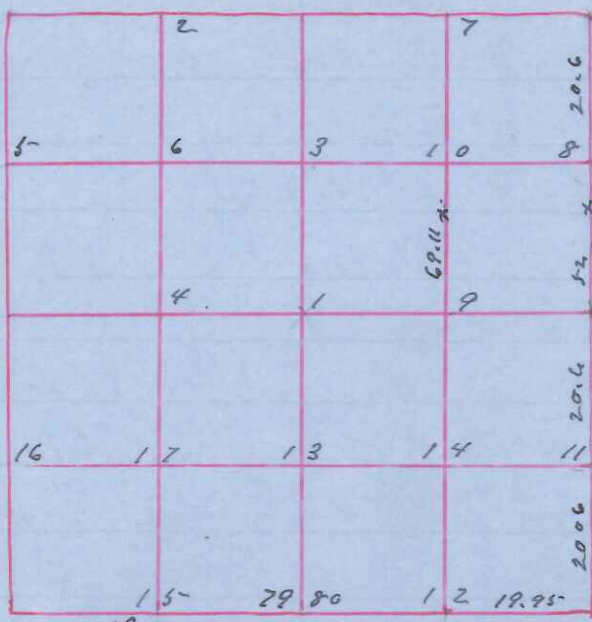

State of Wisconsin
County of Monroe J.B.B
I Paul A Holder Surveyor in and
for County and State aforesaid
do certify that I have surveyed
a part of Sections 24 Town 17
Range 4 West done in accordance
with State Laws and field notes
of Original Govt Survey
Aug 14th & 15th ad 1902

Sec 5.30' E

Field Notes

- Original N & W Sec Cor From Stake under side walk E side Water St
- Relatd NE " " " " at corner
- " SE " " 308 S 12 W 47
- Original SW " " Stake Center Highway
- N 1/4 " " in perch Lake angle from south 31 rods 13 links
- E 1/4 " " Paper & S 11 1/2 W 13
- S 1/4 " " Stone x MK
- W 1/4 " " Stake
- Stone at corner center Highway

Subdivision Corners

- # 8 1/2 Iron Pipe at corner
- # 9 Stone x MK at corner
- # 11 " " " "
- # 12 Iron Stake " "
- # 14 Stone x MK
- 26 " 18 " " "
- 27 " 19 Stake at Point

Sworn assistants

George Esch
Bill A Holder

Witness my hand this 15th day of August 1902
Paul A Holder
Co Surveyor