

Survey & Subdivisions of Sections 26 township 15 Range 1 West

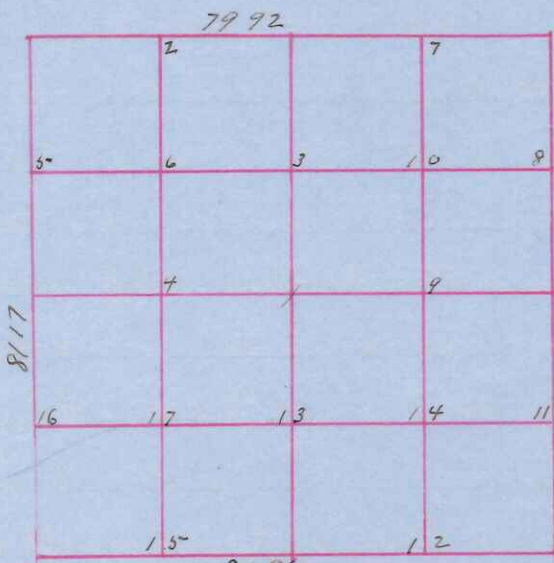

State of Wisconsin) I Paul A Holden
 Monroe County JSS Surveyor in and for
 the County and State aforesaid do hereby
 certify that I have surveyed and subdivided
 sections 26 township 15 North Range one
 West of the 4th principal Meridian as represented by annexed plat & field notes of
 survey Established the Centers of the sections
 at the point of intersection of straight quarter
 lines Established all quarter quarter corners upon the sections boundary
 at proportional distances between known sections and quarter section
 corners according to the original field notes of the Government survey
 Established all lost corners at proportionate distances between
 known corners according to original field notes of the Government
 survey " declinations of Magnetic Meridians from true Meridians
 5° East surveyed and subdivided April 4th 5th 6th & 8th ad 1901 in
 accordance with the state laws and instructions of the Commissioner
 of the General Land office and recorded this 15th day of April
 ad 1901

Paul A Holden Co Surveyor

- Field notes of above sections
 Plat at Cr
 NW Sec Cor Red 0 485 2 1/2 W 43
 NE " " 200 14 N 64 E 8
 S.E. by testimony of old settlers
 One original tree found
 SW Sugar 10 N 20 E 33
 Red 0 8 S 49 E 52
 N 1/4 Linden 6 S 35 W 8 1/2
 Butnut 8 N 4 1/2 W 10 6
 E 1/4 Elm 10 N 75 W 96 1/2
 Elm 6 N 67 1/2 W 48
 S 1/4 Maple N 72 1/2 E 23
 Sugar 7 N 83 W 31 1/2
 W 1/4 Sugar 4 N 42 1/2 48
 Center #1 Runwood 4 N 62 1/2 E 5
 4 S 10 W 18
 # 2 Sugar 10 S 33 E 5 1/2
 Sugar 10 N 31 W 6 1/2

- # 4 Sugar 4 N 21 E 26 1/2
 Red 0 7 N 46 W 26 1/2
 # 5 Red 0 2 S 47 E 24 1/2 - Runthistle at Corner
 # 7 Sugar 12 South 83
 Elm 10 N 9 E 38
 # 9 Red 0 12 N 38 W 42
 Butnut 10 S 26 1/2 E 29 1/2
 # 11 Sugar 12 S 37 W 62 1/2
 Maple 4 N 21 1/2 W 88
 # 12 Maple 8 N 45 E 29 1/2
 # 13 Iron bar at Corner
 # 15 Maple 12 N 68 W 34
 # 17 Iron bar at Corner

Name of Survey Assistants

- | | | |
|-----------------|----------------|--------------|
| Chairman | Flagman | Recorder |
| A. Whiting | Otto Schnell | Ford Lunker |
| S. Riko | M. M. Champlin | F. Bauwald |
| Morris Champlin | Ford Lunker | Frank Thayer |