

Survey & Subdivisions sections 14 township 17 North Range one East of 4th principal Meridian

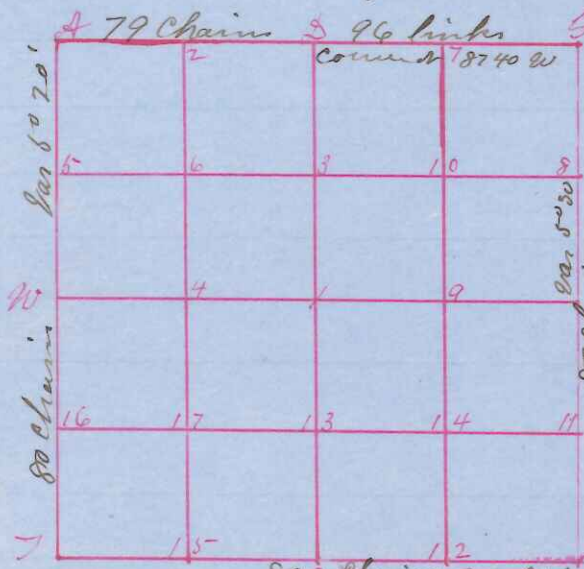

State of Wisconsin }
County of Monroe }

I Paul A Holden

Surveyor in and for county & State
aforesaid do hereby certify that I
have surveyed and subdivided
sections 14 township 17 North Range
one East of 4th principal Meridian

as represented by annexed plat &
field notes of survey established centers of sections at point
of intersection of straight quarter lines established all quarter
quarter corners upon the sections boundary at proportionate
distances between known sections & quarter sections corners
according to original field notes of Government survey
established lost corners at proportionate distances be

tween known corners according to original field notes of Government
survey declination magnetic Meridian 5° 30' East done Feb 20th
21st & 22nd ad 1901 recorded and certificates issued
March 7th ad 1901 Witness my hand

Field Notes as follows:

Paul A Holden

Co Surveyor

NW Sec corner	Janais 12 N 77 E 54	N 1/4 Sec Cor	808 North 5 1/2
	W Maple 9 S 4 1/2 W 17		604 " 16 E 22
NE " "	Turn Bar at Corner	E " "	Turn bar at Corner
SE " "	" " " "	S " "	" " " "
SW " "	90 S 62 1/2 E 61	W " "	" " " "
	70 6 N 48 1/2 W 123		" " " "

at # 1 Turn bar at Corner
" # 2
" # 3
" # 4
" # 5
" # 6
" # 7
" # 9
" # 10
" # 12
" # 13
" # 15
" # 17

Sworn assistants

Chairman	Charles Rabe
	Nels Hansen
Flagmen	Robt Peterson
	John Garland
Recorder	W Huggard