

Sec 19, 216, 3rd

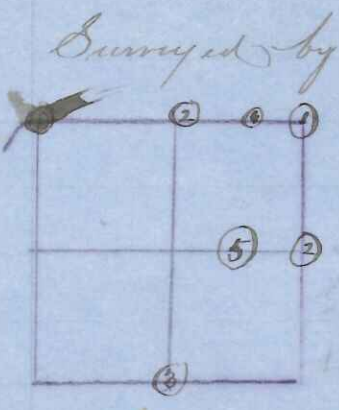

Surveyed by S. A. Holden the 12th day of Dec 1899

- at (1) Corner identified (Survey of LaRue)
- " (2) " " made new Bearing f. 0. 20 S 53 E 34 f. 0. 19 N 37 1/2 W 77
- " (3) " " Run Oak 6 N 63 E 26 other line gone
- " (4) " " Jack Oak 15 S 61 E 362
- " (5) " " Run Oak 18 W 7 N 402. Pr Oak 18 N 7 W 360

Recorded this 9th day of June A D 1900
 Hamilton LaRue
 C. Surveyor

Sec 31, 515-1st

Surveyed and subdivided Sec 31. Town 15 R 1 W Apr 8, 9th in Walker, Gordon Bros. Boring. Well-located and others and restored old corners and established new as shown on Plat.

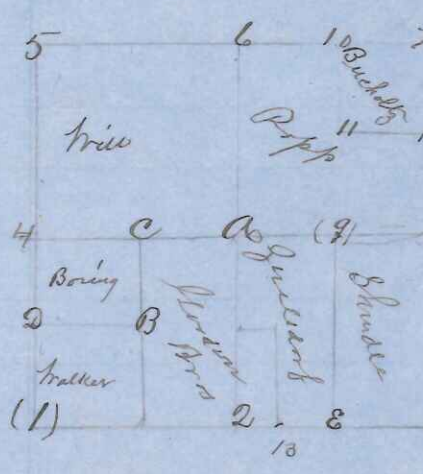

- at 1 Corner marked and has been kept in remembrance by all the old settlers. B Saw gone. Made new Bearing a
- at 2 8 Maple 14 S 66 W 54
- " " 8 S 51 E 49
- at 3 Linden 14 S 11 1/2 E 12
- " " Elm 15 N 67 W 11 (broken down)
- " " (Pheny 15 N 55 E 31 (Stump remains)) O. B
- " " 4 8 Maple 14 S 66 W 55 Suts
- " " 5 Linden 14 N 71 E 39. + Elm 12 S 19 E 40
- " " 6 Old B. Sugar Maple 10 N 33 E 13.
- " " Sugar Maple 12 N 46 W 82
- " " 7 Red Oak 7 N 56 W 59. + 8 Maple 12 N 70 E 79
- " " 8 Red Oak 8 S 35 E 66 + Maple 14 S 72 W 26
- at A W. oak 8 N 76 W 144 + W. oak 7 S 77 E 54 1/2
- " B Butternut 15 S 77 1/2 W 44. at C Maple 6 N 82 W 19
- " D Hickory 6 N 16 1/2 W " E Maple 14 S 40 1/2 E 22
- " 9 Butternut 8 S 81 1/2 W 151 " 10 W oak 7 South 72 1/2
- " 11 Butternut 4 N 22 E 48 " 12 Double Linden 16 W 27 W 29 1/2
- " 13 Maple 16 N 64 1/2 E 6 Suts

Recorded this 9th day of June 1897
 Hamilton LaRue
 C. Surveyor