

Sec 32  
Town 19 - 3 Tr

Retrace the following lines for Wm Stanley on this 30 and 31<sup>st</sup> days of March 1897. First found magnetic variation from two known points then commencing at S E corner of Sec 32 on Town Line, thence East 80 rods set 1/8 post. thence South 80 rods and set 1/4 post. Bearing line and post gone thence on same bearing and direction 80 rods and set 1/8 post. thence 80 rods to section corner.  
Commenced at 1/4 post on Town Line between Sec 5 T 19, 3 Tr + Sec 32 Town 19 3 Tr. Variation 4° 30' South 42 rods 16 1/2 links set 1/8 post.  
Commenced at S E corner of ~~5<sup>th</sup>~~ Sec 32 thence S on variation 4° 30' 44 rods and 3 2/3 links and set 1/8 post. Commenced at 1/4 post on Town line 80 rods west of S E corner of Sec 32 thence South 42 rods + 33 1/2 links  
Commenced at 1/4 post on Town line of Sec 32 T 19, 3 Tr Variation 6° 26' North 80 rods set 1/8 post. thence True variation 6° 80 rods set 1/8 post  
Then commencing at S E corner of Sec 32 variation 6° 18' thence 80 rods north and set 1/8 post.

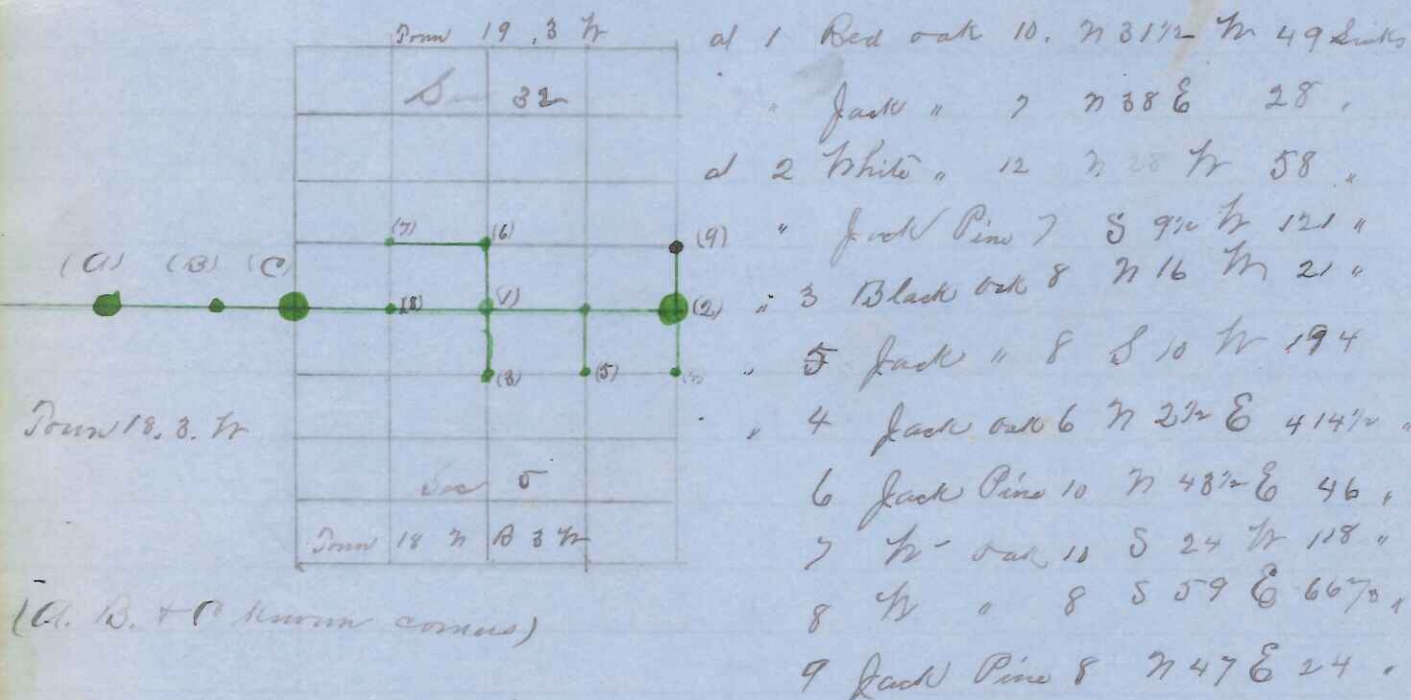

Witness my hand officially at Nelson this 31<sup>st</sup> day of March 1897  
Hamilton La Rue  
C Surveyor