

said Sec: owned by Mr. Maloney. The SW $\frac{1}{4}$  of SW $\frac{1}{4}$  & the NW $\frac{1}{4}$  & the NW $\frac{1}{4}$  of NW $\frac{1}{4}$  of SW $\frac{1}{4}$  of Sec: owned by Mr. George Bushman. The E $\frac{1}{2}$  of SW $\frac{1}{4}$  & the SE $\frac{1}{4}$  of SW $\frac{1}{4}$  owned by Mr. Peter Pier. The SE $\frac{1}{2}$  of NE $\frac{1}{4}$  & the N $\frac{1}{2}$  of SE $\frac{1}{4}$  owned by Mr. A. Manning. The E $\frac{1}{2}$  of SW $\frac{1}{4}$  of SW $\frac{1}{4}$  owned by Mr. Crape. The SW $\frac{1}{4}$  of SW $\frac{1}{4}$  of SW $\frac{1}{4}$  owned by Mr. Thoburn. The NW $\frac{1}{4}$  of SW $\frac{1}{4}$  owned by Mr. Crocker all in Sec: 12 town 18 R 2 West.

The proceedings will be observed from the Diagram and Remarks below

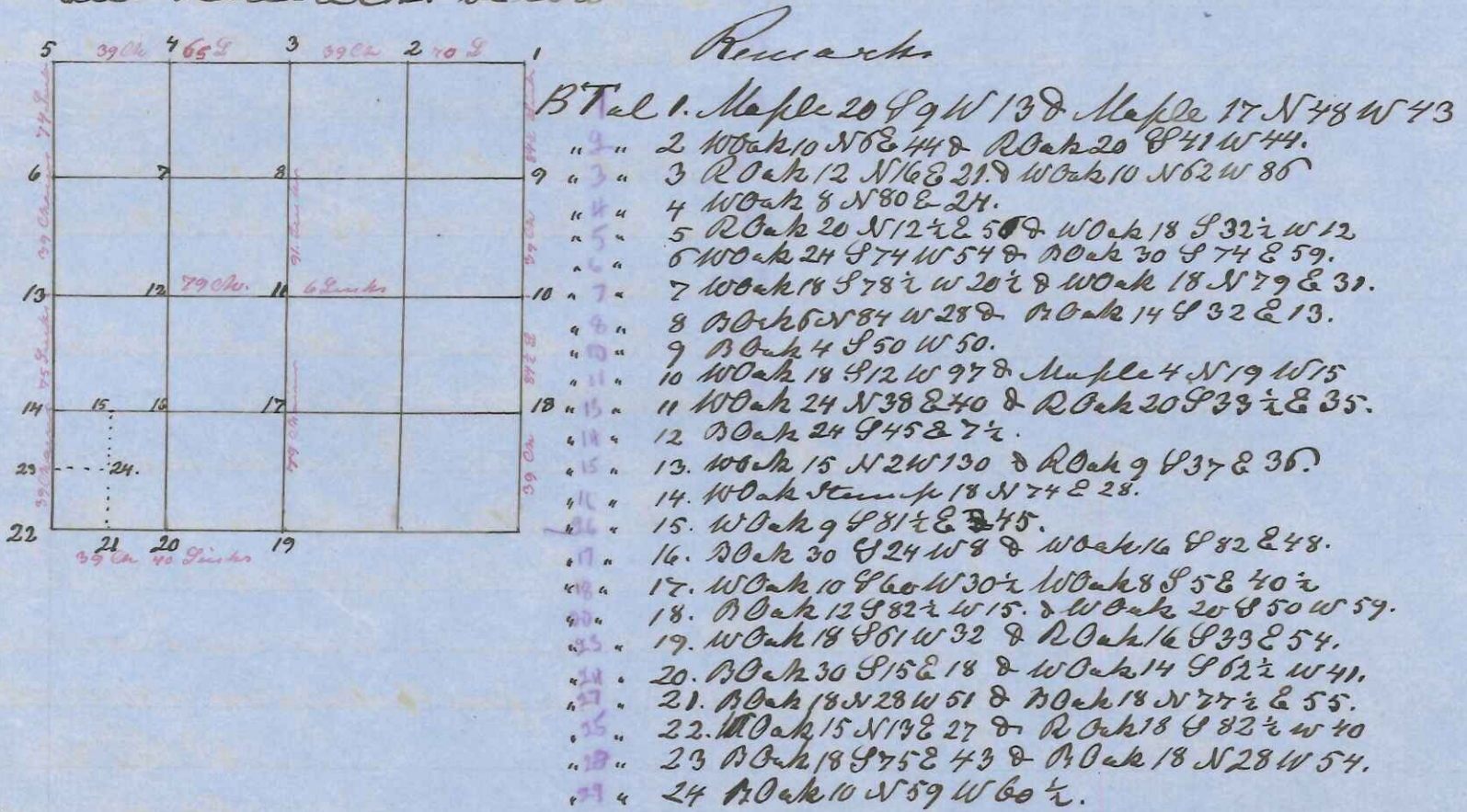

Attention on the E & W Line on the North side to other Lines 8°. The gov: corner was adjusted after the field notes and the distance between them carefully measured and equally divided between each joining Lot.

Thereby certify that the proceeding is correct as stated and that the Maaninen was sworn according to Law

Ol. Dahl

Year A. D. 1870 on the 15<sup>th</sup> day of April a survey was made by me on the E $\frac{1}{2}$  of SE $\frac{1}{4}$  of Sec: 11 town 18 Range 2 West by request of the owner of the same Mr. John Hartwell. The particulars of said survey will be observed from the following Diagram & Remarks.