

Be it remembered that on the 3<sup>d</sup> & 3<sup>m</sup> day of December 1870 I was surveying the SE 1/4 & the NW 1/4 of SE 1/4 & the SE 1/4 of SE 1/4 of Sec. 30 Town 16 Range 1 East by request of the owners of said Land namely Ole Johnson as owner of the NW 1/4 of SW 1/4 John Dwyer the SW - south West 1/4 of SE 1/4 and the SE 1/4 of SW 1/4 Halvor Johnson the NE of SW 1/4 Halvorson the NW 1/4 of SE 1/4 and W. Packey the SE of SE 1/4 said sections and the result of the proceedings is found below in the diagrams and remarks.

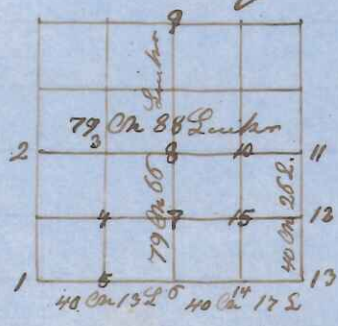

- Remarks.
- Bearing tree at 10 Oak 18 N 25 W 110 10 Oak 18 N 55 E 68
  - 15 2 Br Oak 8 S 88 E 43 & Br Oak 9 N 18 E 150
  - 14 3 Br Oak 4 S 63 E 98 no other tree near
  - 17 4 W Oak 6 S 85 W 53 & W Oak 12 S 11 E 145
  - 14 5 W Oak 6 N 85 E 68 no other tree near
  - 23 6 W Oak 10 N 32 E 53 & Br Oak 8 S 2 W 329
  - 18 7 W Oak 16 N 88 W 225 no other tree near
  - 13 8 W Oak 18 S 44 W 85 & W Oak 14 N 65 W 105
  - 6 9 Br Oak 10 N 15 E 27 & W Oak 10 S 1 E 23
  - 12 10 W Oak 8 N 32 W 92 & Br Oak 6 N 60 E 66
  - 11 11 W Oak 16 S 45 W 35 & W Oak 12 S 28 E 91
  - 12 12 Br Oak 16 N 37 1/2 E 75 Stone for a corner
  - 11 13 W Oak 12 N 55 W 180 & W Oak 12 N 11 E 180
  - 12 14 W Oak 10 N 39 W 18 & W Oak 8 S 40 W 12
  - 19 15 W Oak 8 N 21 1/2 E 3 & W Oak 8 N 62 W 22

The gov. corners was adjusted after the field notes the chain was sworn according to law.

Variations on the E & W line 11 1/2° and on the North & South lines 7 1/2°. 4 Rods chain was used.

I hereby certify that the proceedings is correct as stated.  
Ole Dahl

Be it remembered that on the 8<sup>m</sup> day of December 1870 I was surveying the NW 1/4 of Section 19 Town 17 Range 1 West by request of Mrs. Charles O. Reynolds the owner of said Land the result of the proceedings will be observed from the therefore noted Remarks & Diagrams.