

U. S. Public Land Corner Maintenance

77

Corner: E1/4 Sec. 21, T16N-R1E

41601212000

Date	Crew	Monument type
January 29, 2024	Zachariah P. Dechant Gary L. Dechant	Found Harrison intact, sign west side of Harrison, 100' west of fence corner
1) Set 1"x24" iron pipe, north side of 3'x3' stone		
2) Set 1 1/4" x 2 1/2" iron pipe east side of 2'x4' stone		
3) Set 1"x3' iron pipe, north side of 1'x7' stone		
4) Set 1"x3" iron pipe, east side of 3'x3' stone		

Compass bearings



I, Bryan H. Meyer, do hereby certify that on the 21st day of November 1985, I found ~~evidence~~ (no evidence) of the East 1/4 corner of Section 21, T 16 N, R 1 E Fourth Principal Meridian, and I re-established said corner according to the Wisconsin Statutes as shown and described hereon.

Dated this 22nd day of Nov. 1985.

Bryan H. Meyer
Deputy County Surveyor
Title

History of corner establishment since Original Government Survey

Nothing recorded.

See Reverse Side For Maintenance



Description of corner evidence found:

I set this corner on line between the Northeast and Southeast corners of Section 21 and on line with a portion of fence from the East. I could not accept the occupied fence corner as there would have been a 4 1/2°+ bend in the East line of Section 21. Also the E-W 1/4 line of Section 22 would have been 78 1/2'+ short, while the E-W 1/4 line of Section 21 would have been 169'+ long (both prorated to the Original Government Notes). After establishing the East 1/4 corner, I set the E1/16SE corner of Section 21 and found that it fell about 90'+ East of the N-S fence. Using the occupied East 1/4 corner would (continued on the back)

Description of corner and witness monuments, references and accessories used to perpetuate the original or re-established location of this corner:

Crew: Meyer, Sime
Date: November 21, 1985 - 10:30 A.M.
Weather: Partly Cloudy, +10°F.
Witnesses to corner location:

Bryan H. Meyer

Gary Sime

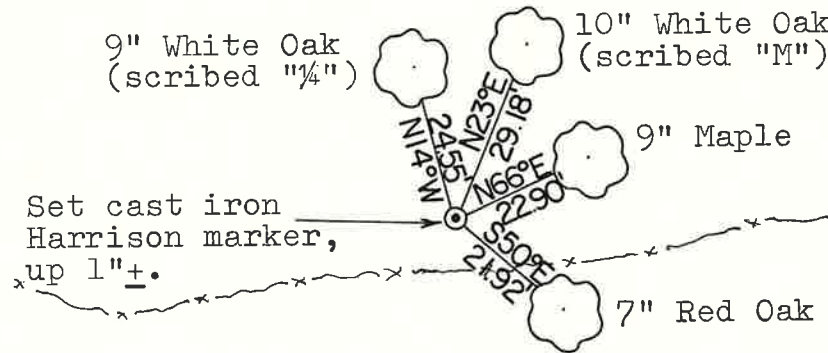

Note: The 4 trees shown are double blazed; each distance shown is to a nail set in a hack in the side of each tree. The bearings shown are magnetic hand compass bearings.

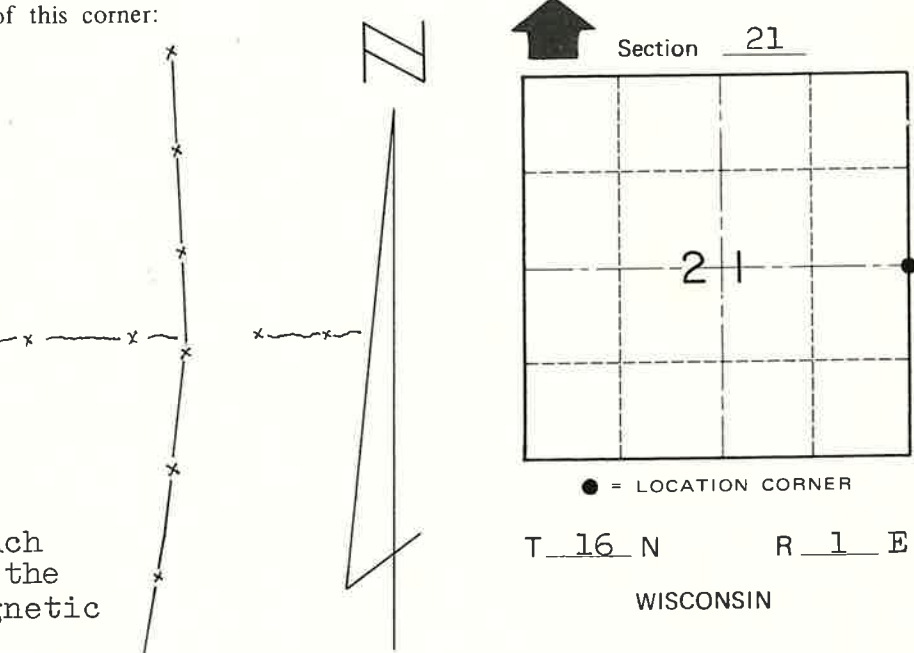

COUNTY SURVEYOR FORM NO. 1

SURVEY CONTROL ORDER

Horizontal	_____
Vertical	_____

WISCONSIN COORDINATE SYSTEM

Corner	East (X)	North (Y)	Elevation (Z)	Zone
Control Sta. Name				

~~City, Village or~~ Town of Clifton
County of Monroe