

U. S. Public Land Corner Maintenance

#113

Corner: NW Sec. 31, T18N-R1W

21802250000

Date	Crew	Monument type
March 21, 2024	Zachariah P. Dechant Gary L. Dechant	Found Stone (+), sign on east side The stone is now split in half.
1) Set 5/8"x24" rebar, 5' SW of 18" White Pine		
2) Set 5/8"x24" rebar, 4' west of 10" Black Cherry		
3) Set 5/8"x24" rebar, 6' NW of 12" White Oak		
4) Set 5/8"x24" rebar, 4' SE of 6" Red Oak		
Trees double blazed		
Compass bearings		

Bearing	Distance
N35E	30.25'
East	29.90'
S44E	25.37'
N9W	21.90'

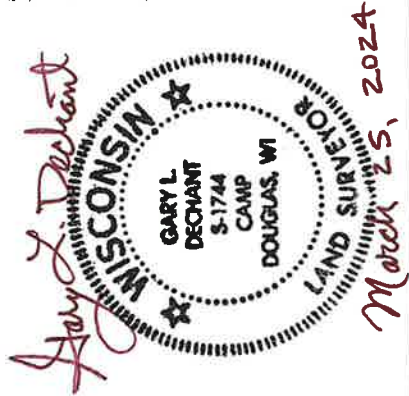

I, Harley Sime, do hereby certify that on the _____ day of _____ 19 74, I found (evidence) (~~no evidence~~) of the NW corner of Section 31, T 18 N, R 1 W., Fourth Principal Meridian, and I re-established said corner according to the Wisconsin Statutes as shown and described hereon.

Dated this 17 day of March 19 75.

Harley Sime
 COUNTY SURVEYOR
 Title

History of original corner establishment:

In January of 1901 Fred Holden (County Surveyor) resurveyed Section 30 and the records show he set a stone at the NW corner of this Section. After a thorough search, however, it was found that there may have been a typographical error and the set stone was located 1 mile South at the SW corner of said Section.

Description of corner evidence found:

Found an existing stone with cross at this corner location, in good condition. This stone at the NW corner of this Section matches the Description of the stone supposedly located at the NW corner of the Section to the North.

**See Reverse Side
For Maintenance**

COUNTY SURVEYOR FORM NO. 1

Description of corner and witness monuments, references and accessories used to perpetuate the original or re-established location of this corner:

Existing 6" x 6" stone marker with a cross inscribed in the top, with accessories as follows :

Witnesses to corner location:

- SURVEY CREW
- K. Pritzlaff - Survey Crew Chief
 - D. Malliet
 - B. Jung
 - A. Lueck

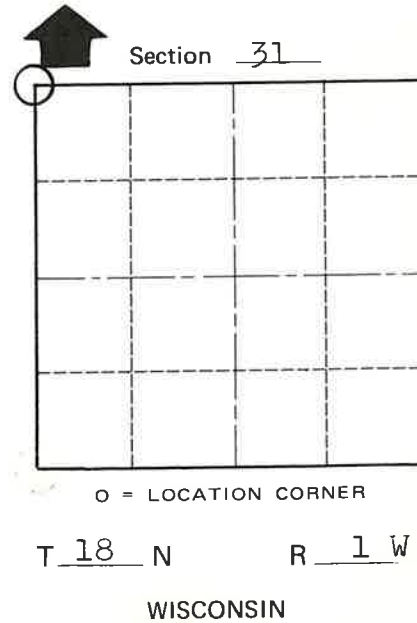
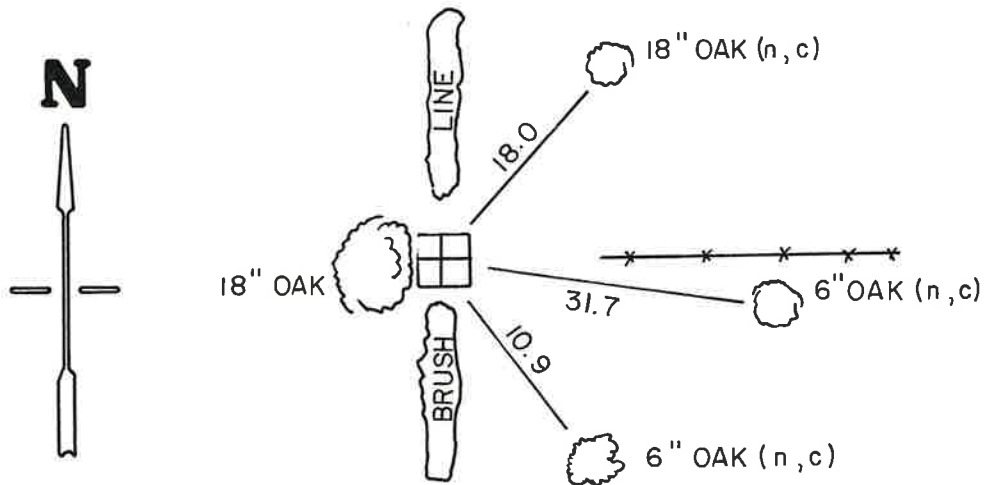

SURVEY CONTROL ORDER

Horizontal	_____
Vertical	_____

WISCONSIN COORDINATE SYSTEM

Corner	East (X)	North (Y)	Elevation (Z)	Zone
Control Sta. Name				

City, Village or Town La Grange
 County of Monroe