

**U.S. PUBLIC LAND CORNER  
MAINTENANCE**

# 67

Corner ID: SW Sec. 15, T15N-R1E  
41501160000

DATE	CREW	MONUMENT INFO
March 13, 2024	Zachariah P. Dechant Gary L. Dechant	Found Harrison, intact, in 4-way fence corner, on west side of section of power pole for fence corner post

- 1) Set 5/8"x24" round rebar, 6' SW of 9" Red Oak
- 2) Set 5/8"x24" round rebar, 4' SW of 13" Maple
- 3) Set 5/8"x24" round rebar, 4' NW of 14" Maple
- 4) Set 5/8"x24" round rebar

Compass bearings  
Trees double blazed

	<u>Bearing</u>	<u>Distance</u>
N23E		33.65'
N69E		24.57'
S70E		36.53'
N26W		29.35'

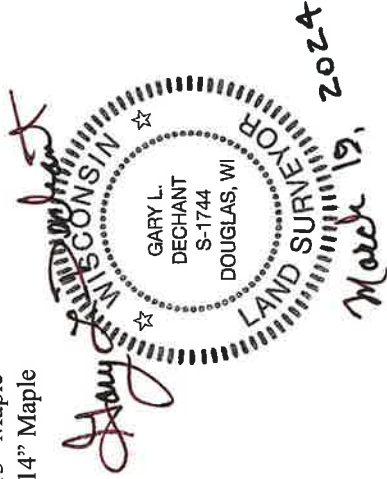

CERTIFICATE

CERTIFIED LAND CORNER

No. 67

4150160000

I, William C. Jung do hereby certify that on the nineteenth day of May 1981 I found (evidence) ~~(no evidence)~~ of the Southwest corner of Section 15, T 15 N, R 1 E, Fourth Principal Meridian, and I re-established said corner according to the Wisconsin Statutes as shown and described hereon.

History of original corner establishment:

Fred Holden found the original government corner in May of 1904.

Description of corner evidence found:

Accepted the existing occupied fence corner as the best available evidence of the original government survey and Holden's corner. This fits very well the existing field evidence found in the 4 cardinal directions going from this corner.

Dated this 31st day of Aug. 1981

William C. Jung

William C. Jung, R.L.S. 1323

Title

See Reverse Side For Maintenance

COUNTY SURVEYOR FORM NO. 1

Description of corner and witness monuments, references and accessories used to perpetuate the original or re-established location of this corner:

Witnesses to corner location:

William C. Jung

Carlton R. Pietz

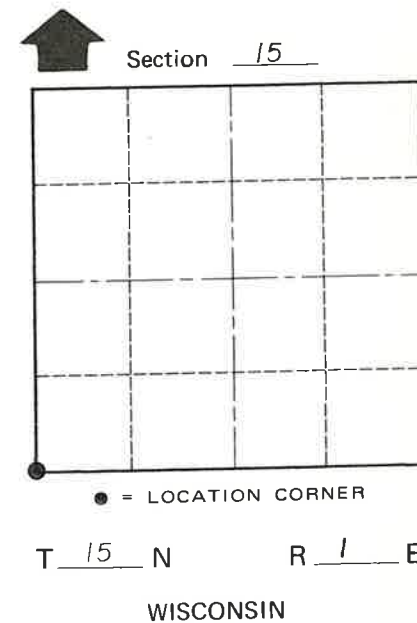
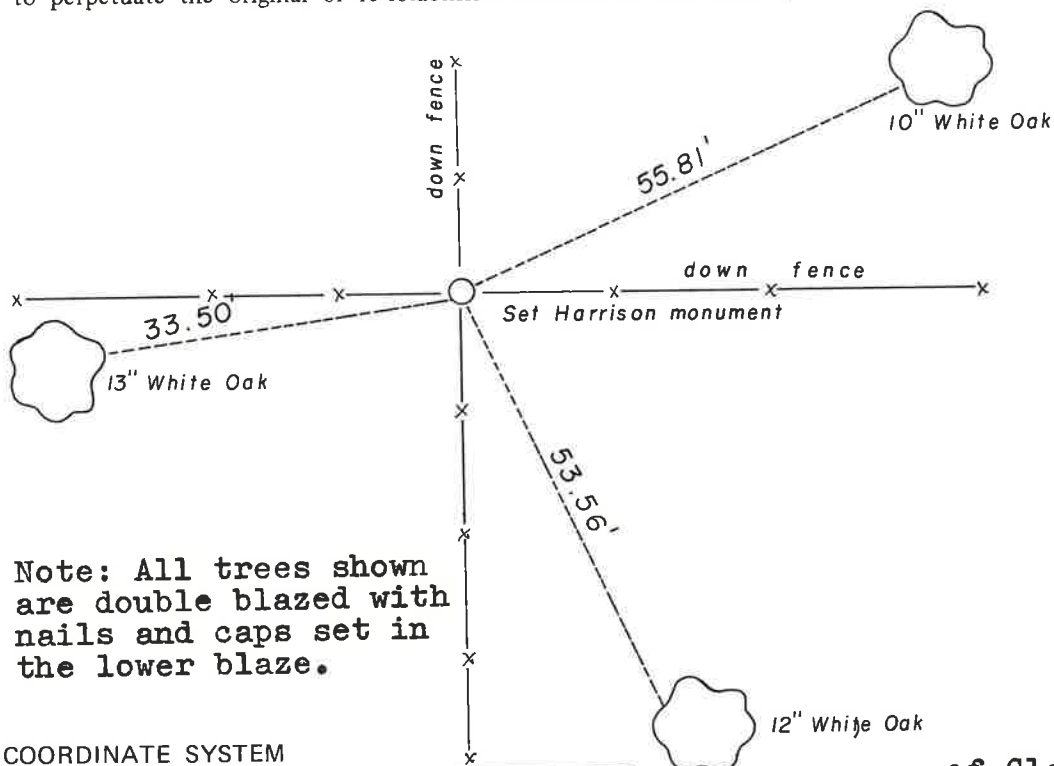
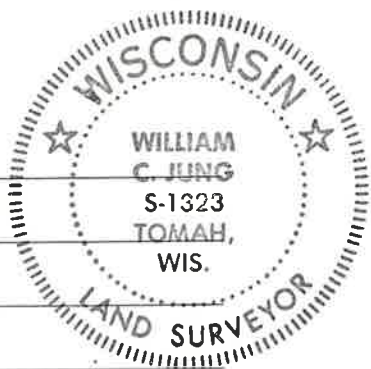

Note: All trees shown are double blazed with nails and caps set in the lower blaze.

Approved: HARLEY A. SIME  
MONROE CO. SURVEYOR

SURVEY CONTROL ORDER

Horizontal \_\_\_\_\_

Vertical \_\_\_\_\_

WISCONSIN COORDINATE SYSTEM

Corner	East (X)	North (Y)	Elevation (Z)	Zone
Control Sta. Name				

~~City, Village or~~ Town of Glendale

County of Monroe

Wisconsin

I, William C. Jung do hereby certify that on the nineteenth day of May 1981 I found (evidence) ~~(no evidence)~~ of the Southwest corner of Section 15, T 15 N, R 1 E, Fourth Principal Meridian, and I re-established said corner according to the Wisconsin Statutes as shown and described hereon.

Dated this 31st day of Aug. 1981.

William C. Jung  
William C. Jung, R.L.S. 1323  
 Title

History of original corner establishment:

Fred Holden found the original government corner in May of 1904.

Description of corner evidence found:

Accepted the existing occupied fence corner as the best available evidence of the original government survey and Holden's corner. This fits very well the existing field evidence found in the 4 cardinal directions going from this corner.

21 MAR 04 - MADE 4TH TIE *W.C.J.*

41501160000

update from Carlson

Description of corner and witness monuments, references and accessories used to perpetuate the original or re-established location of this corner:

Witnesses to corner location:

William C. Jung

Carlton R. Pietz

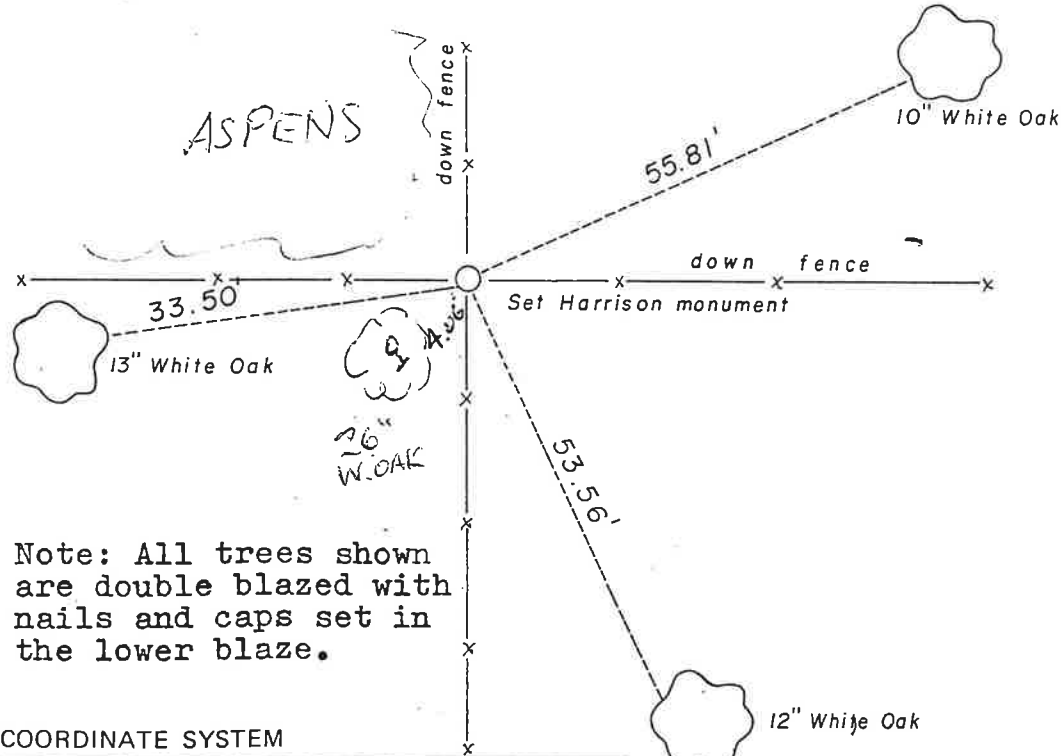
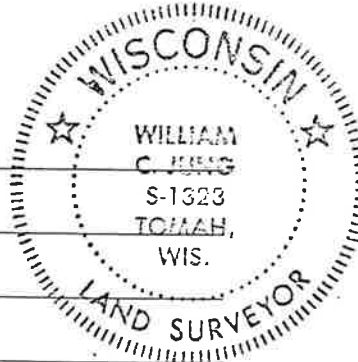

Note: All trees shown are double blazed with nails and caps set in the lower blaze.

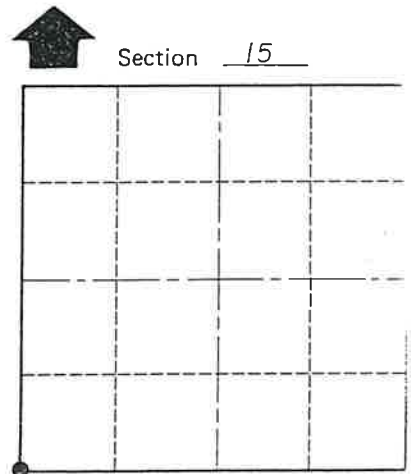

• = LOCATION CORNER

T 15 N R 1 E

WISCONSIN

COUNTY SURVEYOR FORM NO. 1

Approved: HARLEY A. SIMP  
**MONROE CO., SURVEYOR**

SURVEY CONTROL ORDER

Horizontal	_____
Vertical	_____

WISCONSIN COORDINATE SYSTEM

Corner	East (X)	North (Y)	Elevation (Z)	Zone
Control Sta. Name				

City, Village or Town of Glendale

County of Monroe

Wisconsin