

**U.S. PUBLIC LAND CORNER
MAINTENANCE**

106

**Corner ID: S1/4 Sec. 27, T15N-R1E
41501270020**

<u>DATE</u>	<u>CREW</u>	<u>MONUMENT INFO</u>										
March 13, 2024	Zachariah P. Dechant Gary L. Dechant	Found Harrison, intact, down 10" in field verified by large rotted hickory stump 1992 bearing tree in small island of trees in field										
		<table border="1"> <thead> <tr> <th><u>Bearing</u></th> <th><u>Distance</u></th> </tr> </thead> <tbody> <tr> <td>N24E</td> <td>30.36'</td> </tr> <tr> <td>East</td> <td>25.18'</td> </tr> <tr> <td>East</td> <td>22.87'</td> </tr> <tr> <td>N43W</td> <td>23.70'</td> </tr> </tbody> </table>	<u>Bearing</u>	<u>Distance</u>	N24E	30.36'	East	25.18'	East	22.87'	N43W	23.70'
<u>Bearing</u>	<u>Distance</u>											
N24E	30.36'											
East	25.18'											
East	22.87'											
N43W	23.70'											

- 1) Set 5/8"x24" round rebar, down 12" in field, on line with windmill across road
- 2) Set 5/8"x24" round rebar, down 12" in field, in line with church/school
- 3) Set 5/8"x24" round rebar, down 12" in field, on line with Hickory stump(1992 BT)S50W
- 4) Set 5/8"x24" round rebar, down 12" in field, on line with brown brick silo

Compass bearings

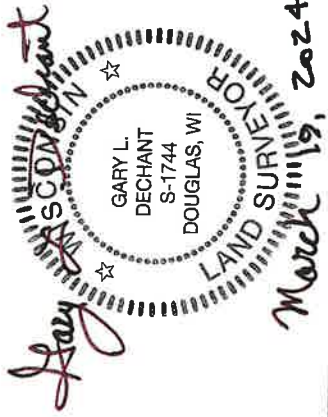

CERTIFICATE

I, Bryan H. Meyer, do hereby certify that on the 27th day of July 1992, I found (evidence) ~~no evidence~~ of the South 1/4 corner of Section 27, T. 15 N, R. 1 E Fourth Principal Meridian, and I re-established said corner according to the Wisconsin Statutes as shown and described hereon.

Dated this 10th day of Aug. 1992.

Bryan H. Meyer
Deputy County Surveyor
Title

CERTIFIED LAND CORNER

History of corner establishment since Original Government Survey
Fred Holden was here in March and April of 1904 (His notes call for "re-estab. by LaRue. Stake", so obviously LaRue was here sometime prior Holden). William C. Jung was here in May of 1981 and shows a computed location for this corner.

Description of corner evidence found:

I set this corner at Mr. Jung's computed location.

See Reverse Side For Maintenance

No. 106

41501270020



H. A. Sime and Associates
P. O. Box 705
Tomah, Wisconsin 54660
Phone: (608)-372-5392

COUNTY SURVEYOR FORM NO. 1

Description of corner and witness monuments, references and accessories used to perpetuate the original or re-established location of this corner:

Crew: Meyer, Kenworthy, Kostka
Date: July 27, 1992
Weather: P. Cloudy, 75±.
Witnesses to corner location:

Bryan H. Meyer
John F. Kenworthy
Brent Kostka

- ⊙ = Set T.C.P. marker, down 10"± in field.
- = Set 1 1/4"x24" iron pipe, flush
- △ = Set railroad spike on North edge of blacktop
- ⊙ = Set nail in NW side of 18" Shagbark Hickory
Set sign next to tree

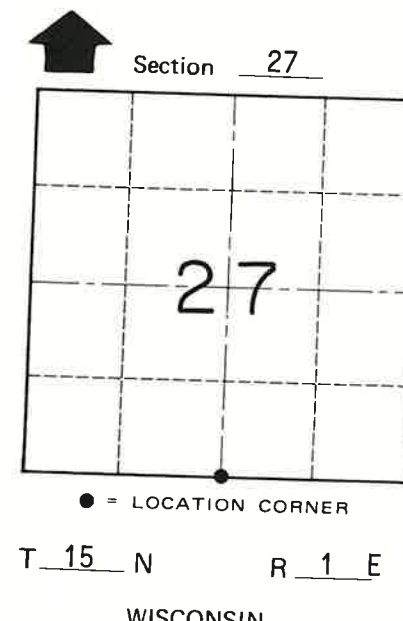
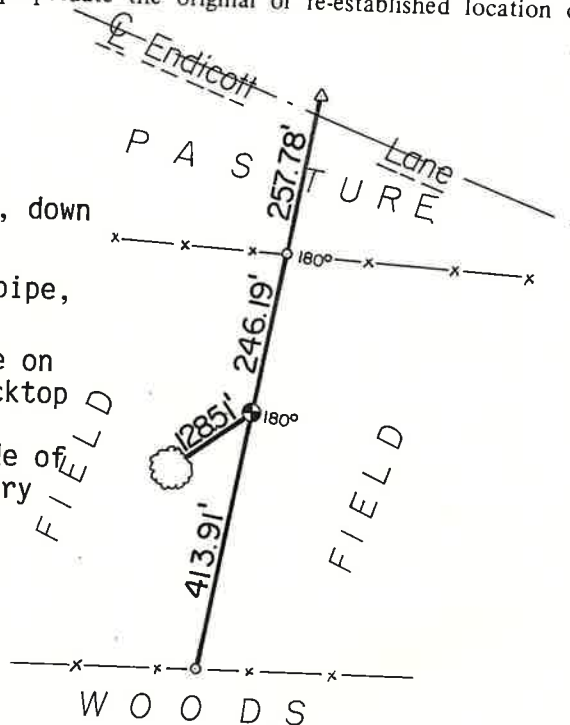

SURVEY CONTROL ORDER

Horizontal	
Vertical	

WISCONSIN COORDINATE SYSTEM

Corner	East (X)	North (Y)	Elevation (Z)	Zone
Control Sta. Name				

~~City/Village of~~ Town of Glendale

County of Monroe