

U. S. Public Land Corner Maintenance

62

Corner: S1/4 Sec. 13, T16N-R1E

41601130020

Date	Crew	Monument type
December 1, 2023	Zachariah P. Dechant Gary L. Dechant	Found Harrison, set sign 1.5' north, falls in north-south fence, logged area/clear cut

References:

- 1) Set 5/8" x 24" round rebar
- 2) Set 5/8" x 24" round rebar, 9' east of fence
- 3) Set 5/8" x 5' round rebar
- 4) Set 5/8" x 5' round rebar

Bearing	Distance
N65E	34.08'
S14E	23.15'
S56W	16.65'
N38W	13.81'

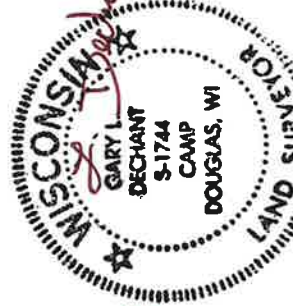

Gary L. Dechant

December 1, 2023

Compass bearings

CERTIFICATE

CERTIFIED LAND CORNER

41601130020

No. 62

I, Gary L. Dechant, do hereby certify that on the 4th day of October 19 95, I found (evidence) ~~(no evidence)~~ of the S/4 corner of Section 13, T 16 N, R 1 E Fourth Principal Meridian, and I re-established said corner according to the Wisconsin Statutes as shown and described hereon.

Dated this 21st day of Oct. 19 95.

Gary L. Dechant

R.L.S. 1744
Title

History of corner establishment since Original Government Survey

No known recorded history since the original government survey.
Have reason to believe James Carroll was here at some earlier date.

Description of corner evidence found:

Found an unrecorded stone (+) at occupied fence corner.
Accepted stone as it fit other section corners well.

See Reverse Side
For Maintenance

Description of corner and witness monuments, references and accessories used to perpetuate the original or re-established location of this corner.

Witnesses to corner location:

David E. Madison

Gary L. Dechant

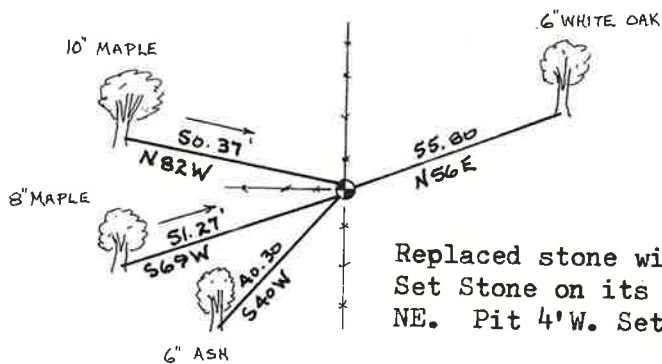

Replaced stone with TCP monument.
Set Stone on its side with (+) facing NE. Pit 4'W. Set sign 1' S.

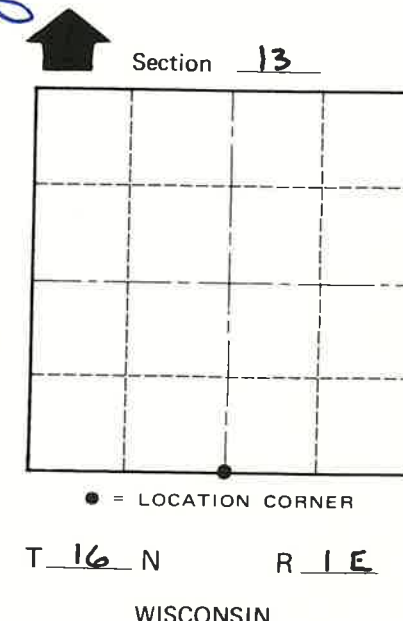
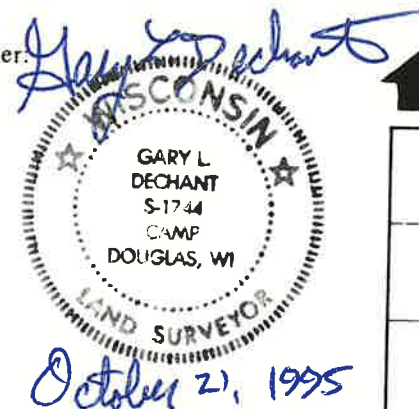

COUNTY SURVEYOR FORM NO. 1

SURVEY CONTROL ORDER

Horizontal	_____
Vertical	_____

WISCONSIN COORDINATE SYSTEM

Corner	East (X)	North (Y)	Elevation (Z)	Zone
Control Sta. Name				

(Trees double blazed with 20d nail set)

City, Village or Town CLIFTON

County of MONROE