

# U. S. Public Land Corner Maintenance

# 39

Corner: W1/4 Sec. 12, T16N-R1E

41601112000

<u>Date</u>	<u>Crew</u>	<u>Monument type</u>
December 4, 2023	Zachariah P. Dechant Gary L. Dechant	Found Harrison at fence corner, set sign 1' north

References:

- 1) Set 2' section of steel fence post, 4' NW of 3" Shagbark Hickory
- 2) Set 2' section of steel fence post, 4' north of 6" Maple, 7' west of fence
- 3) Set 2' section of steel fence post, 4' NE of 12" Maple
- 4) Set 2' section of steel fence post, 6' SE of 16" Hickory (1993 BT)

<u>Bearing</u>	<u>Distance</u>
S37E	28.05'
S13W	16.61'
S47W	34.30'
N20W	20.52'

Compass bearings  
Trees double blazed



CERTIFICATE

CERTIFIED LAND CORNER

4160112000

No. 39

I, Gary L. Dechant, do hereby certify that on the 7th day of May 19 93, I found (evidence) (no evidence) of the W/4 corner of Section 12, T16 N, R 1 E Fourth Principal Meridian, and I re-established said corner according to the Wisconsin Statutes as shown and described hereon.

Dated this 10th day of May 19 93.

Gary L. Dechant

R.L.S. 1744 Title

History of corner establishment since Original Government Survey

Fred Holden was probably here in his survey of 1906.

Description of corner evidence found:

Accepted fence corner as best available evidence, fits overall section datum very well. The NW corner of the SW/4-NW/4 falls 2' south and 5' west of occupied fence corner.

See Reverse Side For Maintenance

COUNTY SURVEYOR FORM NO. 1

Description of corner and witness monuments, references and accessories used to perpetuate the original or re-established location of this corner:

Witnesses to corner location:

David E. Madison

Gary L. Dechant

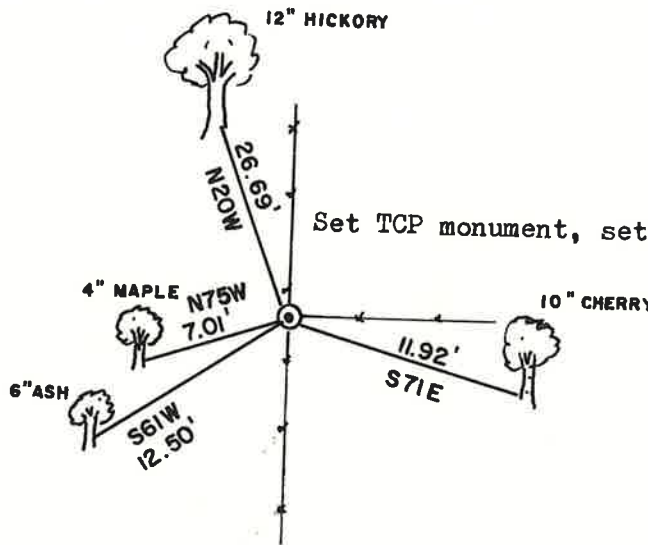

(Trees double blazed with 20d nail set)

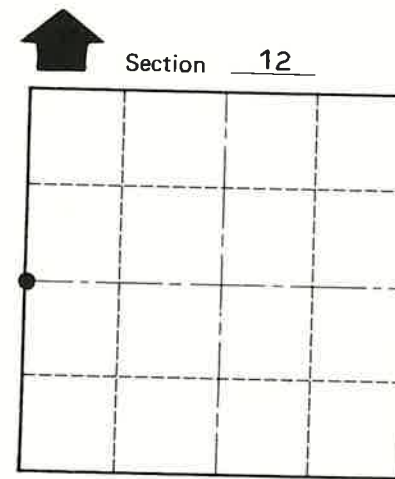

O = LOCATION CORNER

T 16 N R 1 E

WISCONSIN

SURVEY CONTROL ORDER

Horizontal \_\_\_\_\_  
Vertical \_\_\_\_\_

WISCONSIN COORDINATE SYSTEM

Corner	East (X)	North (Y)	Elevation (Z)	Zone
Control Sta. Name				

City, Village or Town Clifton

County of Monroe